



BROAD STREET, PENRYN
GUIDE PRICE £145,000





FULL DESCRIPTION A two bedroom ground floor flat that needs refurbishment. HUGE potential for profit or great first home. Set within a grade 2 listed building with exciting period features..

This property has a shared entrance and PRIVATE garden, and consists of a large living room, two spacious bedrooms, a kitchen and bathroom. This property is great for investors and is offered with NO CHAIN.

Located in the heart of Penryn town with local amenities right on your doorstep. From shops to cafe's, and the university up the road, this is the perfect location if you are looking for town centre living! There are also excellent transport links close by including a bus station and a train station.

OTHER INFORMATION Lease Length - 999 years
Management Charges - monthly service charges from April 24 will be £92.16 pcm.
Ground Rent - N/A



OTHER INFORMATION Whilst every care has been taken to prepare these sales particulars, they are for guidance purposes only. All measurements are approximate and are for general guidance purposes only and whilst every care has been taken to ensure their accuracy, they should not be relied upon and potential buyers are advised to recheck the measurements. These particulars do not constitute part or all of an offer or contract and Smart Estate agent has not verified the legal title of the property and the buyers must obtain verification from their solicitor. We have not tested any fixtures, fittings, equipment and it is the buyers interests to check the functionality of any appliances.

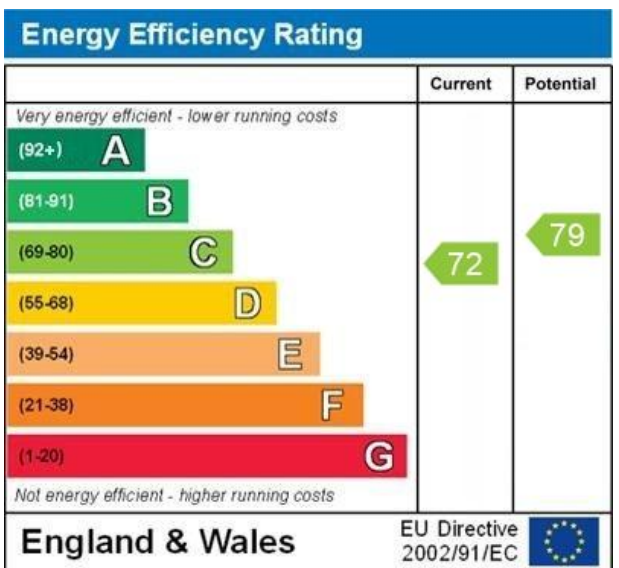

WWW.EPC4U.COM



Approx Gross Internal Area
72 sq m / 772 sq ft

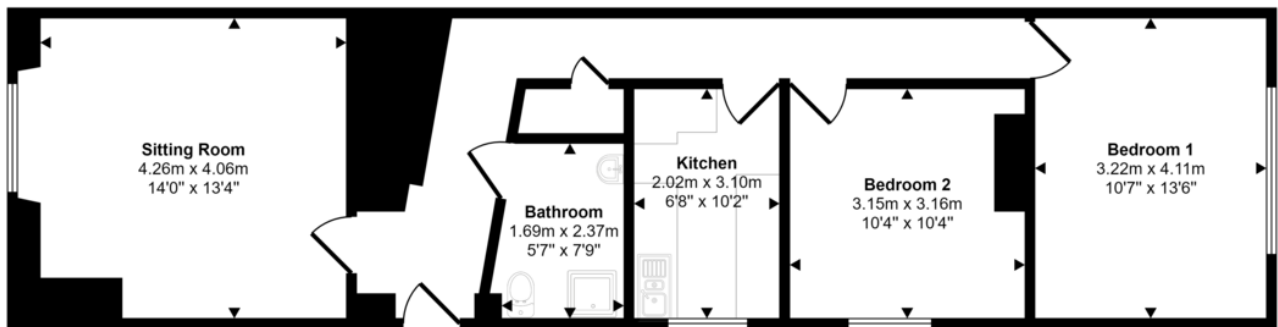

Floorplan

This floorplan is only for illustrative purposes and is not to scale. Measurements of rooms, doors, windows, and any items are approximate and no responsibility is taken for any error, omission or mis-statement. Icons of items such as bathroom suites are representations only and may not look like the real items. Made with Made Snappy 360.