

CHUTE STREET, EXETER, EX1 2BX

ASKING PRICE OF £260,000



Chute Street, Exeter

- ❖ Walking distance To Exeter City Centre
- ❖ Ideal First Time Buy Or Investment
- ❖ Popular Newtown Area
- ❖ Spacious Kitchen + Utility Space
- ❖ Two Bedrooms PLUS Study Room
- ❖ Pleasant Rear Garden Space
- ❖ Council tax band :B
- ❖ Residential Parking

This characterful two bedroom PLUS Study room mid terraced home is conveniently located in the popular Newtown area, within close proximity to the City Centre, University and RD&E Hospital.

The ground floor offers separate living room and an open plan kitchen/dining space. At the rear of the property is the family bathroom with a door leading into a private enclosed garden. Second access door leading to street.

Upstairs boasts Two double bedrooms and a separate study / childrens room. Also comes with a convenient lost space.

Council Tax Band: B

Tenure: Freehold



ENTRANCE HALL Front door with double glazed window, opening out to the entrance hall, stairs leading to first floor, doors to:

LIVING ROOM Double glazed window to the front, radiator, spot lights.

KITCHEN/DINER Base cupboards and drawers with worktop over, sink and drainer with mixer tap, built in washing machine, built in dishwasher, built in oven and hob. Utility space downstairs. Double glazed window to the front and the side.

SECOND HALLWAY Door leading to street, rear garden space and family bathroom.

FAMILY BATHROOM Close coupled WC, wash hand basin, panelled bath, heated towel rail, double glazed window to the rear.

BEDROOM ONE Double glazed window to the front, radiator.

BEDROOM TWO L shaped room, double glazed window to the front, radiator, loft access. Access to study / office room.

OFFICE / STUDY Double glazed window to the front, radiator, loft access.

REAR GARDEN To the rear is a decked patio area.







 SMART

Approx Gross Internal Area
61 sq m / 659 sq ft

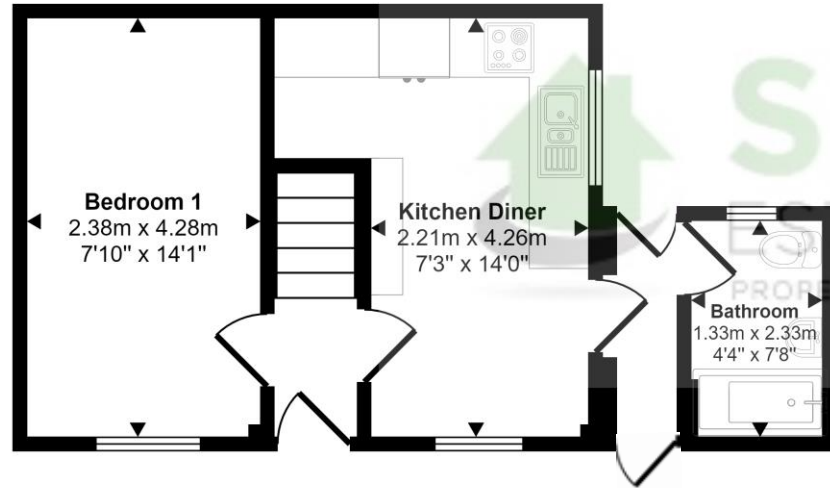

Ground Floor
Approx 30 sq m / 325 sq ft

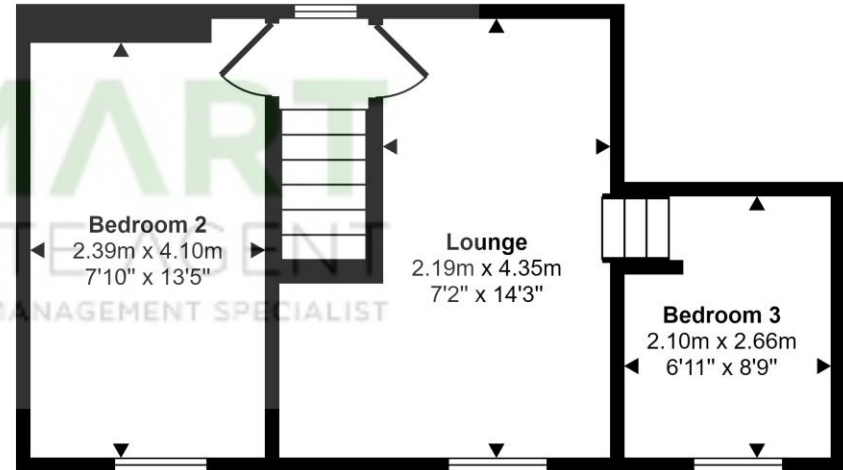

First Floor
Approx 31 sq m / 334 sq ft

This floorplan is only for illustrative purposes and is not to scale. Measurements of rooms, doors, windows, and any items are approximate and no responsibility is taken for any error, omission or mis-statement. Icons of items such as bathroom suites are representations only and may not look like the real items. Made with Made Snappy 360.

