



Sandford Walk, Exeter

This characterful two bedroom Semi Detached house is conveniently located in the popular Newtown area, within close proximity to the City Centre, University and RD&E Hospital.

The ground floor offers a spacious open plan kitchen / dining space, with a feature wood burner, dual aspect windows front and back and ample storage space.

There is a modern fitted kitchen with integral dishwasher, fridge & freezer, oven, 5 ring hob with extractor fan; which also gives a pleasant outlook to the rear & communal garden.

There is also a modern bathroom with a white 3 piece suit, which includes a bath with shower over.

Upstairs boasts Two large double bedrooms with large sash double glazed windows. Bedroom one has wooden flooring throughout and bedroom two has integral storage.

A great feature is the low maintenance garden, which is well enclosed and attracts plenty of sunshine. The garden also leads out to the communal garden.

Perfect for first time buyers or those seeking a well located property for the rental market lying within easy walking distance of the City Centre.





Approx Gross Internal Area
63 sq m / 674 sq ft

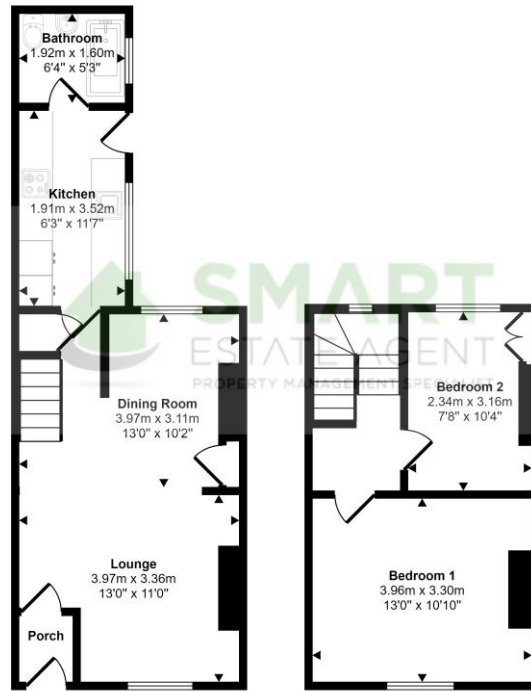

This floorplan is only for illustrative purposes and is not to scale. Measurements of rooms, doors, windows, and any items are approximate and no responsibility is taken for any error, omission or mis-statement. Icons of items such as bathroom suites are representations only and may not look like the real items. Made with Made Snappy 360.

