

Buy your next home with Next Home

Leading Perthshire Estate Agency

Croftbeag, Croftinloan, Pitlochry, PH16 5TA

Offers Over £180,000

NEXTHOME
ESTATE & LETTING AGENTS

Buying with Next Home

Croftbeag, Croftinloan, Pitlochry, PH16 5TA

Many thanks for your interest with Croftbeag, Croftinloan, Pitlochry, PH16 5TA.

Next Home Estate Agents dedicate themselves to be available when you are, offering an unbeatable service 7 days a week until 9pm.

We have the largest sales team in Perthshire, operating from our 5 offices throughout Perthshire and delivering more sales than any other estate agent.

Not only are we Perthshire's Number 1 choice but we are also local. One of the reasons we know the local markets so well is because we live here. So let us guide you through the selling and buying process.

If you're a first time buyer we have incentives to help get you onto the property ladder - our consultants can advise you through the whole process.

We offer free, no obligation mortgage advice to all our buyers.

If you have a property to sell, contact us to arrange a valuation. We are reknown in getting our customers moving quicker and at a higher price than our competitors. Put us to the test and get your free valuation today, call 01738 444342.

If you would like to be kept informed of other great properties like this one please register on our hot buyers list, where we will email you of new property listings and property open days.

Next Home your number 1 choice for property sales



FREE Valuations



We're open 7 days a week until 9pm



Registered Buyers



No obligation mortgage advice



Conveyancing Quotations



First Time Buyer with No Deposit



Next Home's Buying Guide



Next Home Open Days

About the Area

Located just outside the popular town of Pitlochry and set in the heart of the beautiful Perthshire countryside which is served by a wide range of local facilities and amenities including shopping, banking, professional offices, doctor's surgery and a community hospital.

The town remains a popular holiday destination and attractions include the fish ladder, Pitlochry festival theatre and the nearby Blair castle. The town is bypassed by the A9 trunk route providing easy access to the North and South.





NEXTHOME

ESTATE & LETTING AGENTS

Get to know about our newly listed properties 1st by
signing up to our Hot Buyers lists!

Visit www.nexthomeonline.com/buying

Property Summary

Next Home are delighted to bring this rare to the market 3 bedroom detached bungalow situated in the most picturesque area of Croftinloan, Pitlochry.

The property would be make an ideal holiday home or a development opportunity. With the plot benefitting from envious panoramic countryside views this bungalow is in a prime location and comprising: vestibule, entrance hall, spacious lounge with a large front facing window, kitchen/dining room, 3 double bedrooms with built in storage, bathroom and a shower room.

The property sits on a approximately 1/4 of an acre and offers privacy throughout with mature shrubbery to the borders.

There is parking for multiple cars and a timber garage with workshop.



Key property features

- ✓ 3 double bedrooms
- ✓ Great holiday home
- ✓ Fantastic countryside views
- ✓ Very private
- ✓ Chain free
- ✓ Rare to the market
- ✓ Ideal development opportunity
- ✓ Good sized plot
- ✓ Private location
- ✓ Oil fired heating





DSC_0455

Next Home - Croftbeag, Croftinloan, Pitlochry, PH16 5TA



DSC_0457



DSC_0459



DSC_0461



DSC_0445







Next Home - Croftbeag, Croftinloan, Pitlochry, PH16 5TA

Have a property to sell?

An expert from our local branch will provide you with the most accurate valuation.



NEXTHOME

ESTATE & LETTING AGENTS

Floorplans

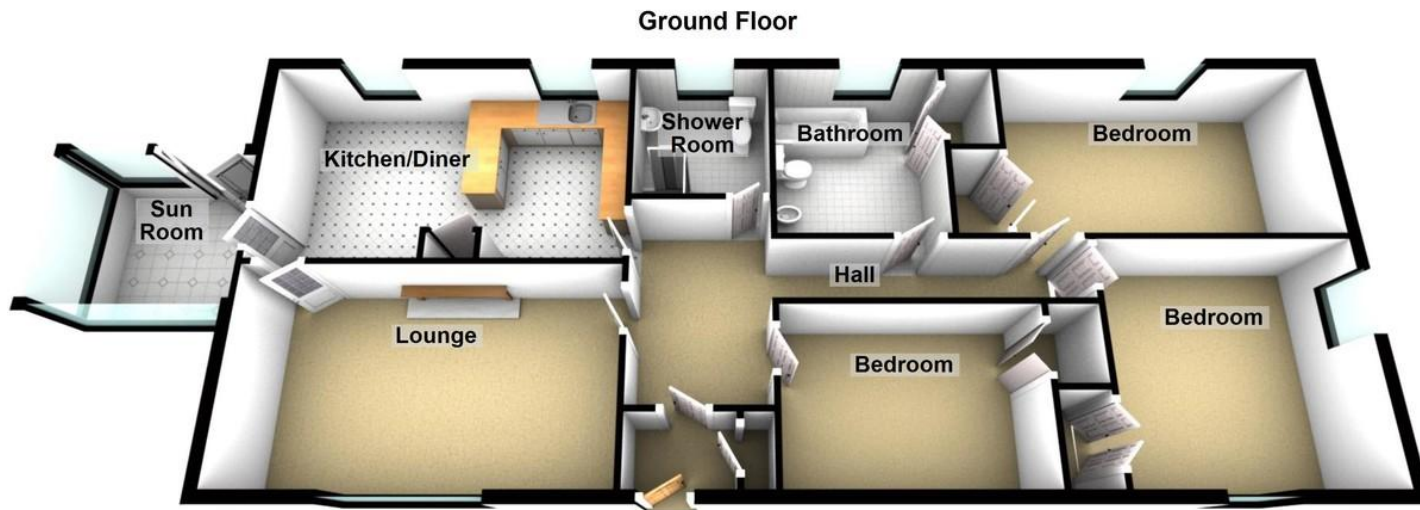

Property Room sizes

VESTIBULE

HALL

18' 2" x 11' 2" (5.54m x 3.4m)

LOUNGE

17' 9" x 11' 8" (5.41m x 3.56m)

KITCHEN/DINER

17' 9" x 11' 8" (5.41m x 3.56m)

SUN ROOM

10' 1" x 8' 2" (3.07m x 2.49m)

BEDROOM

13' 7" x 10' 4" (4.14m x 3.15m)

BEDROOM

13' 9" x 10' (4.19m x 3.05m)

BEDROOM

12' 2" x 10' (3.71m x 3.05m)

SHOWER ROOM

9' 5" x 5' 7" (2.87m x 1.7m)

BATHROOM

10' 5" x 7' 7" (3.18m x 2.31m)



NEXTHOME
ESTATE & LETTING AGENTS

TO ARRANGE A VIEWING OF THIS PROPERTY PLEASE TELEPHONE YOUR LOCAL BRANCH BELOW:

63 – 65 George Street, Perth 01738 44 43 42

41 - 43 Allan Street, Blairgowrie..... 01250 39 80 02

47a Atholl Road, Pitlochry..... 01796 54 80 14

1a James Square, Crieff.....01764 65 00 44

211 High Street, Auchterarder.....01764 66 36 66

Email sales@nexthomeonline.co.uk

For more information about Next Home and our services please visit www.nexthomeonline.co.uk

The only Perthshire estate agent available 7 days until 9pm

PLEASE NOTE: These particulars whilst believed to be accurate are set out as a general outline only for guidance and do not constitute any part of an offer or contract intending, purchasers should not rely on them as statements or representations of fact, but must satisfy themselves by inspection or otherwise as to their accuracy. No person in this firm's employment has the authority to make or give representation or warranty in respect of the property. All room sizes are approximate and for general guidance only. They cannot be relied upon for fitting carpets, furniture etc.

Registered Office Argyll House, Quarrywood Court, Livingston, West Lothian EH54 6AX. Registered in Scotland No. SC264812. NEXTHOME (Scotland) Ltd is an appointed representative of Kinggate Law Limited, which is authorised and regulated by the Financial Conduct Authority for advising on and arranging mortgages and insurance, broking and debt counselling of consumer credit agreements.



Next Home are proud to be members of the Property Ombudsman Scheme