



**Peerage Court,**  
Minehead, TA24 5DA  
£130,000 Leasehold

			<b>D</b>
2	1	1	EPC

**Wilkie May  
& Tuckwood**

# Floor Plan

Third Floor

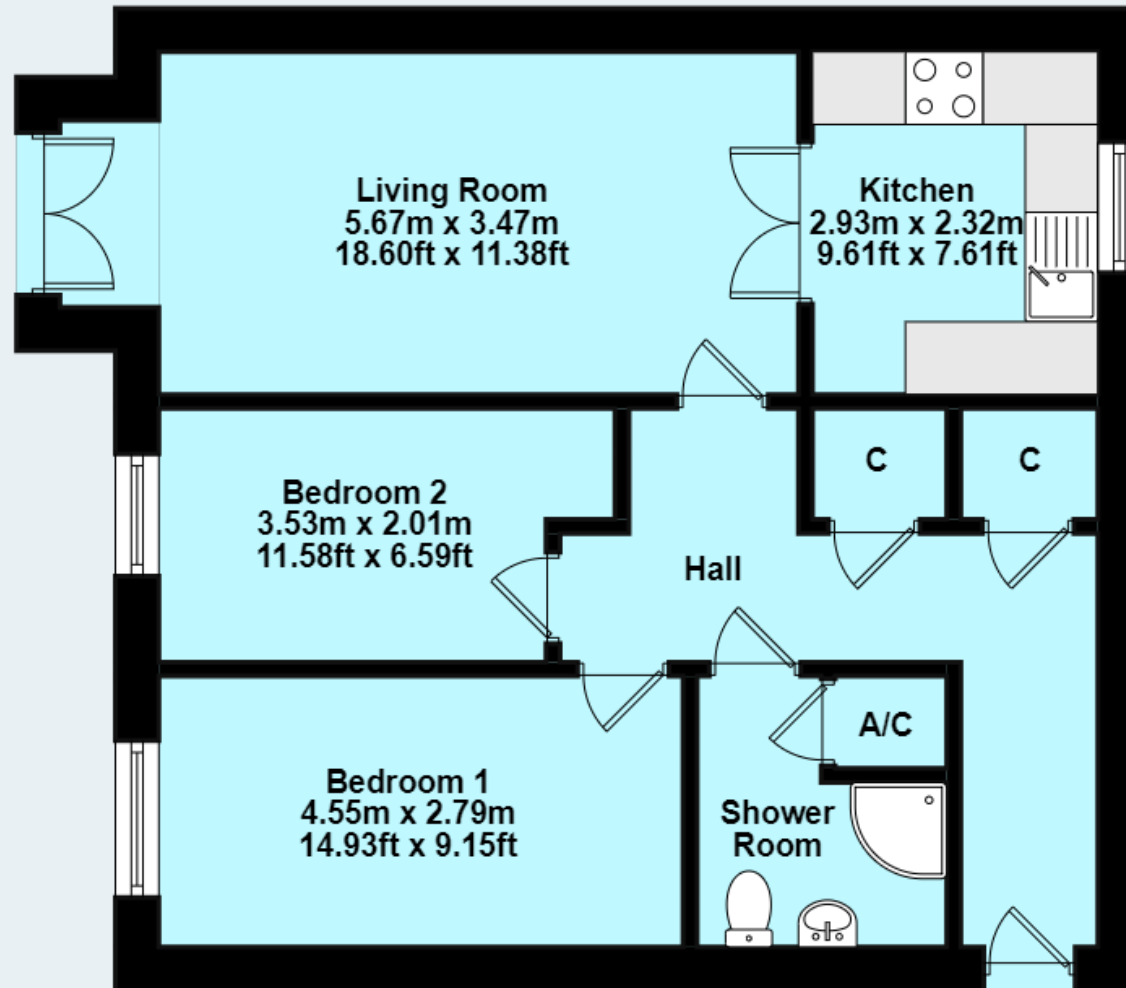

**TOTAL FLOOR AREA:**  
61.04sqm (657.03sqft) Approx.

# Description

A two bedroom third floor Retirement Apartment situated within a purpose-built development designed specifically for people over the age of 60. Being a penthouse Apartment, this property is larger than most with a wider hallway and extra storage cupboards. The property also boasts modern amenities such as an emergency call system and intercom entry, includes the services of an in-house manager. There is also a Hyco instant hot water system in the airing cupboard serving the kitchen and shower room.

The development features a communal lounge and level gardens where residents can relax, The car parking area adds to the convenience of living in this development, with plenty of additional space for visitors.

Located within half a mile of the town centre and seafront, the apartment is perfectly situated for easy access to local amenities.

- NO ONWARD CHAIN
- 2 bedrooms
- Lift access
- Juliet Balcony
- Separate Kitchen with window



Wilkie May & Tuckwood are pleased to be able to offer this two bedroom third floor retirement apartment. The accommodation comprises in brief: entrance through front door into a spacious hallway with two large storage cupboards.

The large living room has south facing French doors opening to a Juliet balcony affording lovely views of the surrounding countryside and a feature fireplace with electric fire. Double doors open to the kitchen which is fitted with a range of wall and base units, one and half bowl sink and drainer incorporated into work surface with tiled surrounds, electric kick board electric heating, integrated Zanussi electric hob and oven with extractor hood over, space for fridge freezer, space and plumbing for washing machine and window affording views over the

“secret garden” towards North Hill.

Both bedrooms have lovely views towards Dunster and the master bedroom has a built-in wardrobe. There is also a fitted shower room with airing cupboard.

**AGENTS NOTE:** The Apartment is leasehold and is held under the terms of a Lease with 92 years remaining. There is a service charge payable currently £282.00 per month together with a ground rent currently £291.00 per annum.



#### GENERAL REMARKS AND STIPULATION

**Tenure:** The property is offered for sale leasehold by private treaty with vacant possession on completion.

**Services:** Mains water, mains electricity, mains drainage, electric storage heating.

**Local Authority:** Somerset Council, Deane House, Belvedere Road, Taunton TA1 1HE

**Property Location:** [w3w.co/released.comedy.royally](http://w3w.co/released.comedy.royally) **Council Tax Band:** C

**Broadband and mobile coverage:** We understand that there is good mobile coverage. The maximum available broadband speeds are 80 Mbps download and 20 Mbps upload. We recommend you check coverage on <https://checker.ofcom.org.uk/>. **Flood Risk Surface Water:** Area round high risk **Rivers and the Sea:** Very low risk **Reservoirs:** Unlikely **Groundwater:** Unlikely. We recommend you check the risks on <http://www.gov.uk/check-long-term-flood-risk> **Planning:** Local planning information is available on <http://www.somersetwestandtaunton.gov.uk/asp/webpages/plan/plapplookup.asp>

IMPORTANT NOTICE Wilkie May & Tuckwood for themselves and for the vendors of the property, whose agents they are, give notice that: 1. the particulars are intended to give a fair and substantially correct overall description for the guidance of intending purchaser and do not constitute part of an offer or contract. Prospective purchasers and lessees ought to seek their own professional advice.

2. All descriptions, dimensions, areas, reference to condition and necessary permissions for use and occupation and other details are given in good faith, and are believed to be correct, but any intending purchasers should not rely on them as statements or representations of fact, but must satisfy themselves by inspection or otherwise as to the correctness of each of them. 3. No person in the employment of Wilkie May & Tuckwood has any authority to make or give any representations or warranty

whatever in relation to this property on behalf of Wilkie May & Tuckwood, nor enter into any contract on behalf of the vendor. 4. No responsibility can be accepted for any expenses incurred by intending purchasers in inspecting properties which have been sold, let or withdrawn. Photographs taken and details prepared April 2024. MEASUREMENTS AND OTHER INFORMATION All measurements are approximate. While we endeavour to make our sales particular accurate and reliable, if there is any point which is of particular importance to you, please contact the office and we will be pleased to check the information with you.

Code of Practice for Residential Estate Agents: Effective from 1 August 2011:

'8. Financial Evaluation 8a At the time that an offer has been made and is being considered by the seller, you must take reasonable steps to find out from the prospective buyer the source and availability of his funds for buying the property and pass this information to the seller. Such information will include whether the prospective buyer needs to sell a property, requires a mortgage, claims to be a cash buyer or any combination of these. Such relevant information that is available should be included in the Memorandum of Sale having regard to the provisions of the Data Protection Act.8b These reasonable steps must continue after acceptance of the offer until exchange of contracts (in Scotland, conclusion of missives) and must include regular monitoring of the prospective buyer's progress in achieving the funds required, and reporting such progress to the seller.

The agent has not tested any apparatus, equipment, fixtures and fittings or services and so cannot verify that they are in working order or fit for their purpose. A Buyer is advised to obtain verification from their solicitor or surveyor. References to the Tenure of the Property are based on information supplied by the Seller. The agent has not had sight of the title documents. A Buyer is advised to obtain verification from their Solicitor.



**Tel: 01643 704400**

6 Wellington Square, Minehead, Somerset, TA24 5NH

