



- Duplex Penthouse Apartment
- Three Double Bedrooms
- Views of Holland Park
- EPC Rating - D
- Council Tax Band - G
- Ground Rent - £90 Per Annum
- Service Charge - £13,400 Per Annum – Including Heating & Hot Water
- Lease Length – 140 Years Remaining

94 Troy Court, Kensington High Street, W8 7RE

Asking Price: £1,995,000

An impressive duplex penthouse apartment with terrace and views of Holland Park. The property is situated in a prestigious apartment building adjacent to Holland Park. The accommodation comprises a grand reception room with double French doors leading out onto a triple roof terrace, kitchen, guest cloakroom, master bedroom with French doors leading to balcony, two further double bedrooms, family bathroom with separate shower and second cloakroom.

Troy Court is a popular apartment building offering excellent security and a concierge service. Located on Kensington High Street amongst its many shops, cafes and restaurants and offering easy access to the areas many transport links.



VIRTUALLY STAGED IMAGE FULHAM PERFORMANCE



VIRTUALLY STAGED IMAGE FULHAM PERFORMANCE

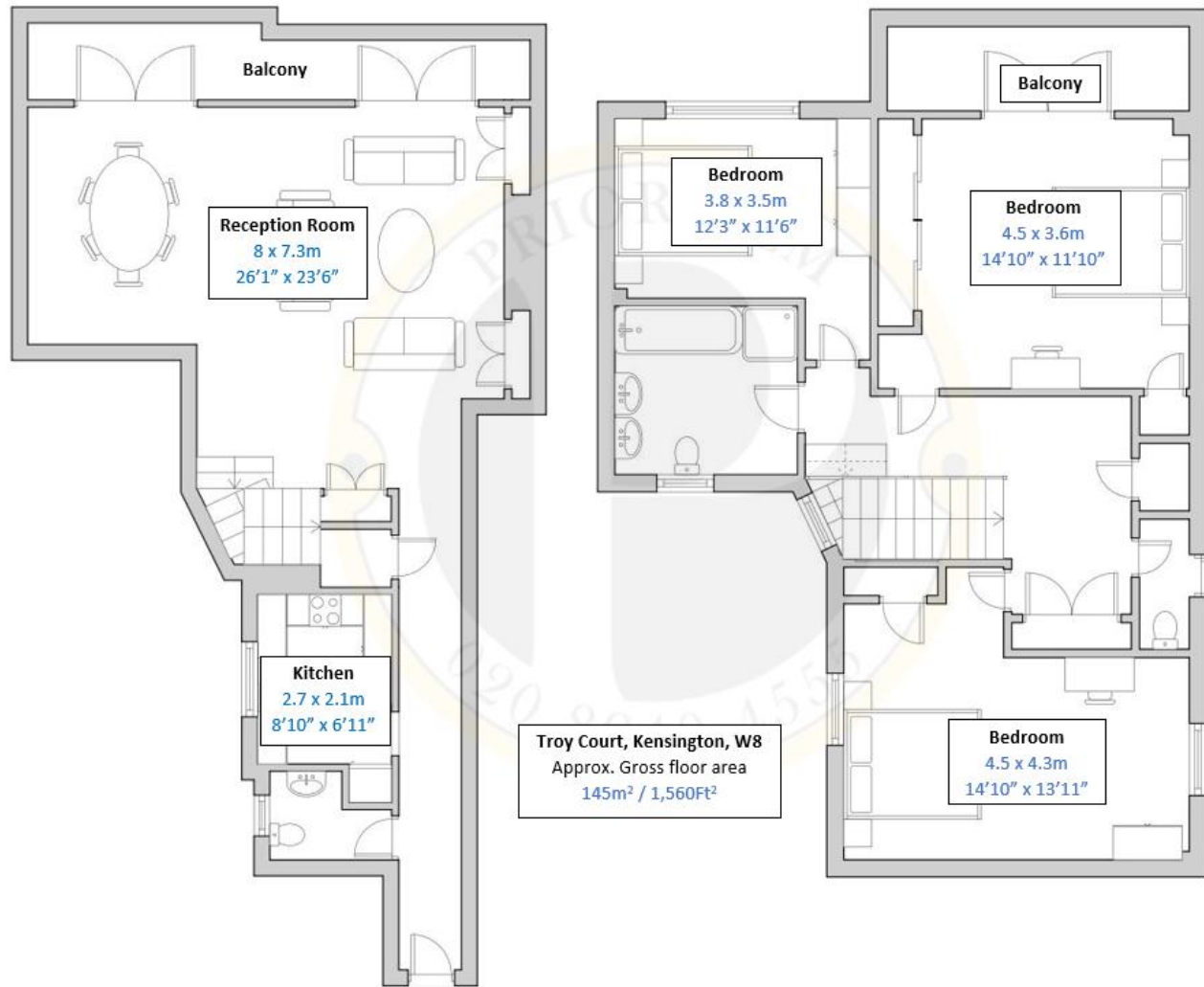

16 Kew Green
Richmond
Surrey
TW9 3BH

www.priorylm.com
020 8940 4555
sales@priorylm.com

Agents Note: Whilst every care has been taken to prepare these sales particulars, they are for guidance purposes only. All measurements are approximate and are for general guidance purposes only and whilst every care has been taken to ensure their accuracy, they should not be relied upon and potential buyers are advised to recheck the measurements