



SALES

LETTINGS

MANAGEMENT

chiswick@tatepartnership.co.uk

020 8996 0000

TATEPARTNERSHIP.CO.UK



Graham Road, W4

£1,850 pcm

\*\*\*GARDEN FLAT\*\*\* Newly Refurbished.

With refurbishment complete, be the first to occupy this delightful Garden Flat. Available now, the accommodation and gardens have been re-fashioned to comprise: front to back hallway, Living Room with bright bay window, Double Bedroom (bed optional), Newly fitted Shower Room, Newly fitted Kitchen with double doors opening onto the Newly Landscaped private back garden with side access. Ready to occupy immediately. Unfurnished (Double Bed available).

### Graham Road, W4

Approximate Gross Internal Area = 45.9 sq m / 494 sq ft

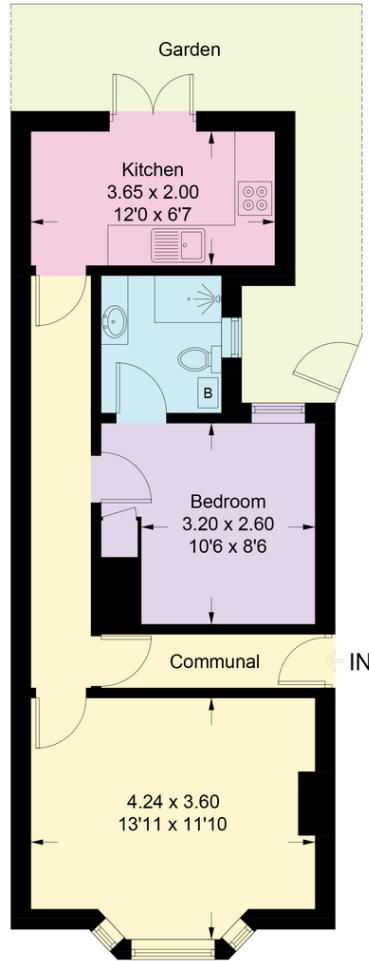

Illustration for identification purposes only, measurements are approximate, not to scale. floorplansUsketch.com © (ID1045943)

## EPC

