





3 Queen Street

Knutsford, Knutsford

A three bedroom and three bathroom period end of terrace home positioned upon a popular road within the heart of the town, moments from a wide selection of amenities, transport links, Tatton Park and The Big Heath.

Council Tax band: D

Tenure: Freehold

EPC Energy Efficiency Rating: E

EPC Environmental Impact Rating:

- Accommodation over four floors
- Extended kitchen and ground floor shower room
- Attractive period charm and character
- Superb town centre position
- Converted cellar and loft
- Over 1600 square feet of accommodation



BASEMENT
228 sq.ft. (21.2 sq.m.) approx.

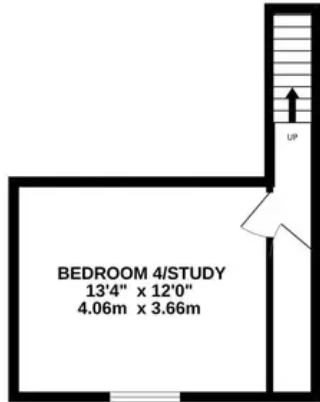

GROUND FLOOR
631 sq.ft. (58.6 sq.m.) approx.

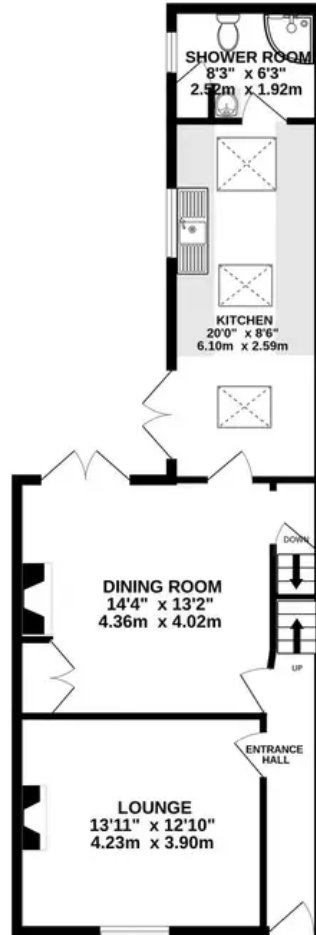

FIRST FLOOR
412 sq.ft. (38.3 sq.m.) approx.

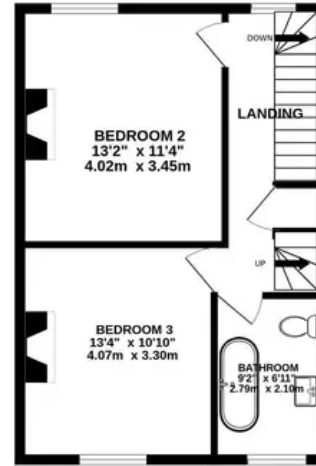

2ND FLOOR
343 sq.ft. (31.9 sq.m.) approx.

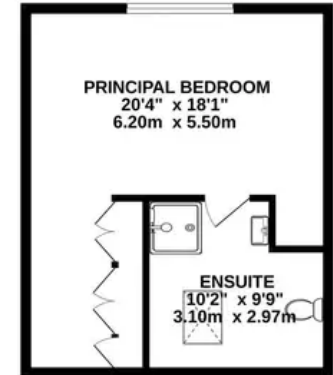

TOTAL FLOOR AREA : 1614 sq.ft. (150.0 sq.m.) approx.

Whilst every attempt has been made to ensure the accuracy of the floorplan contained here, measurements of doors, windows, rooms and any other items are approximate and no responsibility is taken for any error, omission or mis-statement. This plan is for illustrative purposes only and should be used as such by any prospective purchaser. The services, systems and appliances shown have not been tested and no guarantee as to their operability or efficiency can be given.



Stuart Rushton & Company

Stuart Rushton & Co, 35 King Street – WA16 6DW

01565 757000

enquiries@srushton.co.uk

www.srushton.co.uk



We are not authorised to make or give any representations or warranties in relation to the property either here or elsewhere. We assume no responsibility for any statement that may be made in these particulars, and they do not form part of any offer or contract and must not be relied upon as statements or representation of fact. Any areas, measurements or distances are approximate. The text, photographs and plans are for guidance only. Importantly, it should not be assumed that the property has all necessary planning, building regulations or other consents and we have not tested any services, equipment or facilities. Purchasers must satisfy themselves by inspection or otherwise.