



19 Talbot Close

Reigate

Guide Price **£475,000**



19 Talbot Close

Nestled in the sought-after location of Reigate, this three-bedroom mid-terraced family home offers the perfect opportunity to create your dream home. Boasting a modern design and well-thought-out layout, this property is ideal for families. The ground floor features a spacious lounge and dining area that flows seamlessly into a conservatory, offering a versatile living space that is perfect for hosting family gatherings or relaxing with a book. The kitchen is a good size and is complemented by a convenient downstairs cloakroom/wc, providing practicality and functionality for every-day living. Upstairs, you will find three well-appointed bedrooms and a modern family bathroom, providing the perfect sanctuary for rest and relaxation. With Reigate Station and a variety of shops just a stone's throw away, this property offers the perfect balance of urban convenience and suburban tranquillity.

Step outside and discover a delightful outdoor space that completes this charming family home. The property benefits from a private garden, providing a peaceful retreat where you can enjoy al fresco dining or simply unwind after a long day. In addition, the property comes with the added convenience of a garage en-bloc, providing secure parking or extra storage space for your belongings. Whether you are looking to soak up the sun in the garden or need a safe space for your vehicle, this property offers the perfect outdoor solution for all your needs. Don't miss this opportunity to make this beautiful property your new home and enjoy a lifestyle of comfort, convenience, and relaxation in the heart of Reigate.

Council Tax band: D

Tenure: Freehold

- Three Bedroom Mid-terrace Family Home
- Sought After Location
- Conservatory And Downstairs Cloakroom/wc
- Lounge And Dining Area





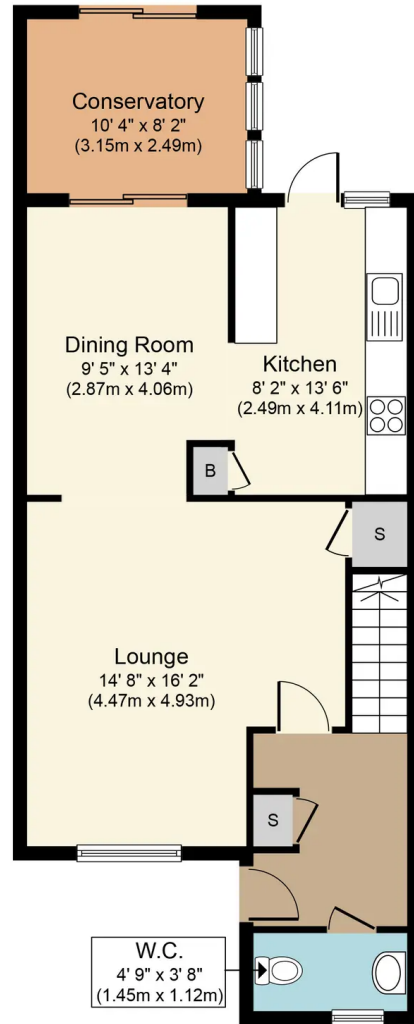

Ground Floor
Approximate Floor Area
682 sq. ft.
(63.3 sq. m.)

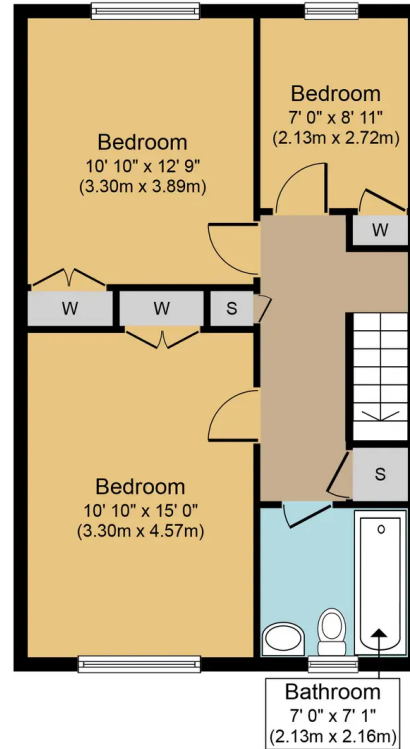

First Floor
Approximate Floor Area
535 sq. ft.
(49.7 sq. m.)



Talbot Close, RH2
Approx. Gross Internal Floor Area 1,216 sq. ft. (113.0 sq. m.)

Whilst every attempt has been made to ensure the accuracy of the floor plan contained here, measurements of doors, windows, rooms and any other items are approximate and no responsibility is taken for any error, omission, or mis-statement. The measurements should not be relied upon for valuation, transaction and/or funding purposes. This plan is for illustrative purposes only and should be used as such by any prospective purchaser or tenant. The services, systems and appliances shown have not been tested and no guarantee as to their operability or efficiency can be given.