

Pickerings Avenue

Measham, Swadlincote, DE12 7SB



Offered with no upward chain is this lovely modern village semi detached home that has the benefit of contemporary fitted kitchen, rear lounge/diner, guest's cloakroom, three bedrooms and two bathrooms (en suite to master), landscaped gardens and garage to the rear.

£250,000



John German

Measham is a village in Leicestershire and is close to the Staffordshire and Derbyshire border, located just off the A42 Junction 11 south of Ashby-de-la-Zouch. The village lies at the heart of the National Forest and close to Willesley Grounds which has a fishing lake and scout campsite. It has a busy High Street with many shops, an excellent local primary school and leisure centre.

Accommodation - An entrance door takes you into the reception hall where on your right is a useful modern guest's cloakroom and a staircase leads directly ahead to the first floor.

The modern fitted breakfast kitchen having base and wall mounted cabinets wrapping around two sides of the room with integral gas hob with extractor hood above and oven beneath alongside spaces for a dishwasher, washing machine and fridge freezer. There is also room for a breakfast table within the feature front facing bay window.

The lounge/dining room lies at the rear of the property and is a well proportioned room with a useful understairs storage cupboard and French double doors with side glazed panels offering views out and access into the landscaped rear garden.

Return to the hallway and climb the stairs to the first floor where you will find three bedrooms, the principal bedroom overlooks the rear garden and has the benefit of its own private en suite shower room with enclosed shower, WC and wash hand basin.

Serving the remaining two bedrooms is the family bathroom which is similarly fitted with a panel bath, pedestal wash hand basin, WC, ladder style radiator and complementary tiling to the walls.

Outside - To the rear is an extensive paved patio with south facing sunny landscaped gardens beyond. Gated access leads to the driveway that is set to the rear alongside a garage.

Tenure: Freehold (purchasers are advised to satisfy themselves as to the tenure via their legal representative).

Property construction: Brick

Parking: Drive to rear

Electricity supply: Mains

Water supply: Mains

Sewerage: Mains

Heating: Gas

(Purchasers are advised to satisfy themselves as to their suitability).

Broadband type: TBC

See Ofcom link for speed: <https://checker.ofcom.org.uk/>

Mobile signal/coverage: See Ofcom link <https://checker.ofcom.org.uk/>

Local Authority/Tax Band: North West Leicestershire District Council / Tax Band C

Useful Websites: www.gov.uk/government/organisations/environment-agency

Our Ref: JGA/11042024

The property information provided by John German Estate Agents Ltd is based on enquiries made of the vendor and from information available in the public domain. If there is any point on which you require further clarification, please contact the office and we will be pleased to check the information for you, particularly if contemplating travelling some distance to view the property. Please note if your enquiry is of a legal or structural nature, we advise you to seek advice from a qualified professional in their relevant field.

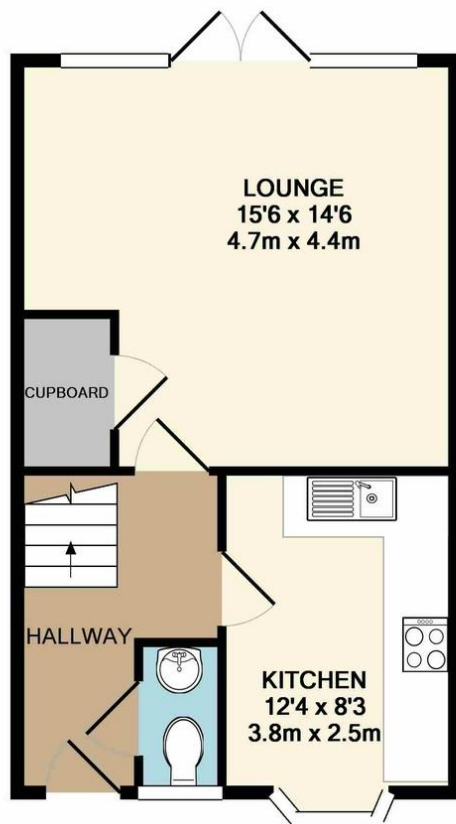

GROUND FLOOR

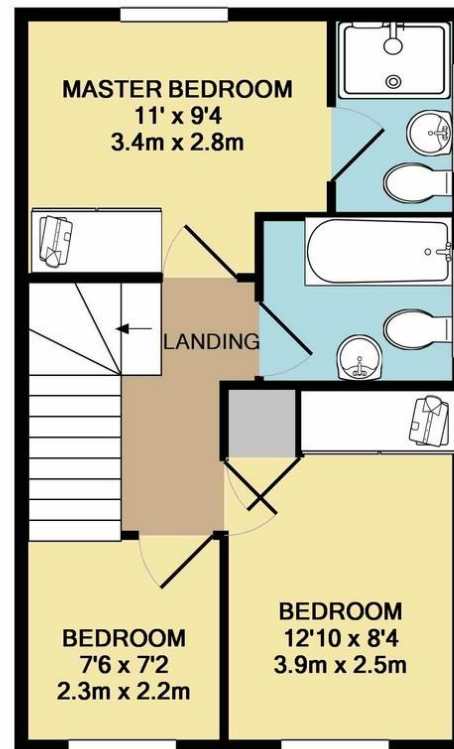

1ST FLOOR





Score	Energy rating	Current	Potential
92+	A		95 A
81-91	B	83 B	
69-80	C		
55-68	D		
39-54	E		
21-38	F		
1-20	G		



Agents' Notes

These particulars do not constitute an offer or a contract neither do they form part of an offer or contract. The vendor does not make or give and Messrs. John German nor any person employed has any authority to make or give any representation or warranty, written or oral, in relation to this property. Whilst we endeavour to make our sales details accurate and reliable, if there is any point which is of particular importance to you, please contact the office and we will be pleased to check the information for you, particularly if contemplating travelling some distance to view the property. None of the services or appliances to the property have been tested and any prospective purchasers should satisfy themselves as to their adequacy prior to committing themselves to purchase.

Referral Fees

Mortgage Services - We routinely refer all clients to APR Money Limited. It is your decision whether you choose to deal with APR Money Limited. In making that decision, you should know that we receive on average £60 per referral from APR Money Limited.

Conveyancing Services - If we refer clients to recommended conveyancers, it is your decision whether you choose to deal with this conveyancer. In making that decision, you should know that we receive on average £150 per referral.

Survey Services - If we refer clients to recommended surveyors, it is your decision whether you choose to deal with this surveyor. In making that decision, you should know that we receive up to £90 per referral.

John German

63a Market Street, Ashby-De-La-Zouch, Leicestershire,
LE65 1AH

01530 412824

ashbysales@johngerman.co.uk

Ashbourne | Ashby de la Zouch | Barton under Needwood
Burton upon Trent | Derby | East Leake | Lichfield
Loughborough | Stafford | Uttoxeter

JohnGerman.co.uk Sales and Lettings Agent