



20 Burnham Road, Burton

Christchurch

Guide Price **£400,000**

20 Burnham Road

Burton, Christchurch

An exceptional 3-bedroom semi-detached house, offered as freehold in a highly sought-after location in Burton. Boasting over 1100 square feet of contemporary living space, this property has been meticulously refurbished to a high standard, featuring a stunning open plan living area that is the real hub of the home. The property further benefits from three bedrooms, two of which are doubles, family bathroom, a garage and off-road parking for a couple of cars. Be sure to check out the virtual tour to truly appreciate the beauty and functionality of this home.

Step outside and discover the impressive outdoor space that complements this delightful home. The property offers a spacious and well-maintained garden area, providing the perfect setting for outdoor entertainment, and leisure activities also backing on to a park. With the ideal combination of indoor sophistication and outdoor charm, this property truly offers a lifestyle of comfort and luxury for its lucky new owners.

Council Tax band: C

Tenure: Freehold

EPC Energy Efficiency Rating: D

EPC Environmental Impact Rating: D



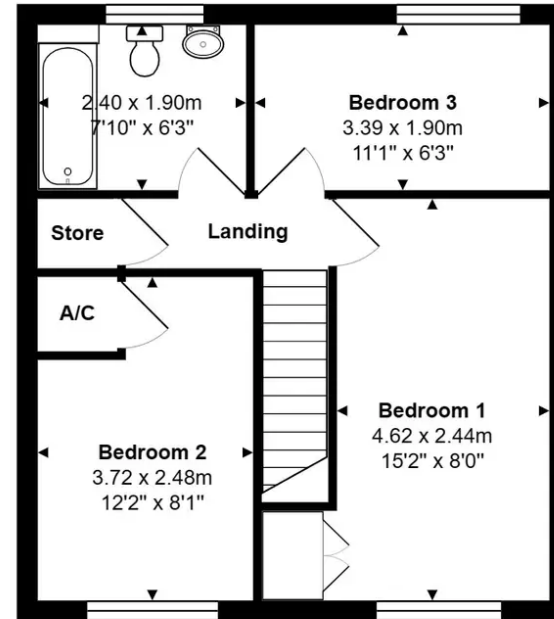
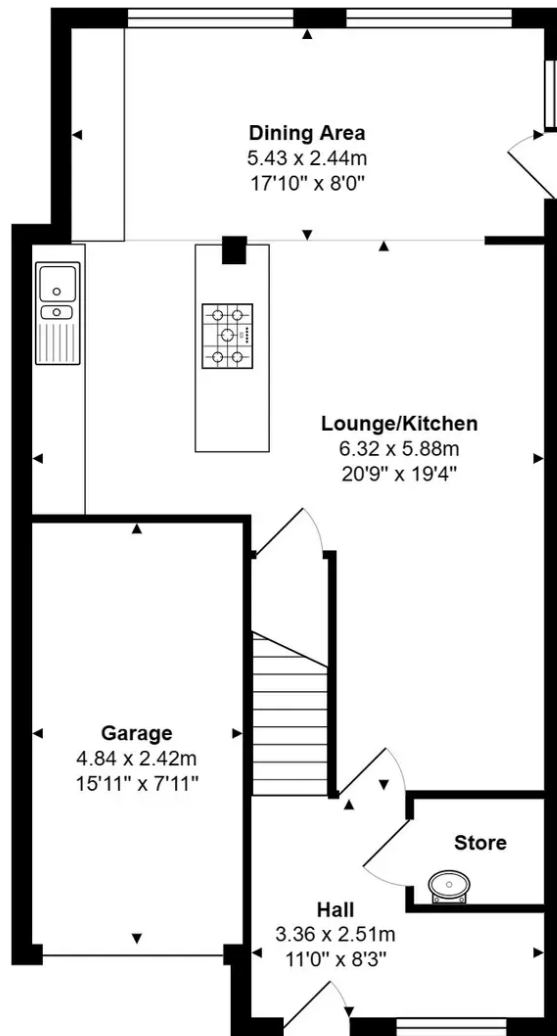

Total Area: 102.6 m² ... 1104 ft²

All measurements are approximate and for display purposes only



20 Burnham Road

Burton, Christchurch

- Jordan Marks Estates At Your Service 7 Days a Week 24 Hours a Day
- Freehold
- Stunning open plan living area
- Garage and off road parking
- Over 1100sq ft of accomodation
- Check out the virtual tour
- Refurbished to a high standard

Situated in a quiet residential area in the semi-rural location of Burton close to the historic market town of Christchurch with its many amenities, mainline railway station and good road links to Bournemouth and Southampton. Local Authority and School Catchments BCP Council ~ Council Tax Band C ~ Burton C of E Primary School.





Jordan Marks estates

Jordan Marks Estates, 16 High Street - BH23 1AY

01202 484444 • george@jordanmarksestates.co.uk • <http://jordanmarksestates.co.uk>