

Littleworth Road

Cannock, WS12 1JA



A well presented end of terraced character home offered to the market with no onward chain having off road parking to the rear.

£185,000



John German

Offered to the market with no upward chain, this well presented and recently modernised three bedroom end of terraced property is situated in popular location being close to all local amenities. For local schooling this property falls into the catchment area for Hazel Slade Primary Academy and for secondary education, the house falls within the catchment area of Kingsmead Academy. For those who enjoy outdoor exercise, there is Hednesford Hills Local Nature Reserve situated just behind the property and Cannock Chase is just a short drive away.

Internally, the property comprises of entrance door opening into the welcoming dining room having laminate flooring, a feature fireplace and a uPVC double glazed window to the front. There is a small inner hall with a useful storage cupboard and access into the lounge which has uPVC double glazed windows to the rear and side aspect, electric feature fire and a door leading to stairs. Next is the recently re-fitted kitchen having a stylish range of white gloss wall and base units with laminate worksurfaces over, integrated electric fan oven and extractor hood. There is space for a freestanding fridge freezer, a UPVC double glazed window to the side aspect, a door to the rear garden and access into the guest cloakroom/utility room.

From the lounge there is a door to the stairs which lead to the first floor. The master bedroom has two uPVC glazed windows to the front aspect, carpeted flooring and a storage cupboard which is currently being used as a wardrobe. There are a further two bedrooms both of which are singles offering potential as a nursery or dressing room. The bathroom is fitted with a white suite including a bath with mains shower over.

Externally, there is a tidy and well-maintained rear courtyard with outdoor storage. A gate provides access to a further area ideal for off-road parking.

Tenure: Freehold (purchasers are advised to satisfy themselves as to the tenure via their legal representative).

Property construction: Traditional

Parking: Parking at area

Electricity supply: Mains

Water supply: Mains

Sewerage: Mains

Heating: Gas

(Purchasers are advised to satisfy themselves as to their suitability).

Broadband type: TBC

See Ofcom link for speed: <https://checker.ofcom.org.uk/>

Mobile signal/coverage: See Ofcom link <https://checker.ofcom.org.uk/>

Local Authority/Tax Band: Cannock Chase District Council / Tax Band A

Useful Websites: www.gov.uk/government/organisations/environment-agency

Our Ref: JGA/11042024

The property information provided by John German Estate Agents Ltd is based on enquiries made of the vendor and from information available in the public domain. If there is any point on which you require further clarification, please contact the office and we will be pleased to check the information for you, particularly if contemplating travelling some distance to view the property. Please note if your enquiry is of a legal or structural nature, we advise you to seek advice from a qualified professional in their relevant field.

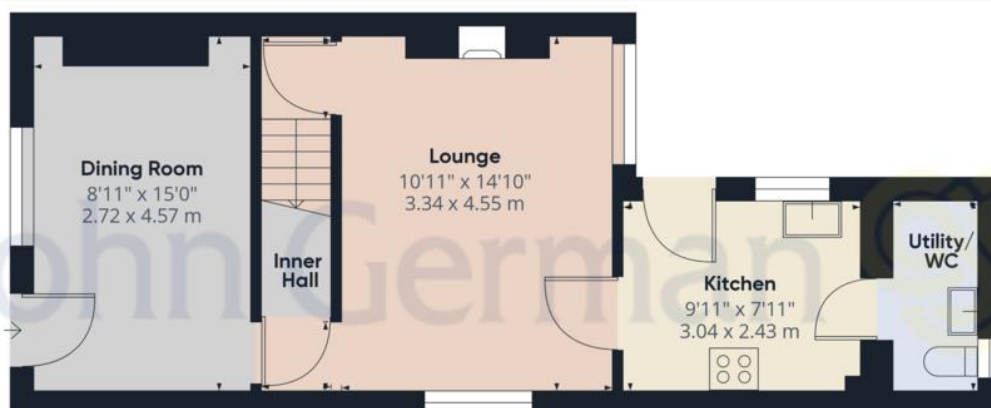

Ground Floor



Floor 1

John German 

Approximate total area[®]
808.47 ft²
75.11 m²

(1) Excluding balconies and terraces

While every attempt has been made to ensure accuracy, all measurements are approximate, not to scale. This floor plan is for illustrative purposes only.

GIRAFFE 360





Score	Energy rating	Current	Potential
92+	A		
81-91	B		
69-80	C		76 C
55-68	D		
39-54	E	52 E	
21-38	F		
1-20	G		

John German

22 Bore Street, Lichfield, Staffordshire, WS13 6LL

01543 419121

lichfield@johngerman.co.uk



Agents' Notes

These particulars do not constitute an offer or a contract neither do they form part of an offer or contract. The vendor does not make or give and Messrs. John German nor any person employed has any authority to make or give any representation or warranty, written or oral, in relation to this property. Whilst we endeavour to make our sales details accurate and reliable, if there is any point which is of particular importance to you, please contact the office and we will be pleased to check the information for you, particularly if contemplating travelling some distance to view the property. None of the services or appliances to the property have been tested and any prospective purchasers should satisfy themselves as to their adequacy prior to committing themselves to purchase.

Referral Fees

Mortgage Services - We routinely refer all clients to APR Money Limited. It is your decision whether you choose to deal with APR Money Limited. In making that decision, you should know that we receive on average £60 per referral from APR Money Limited.

Conveyancing Services - If we refer clients to recommended conveyancers, it is your decision whether you choose to deal with this conveyancer. In making that decision, you should know that we receive on average £150 per referral.

Survey Services - If we refer clients to recommended surveyors, it is your decision whether you choose to deal with this surveyor. In making that decision, you should know that we receive up to £90 per referral.

Ashbourne | Ashby de la Zouch | Barton under Needwood
Burton upon Trent | Derby | East Leake | Lichfield
Loughborough | Stafford | Uttoxeter

JohnGerman.co.uk Sales and Lettings Agent