



Flat 11, Kingshott House, 83 East Street
Epsom

Guide Price **£240,000**



Flat 11

Kingshott House, Epsom

Stylish 1-bed apartment near Epsom Town Centre & train station. Modern kitchen, light-filled interior, secure gated car park. Ideal for first-time buyers or investors. Ready to move in with no chain. Great investment opportunity.

Council Tax band: C

Tenure: Leasehold

EPC Energy Efficiency Rating: C

EPC Environmental Impact Rating: C

- One Bedroom
- First Floor Flat
- Modern Interior
- Video Entry System
- Short Walk to Epsom Town Centre, Station
- Perfect for First Time Buyers or Investors
- No Chain



East Street, Epsom, KT17

Approximate Area = 378 sq ft / 35.1 sq m

For identification only - Not to scale

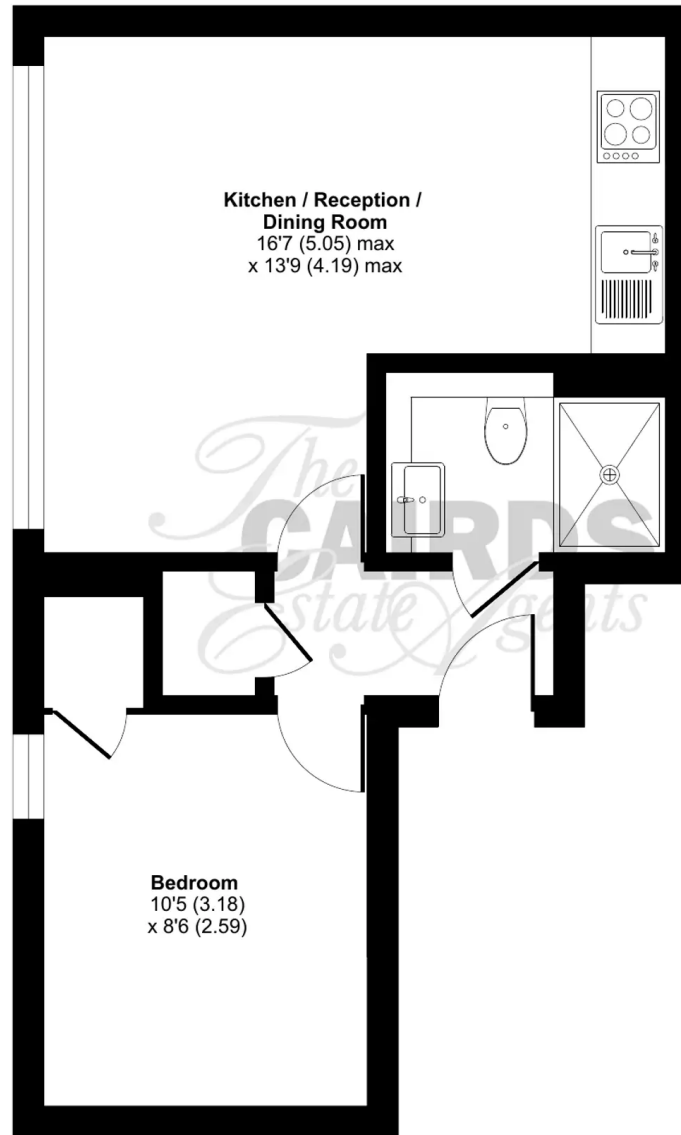

GROUND FLOOR



Floor plan produced in accordance with RICS Property Measurement Standards incorporating International Property Measurement Standards (IPMS2 Residential). © nlcheom 2024. Produced for Cairds. REF: 1110899



Cairds The Estate Agents

Cairds The Estate Agents, 128-130 High Street - KT19 8BT

01372 743033 • homes@cairds.co.uk • www.cairds.co.uk