



## FOR SALE

2 Bed Semi-Detached Bungalow in Derwent Walk, Oadby LE2 4JB  
Offers In Excess Of £240,000

Nestled in a quiet cul de sac within the highly desirable location of Oadby sits this two bedroom semi detached bungalow. The accommodation comprises entrance hall, lounge, fitted kitchen, two bedrooms, bathroom, landscaped gardens, driveway and garage. Call Phillips George to view.



GROUND FLOOR  
565 sq.ft. (52.5 sq.m.) approx.

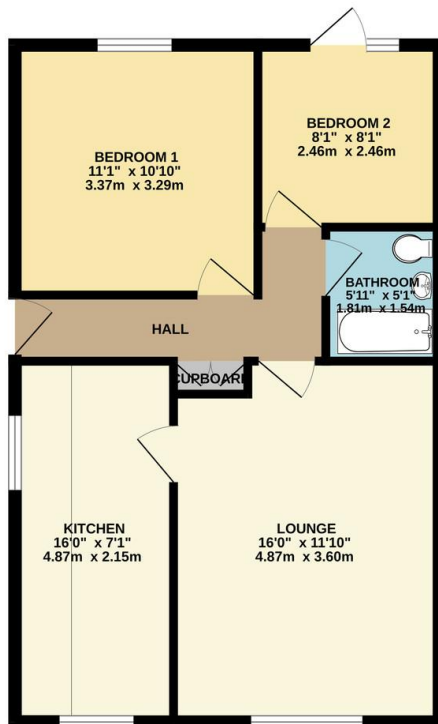

TOTAL FLOOR AREA: 565 sq.ft. (52.5 sq.m.) approx.

Whilst every attempt has been made to ensure the accuracy of the floorplan contained here, measurements of doors, windows, rooms and any other items are approximate and no responsibility is taken for any error, omission or mis-statement. This plan is for illustrative purposes only and should be used as such by any prospective purchaser. The services, systems and appliances shown have not been tested and no guarantee as to their operability or efficiency can be given.  
Made with Metropix ©2024

**Agents Note:** Whilst every care has been taken to prepare these sales particulars, they are for guidance purposes only. All measurements are approximate and are for general guidance purposes only and whilst every care has been taken to ensure their accuracy, they should not be relied upon and potential buyers are advised to recheck the measurements.

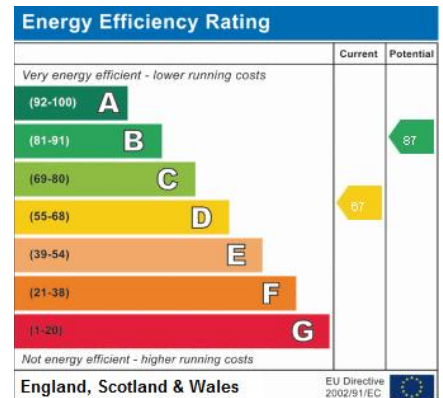

- Semi Detached
- Bungalow
- Two Bedrooms
- Cul De Sac
- Highly Popular Location
- Off Road Parking
- Garage
- Gardens

