

25
YEARS

SERVING
BEACONSFIELD
SINCE 1998

1 Greenwood Close, Beaconsfield

Guide Price £925,000

Ashington Page

Immaculately presented, four bedroom, detached property located on a quiet cul-de-sac in the sought-after village of Seer Green. The location is a short walk to the village centre with its local amenities, bus stop only 150 meters away and the train station with direct links to London Marylebone is under 800 metres away. Beaconsfield is only 3 miles away. The property also sits in catchment for excellent local schools. The current owners have renovated and modernised throughout to create a beautiful family home. Sat Nav: HP9 2SL

FREEHOLD

EPC: D

Council Tax: F

These particulars are for guidance only. They are prepared and issued in good faith and are intended to give a fair summary of the property. Any description should not be relied on as a statement or representation of fact or that the property, or its services, are in good condition. The photographs show only certain parts of the property at the time they were taken. Any areas, measurements or distance given are approximate only. Any reference to alterations to, or use of, any part of the property is not a statement that any necessary planning, building regulations or other consent has been obtained. These matters must be verified by an intending purchaser. All statements contained in these particulars in relation to the property are made without responsibility of Ashington Page or its clients. Neither Ashington Page (nor any joint agents) nor any of their employees has any authority to make or give any representation or warranty whatsoever in relation to the property

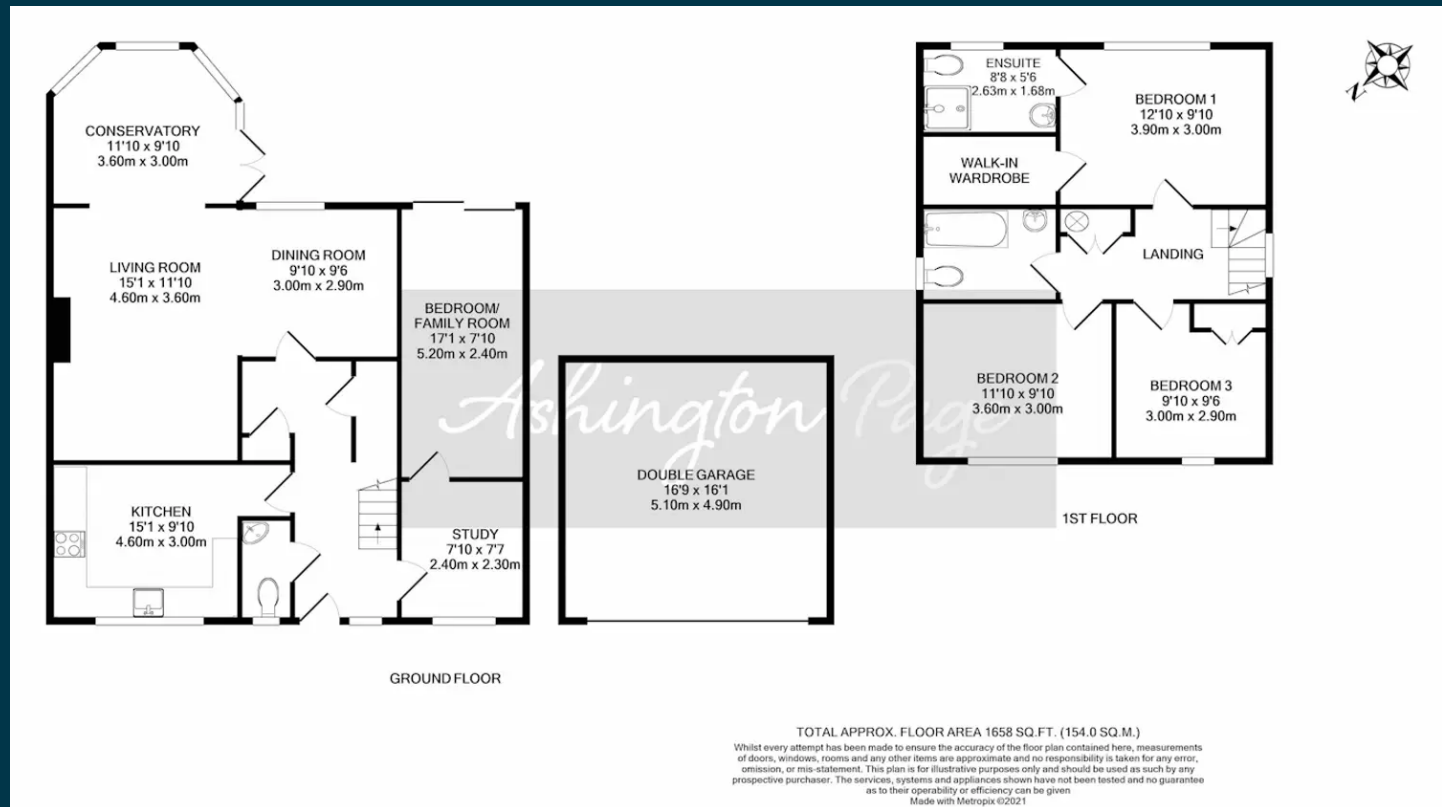

01494 680018
info@ashingtonpage.co.uk
www.AshingtonPage.co.uk

