

25  
YEARS

SERVING  
BEACONSFIELD  
SINCE 1998



1a Woodside Road, Beaconsfield

Guide Price £1,385,000

*Ashington Page*



Introducing this ideally situated 4-bedroom, 2-bathroom family home boasting a south-facing garden and exceptional proximity to Beaconsfield's town center and mainline station to London Marylebone. Partially updated with new bathrooms and internal doors, this property offers a canvas for buyers to infuse their personal style, particularly in the kitchen area.

Freehold

EPC : C

Council Tax Band: G

These particulars are for guidance only. They are prepared and issued in good faith and are intended to give a fair summary of the property. Any description should not be relied on as a statement or representation of fact or that the property, or its services, are in good condition. The photographs show only certain parts of the property at the time they were taken. Any areas, measurements or distance given are approximate only. Any reference to alterations to, or use of, any part of the property is not a statement that any necessary planning, building regulations or other consent has been obtained. These matters must be verified by an intending purchaser. All statements contained in these particulars in relation to the property are made without responsibility of Ashington Page or its clients. Neither Ashington Page (nor any joint agents) nor any of their employees has any authority to make or give any representation or warranty whatsoever in relation to the property

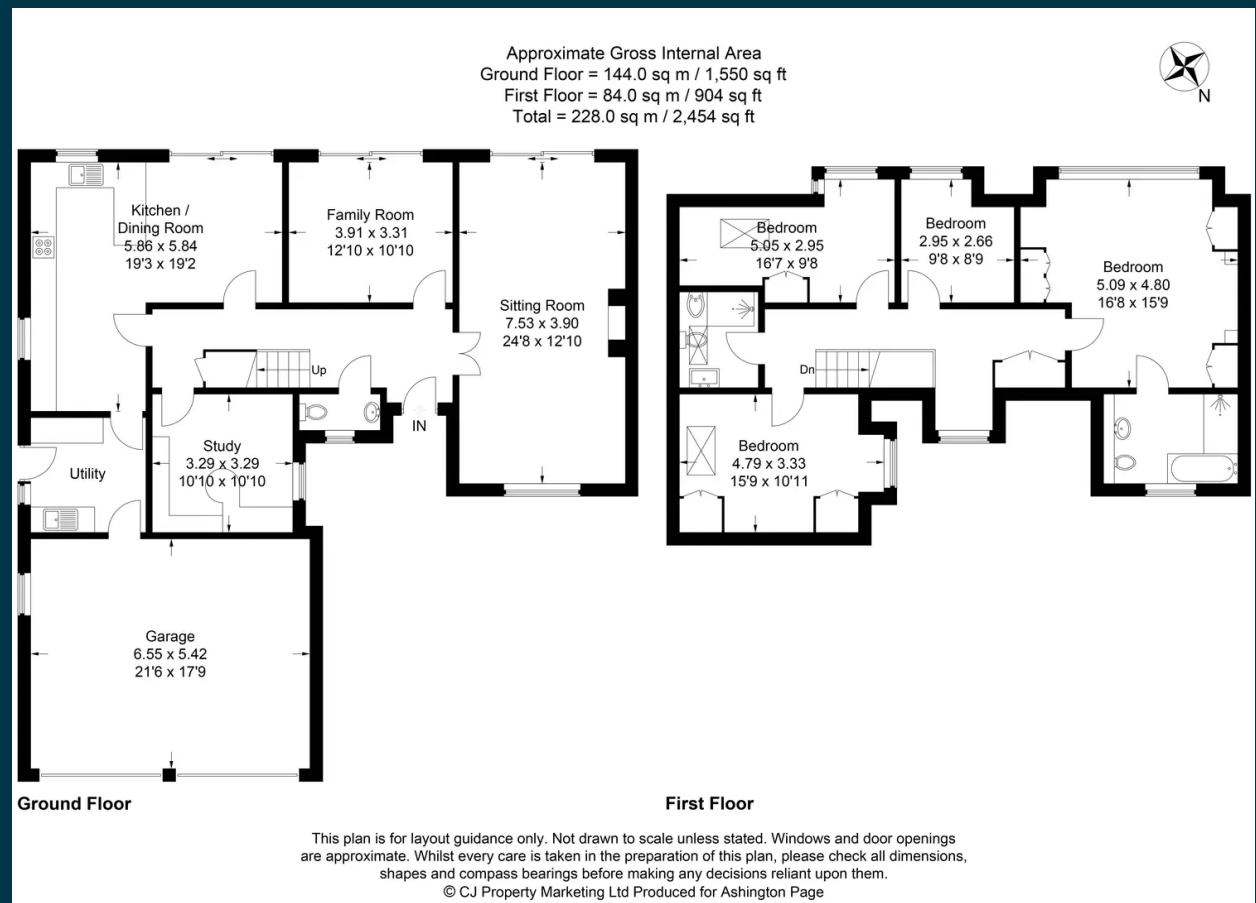

01494 680018  
info@ashingtonpage.co.uk  
www.AshingtonPage.co.uk

