



Flat 27, Discovery Wharf, 15 North Quay
£350,000



Flat 27

Discovery Wharf, Plymouth

Luxurious 2-bed apartment on 4th floor of prestigious landmark building in waterfront location. Stunning views of Sutton Harbour & Plymouth Sound. Stylish open-plan layout, modern kitchen, en-suite master bedroom, utility room, south-facing balcony, Underground parking, on-site leisure facilities. Sophisticated living with convenience & elegance.

Council Tax band: E

Tenure: Leasehold

- 4th Floor Waterfront Apartment
- Large South Facing Covered Balcony
- Allocated Underground Parking
- Landmark Building
- Views of Sutton Harbour and Plymouth Sound
- Two Double Bedrooms
- Master En-suite
- Separate Utility Room
- Access to Leisure Facilities





SIXTH FLOOR

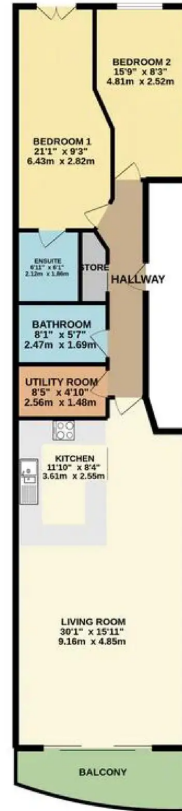

Whilst every attempt has been made to ensure the accuracy of the floorplan contained here, measurements of doors, windows, rooms and any other items are approximate and no responsibility is taken for any error, omission or mis-statement. This plan is for illustrative purposes only and should be used as such for any prospective purchaser. The services, systems and appliances shown have not been tested and no guarantee as to their operability or efficiency can be given.
Made with Metropix ©2022

Atwell Martin

Atwell Martin, 65 Southside Street - PL1 2LA

01752 202121

plymouthsales@atwell-martin.co.uk

plymouth.atwellmartin.co.uk/

Atwell Martin Plymouth endeavour to ensure the accuracy of property details produced and displayed. Please note that we have not tested any apparatus, equipment, fixtures, fittings or services and so cannot verify that they are connected, in working order or fit for purpose. It is imperative that the buyer of any property makes such checks, prior to purchase so as to satisfy themselves of the properties suitability for their purchase. .