



32 STAPLETON CLOSE, HIGHWORTH, SN6 7DR

OFFERS IN REGION OF £335,000



32 Stapleton Close, Highworth, SN6 7DR

Offered For Sale in an Elevated Position with far reaching views is this IMMACULATELY PRESENTED Three Bedroom Semi-Detached Family Home within walking distance of the High Street. The accommodation briefly comprises; Entrance Hall, Sitting/Dining Room and a L-Shaped MODERN FITTED Kitchen/Dining Room. Upstairs are Three Good Sized Bedrooms and a Large Family Bathroom. Outside are well presented gardens, an Integral Garage and a Covered Secure Side Passage. The property is fully uPVC double glazed and heating is by means of gas fired radiators.



Ground Floor

Approx. 50.9 sq. metres (548.0 sq. feet)

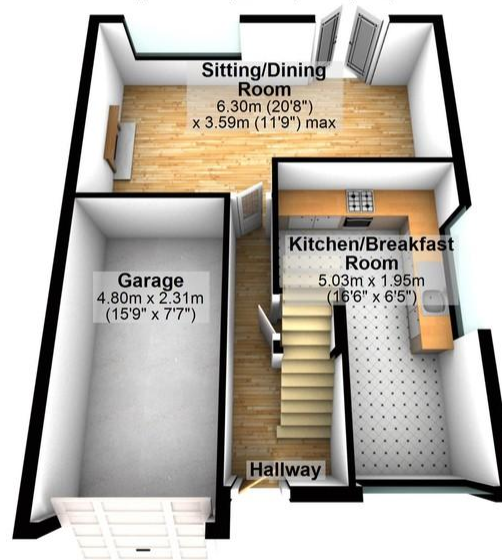

First Floor

Approx. 40.9 sq. metres (439.7 sq. feet)



Total area: approx. 91.8 sq. metres (987.7 sq. feet)