



2 Bedroom Bungalow **£475,000**

83 Chestnut Springs, Lydiard Millicent, Swindon, SN5 3NB

mcfarlane
property.com

2 Bedroom Bungalow Swindon, Lydiard Millicent, SN5

- DETACHED BUNGALOW
 - TWO DOUBLE BEDROOMS
 - EN-SUITE SHOWER
 - FRONT & REAR GARDENS
 - AMPLE DRIVEWAY PARKING
 - VILLAGE LOCATION
-



Property description

Situated in the sought after location of Chestnut Springs, McFarlane Sales & Lettings are delighted to offer to market this well-appointed detached bungalow. Accommodation offers a spacious entrance hallway, expansive living room with a feature bay window, kitchen, family bathroom, two double bedrooms one with en-suite shower and a conservatory to the rear of the property. Further benefits include well maintained front and rear gardens, ample driveway parking, a carport and a garage with both power and light. Positioned within the beautiful village of Lydiard Millicent the property is well located, close to all local amenities, schools, shops and great transport links to J16.



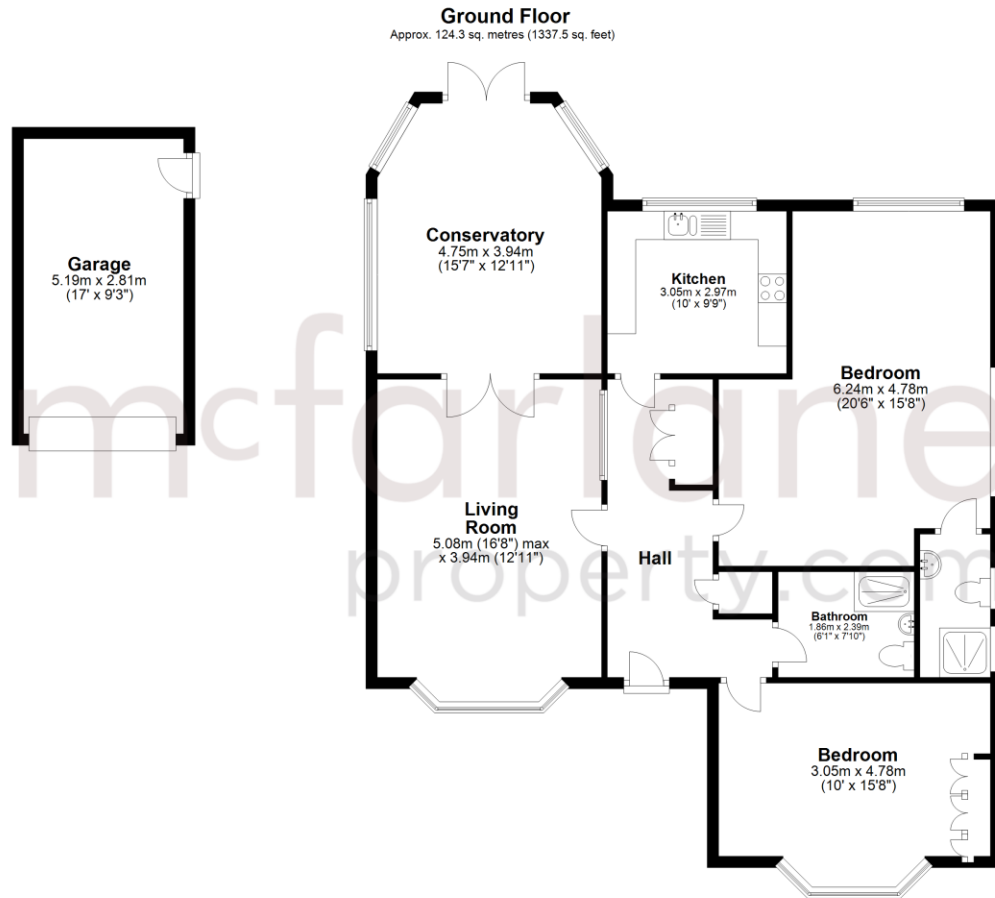

Total area: approx. 124.3 sq. metres (1337.5 sq. feet)

We 
where you
LIVE

Our team are friendly, experienced and are all local. They know it better than they do their own living rooms and can help you find what you're looking for because **we love where we live.**

We would be delighted to show you around this property.

Because every home needs a personal touch.

If you would like to view this property then please get in touch.

 01793 296880

 oldtown@mcfarlaneproperty.com

mcfarlaneproperty.com

mcfarlane
property.com

Cricklade.

102 High Street
Cricklade SN6 6AA

 01793 751044

Marlborough.

106 High Street
Marlborough SN8 1LT

 01672 514380

Old Town.

28-30 Wood Street
Swindon SN1 4AB

 01793 296880

Swindon.

The Village Centre,
Redhouse SN25 2FW

 01793 296600

Agents Note: Whilst every care has been taken to prepare these sales particulars, they are for guidance purposes only. All measurements are approximate are for general guidance purposes only and whilst every care has been taken to ensure their accuracy, they should not be relied upon and potential buyers are advised to recheck the measurements