

# Denstone Lane

Alton, Stoke-on-Trent, ST10 4AX



Attractive traditional semi detached coach house conversion for sale with no upward chain. Situated in a quiet cul de sac towards the edge of the highly desirable village.

Offers Over £180,000



John German 

Absolutely ideal first time buy, downsize, lock and leave bolthole or investment, whether as a buy to let or a holiday let enterprise. Viewing and consideration of this semi detached coach house conversion is essential to appreciate its room dimensions and scope for personalisation.

Situated on the edge of the highly desirable village but still within easy reach of its wide range of amenities including the convenience shop, public houses and eateries, first school, health centre, village hall, church and hair salon. Walks through the surrounding countryside are also on the doorstep through the Churnet Valley towards Dimmingsdale and Oakamoor. The towns of Uttoxeter, Ashbourne and Cheadle are all within easy commutable distance, as are the world head quarters of JCB and surrounding road networks.

A composite and part obscured double glazed entrance door opens to the impressive fitted kitchen which extends to the depth of the property having a range of base and eye level units with work surfaces and inset sink unit set below the front facing window, fitted electric hob with an extractor hood over and oven under, and integrated appliance including a dishwasher, washing machine and fridge freezer. A part obscured double glazed door gives access to the rear of the property and stairs rise to the first floor.

The generously sized living dining room has two front facing windows and an understairs cupboard.

To the first floor the landing has doors leading to the two double bedrooms, each extending to the depth of the property with front facing windows.

Completing the accommodation is the fitted shower room which has a modern white suite incorporating a corner shower cubicle with half tiled walls and a tiled floor, plus a front facing window.

Outside to the rear, steps lead to decking providing a pleasant seating area leading to the garden laid to lawn, enclosed to three sides, plus a block paved access leading to the front. To the front, there is block paved off road parking.

**What3words:** glorious.weaved.vaulting

**Tenure:** Freehold (purchasers are advised to satisfy themselves as to the tenure via their legal representative).

**Property construction:** TBC

**Parking:** Drive

**Electricity supply:** TBC

**Water supply:** TBC

**Sewerage:** TBC

**Heating:** TBC

(Purchasers are advised to satisfy themselves as to their suitability).

**Broadband type:** See Ofcom link for speed: <https://checker.ofcom.org.uk/>

**Mobile signal/coverage:** See Ofcom link <https://checker.ofcom.org.uk/>

**Local Authority/Tax Band:**

Staffordshire Moorlands District Council / Tax Band TBC

**Useful Websites:** [www.gov.uk/government/organisations/environment-agency](http://www.gov.uk/government/organisations/environment-agency)

[www.staffs Moorlands.gov.uk](http://www.staffs Moorlands.gov.uk)

**Our Ref:** JGA/19042024

The property information provided by John German Estate Agents Ltd is based on enquiries made of the vendor and from information available in the public domain. If there is any point on which you require further clarification, please contact the office and we will be pleased to check the information for you, particularly if contemplating travelling some distance to view the property. Please note if your enquiry is of a legal or structural nature, we advise you to seek advice from a qualified professional in their relevant field.

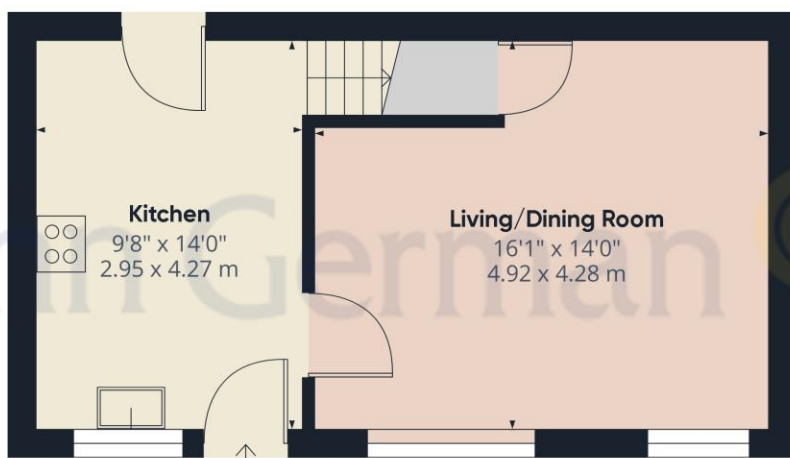

Ground Floor

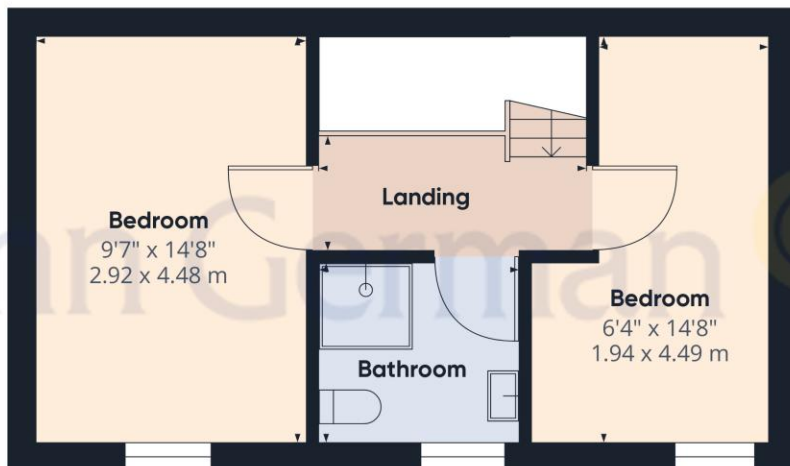

Floor 1

John German

Approximate total area<sup>(1)</sup>  
705.91 ft<sup>2</sup>  
65.58 m<sup>2</sup>

(1) Excluding balconies and terraces

While every attempt has been made to ensure accuracy, all measurements are approximate, not to scale. This floor plan is for illustrative purposes only.

GIRAFFE360





AWAITING EPC MEDIA



John German  
 9a Market Place, Uttoxeter, Staffordshire, ST14 8HY  
 01889 567444  
 uttoxeter@johngerman.co.uk

**Agents' Notes**  
 These particulars do not constitute an offer or a contract neither do they form part of an offer or contract. The vendor does not make or give and Messrs. John German nor any person employed has any authority to make or give any representation or warranty, written or oral, in relation to this property. Whilst we endeavour to make our sales details accurate and reliable, if there is any point which is of particular importance to you, please contact the office and we will be pleased to check the information for you, particularly if contemplating travelling some distance to view the property. None of the services or appliances to the property have been tested and any prospective purchasers should satisfy themselves as to their adequacy prior to committing themselves to purchase.

**Referral Fees**  
**Mortgage Services** - We routinely refer all clients to APR Money Limited. It is your decision whether you choose to deal with APR Money Limited. In making that decision, you should know that we receive on average £60 per referral from APR Money Limited.  
**Conveyancing Services** - If we refer clients to recommended conveyancers, it is your decision whether you choose to deal with this conveyancer. In making that decision, you should know that we receive on average £150 per referral.  
**Survey Services** - If we refer clients to recommended surveyors, it is your decision whether you choose to deal with this surveyor. In making that decision, you should know that we receive up to £90 per referral.

Ashbourne | Ashby de la Zouch | Barton under Needwood  
 Burton upon Trent | Derby | East Leake | Lichfield  
 Loughborough | Stafford | Uttoxeter

**JohnGerman.co.uk Sales and Lettings Agent**