



# Mountfield Road, London

Furnished or Unfurnished | 5 Bedrooms | 2 Receptions | 3 Bathrooms | 1 guest WC | Large Garden | Summer house | Off-street Parking

Asking Price: £5,000 Per month

A beautiful modern home with a great layout offering plenty of space, parking, garden and summer house.

Offered furnished or unfurnished, you will be impressed with the layout which includes on the ground floor a large formal living room along with a casual family room that could be used as a guest room if needed.

There is a guest WC and the kitchen has been extended letting in plenty of light and is a great space to enjoy hours of family meals or entertainment. Stylishly designed cupboards line the hallway providing plenty of hidden storage. The large garden includes a summer house for overflow use or storage. On the upper 2 floors, you will find 5 bedrooms, 3 baths (including a master bedroom with ensuite and walk-in closet), a laundry room and plenty of storage.

This stylish home also includes off-street parking that can comfortably accommodate 2 cars.

### ***More About the Location***

You couldn't ask for a better location as Mountfield Road is a popular tree-lined street well located in the catchment area for several highly desirable schools and places of worship.

While it offers quiet and serenity, you are just a short walk away from Finchley Central tube station and the nearby local shops, amenities and other transport services. You will be a short walk to Stephens House & Gardens with its extensive landscaped gardens and the highly sought-after Akiva & St. Theresa schools. Hampstead Heath extension is also 30 mins. walk.

A great home to raise your family. Get in touch to book a viewing.





# Mountfield Road, London, N3

Approximate Area = 2567 sq ft / 239 sq m

Limited Use Area(s) = 37 sq ft / 3 sq m

Outbuilding = 62 sq ft / 6 sq m

Total = 2666 sq ft / 248 sq m

For identification only - Not to scale



Denotes restricted head height

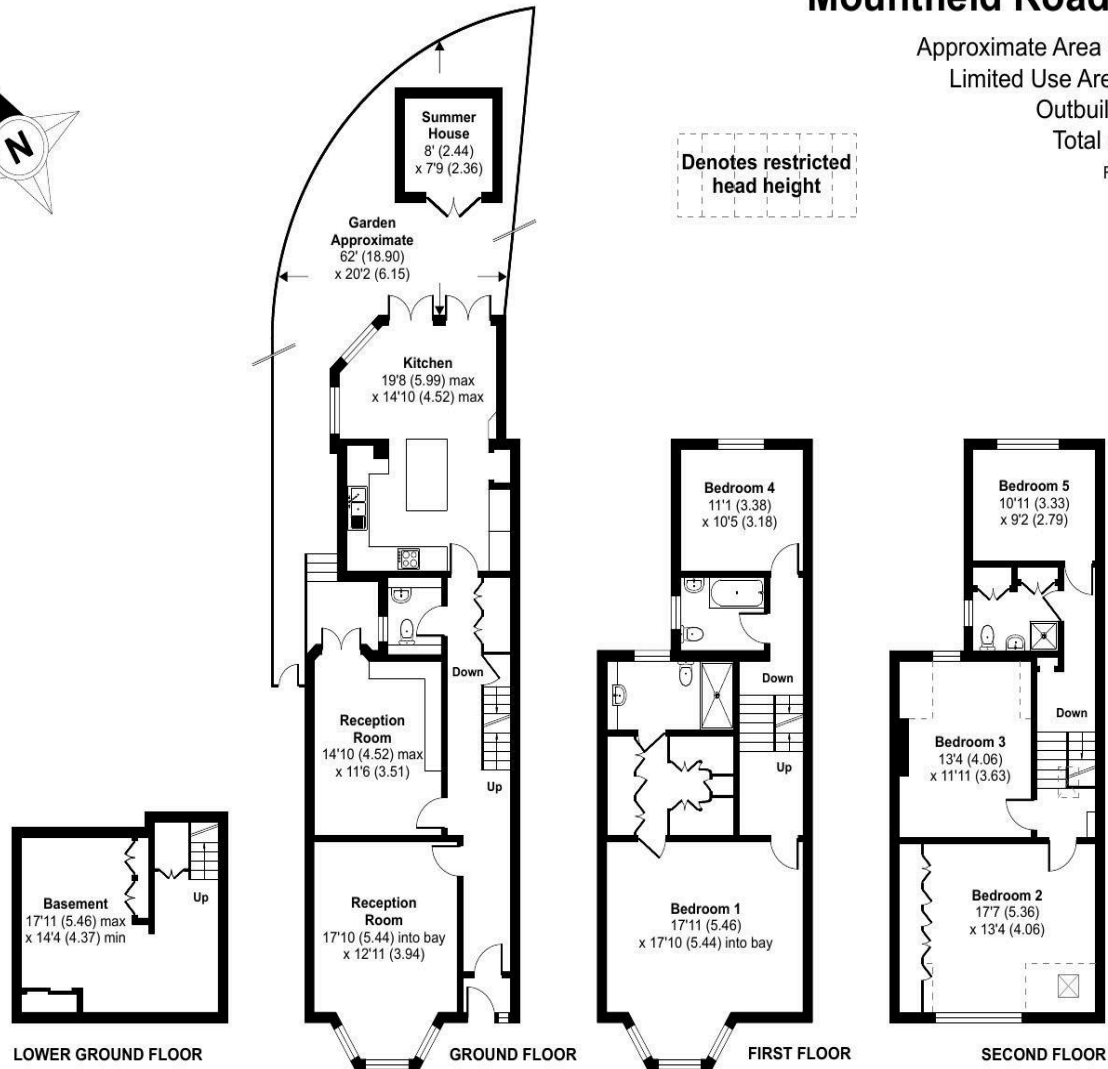

Floor plan produced in accordance with RICS Property Measurement Standards incorporating International Property Measurement Standards (IPMS2 Residential). © nitchecom 2022. Produced for Onyx Property Consultants Ltd. REF: 901711