

25
YEARS

SERVING
BEACONSFIELD
SINCE 1998

16 Orchard Road, Beaconsfield

Guide Price £485,000

Ashington Page

Ideally situated in a peaceful location, this 2 bedroom end terrace house boasts a generous rear garden and enjoys proximity to both the historic charm of Beaconsfield's Old Town and the modern amenities of its New Town. The property is within walking distance to a comprehensive range of shops, and the mainline station, with fast trains to London Marylebone, in just 23 minutes.

Freehold

Council Tax: C

EPC: D

These particulars are for guidance only. They are prepared and issued in good faith and are intended to give a fair summary of the property. Any description should not be relied on as a statement or representation of fact or that the property, or its services, are in good condition. The photographs show only certain parts of the property at the time they were taken. Any areas, measurements or distance given are approximate only. Any reference to alterations to, or use of, any part of the property is not a statement that any necessary planning, building regulations or other consent has been obtained. These matters must be verified by an intending purchaser. All statements contained in these particulars in relation to the property are made without responsibility of Ashington Page or its clients. Neither Ashington Page (nor any joint agents) nor any of their employees has any authority to make or give any representation or warranty whatsoever in relation to the property

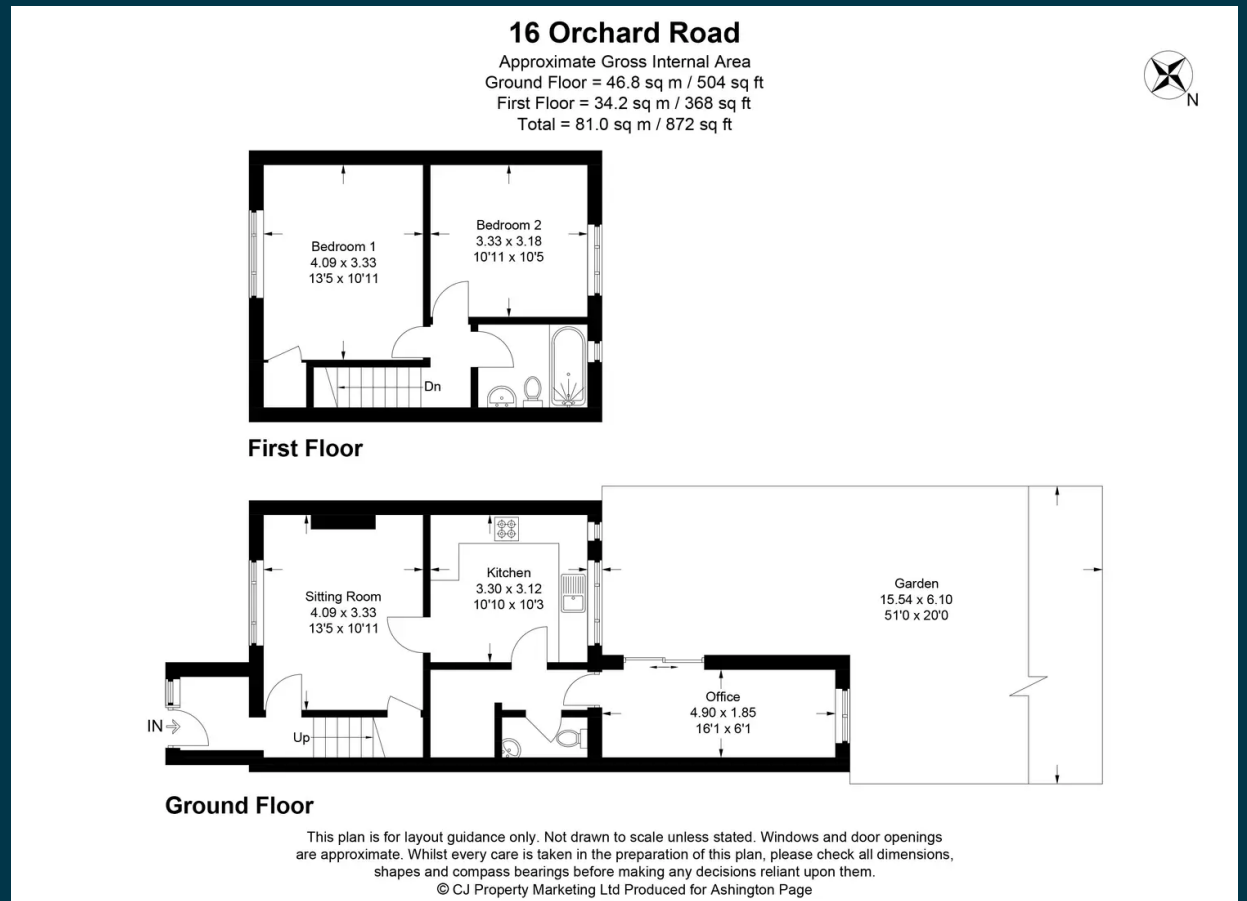

01494 680018
info@ashingtonpage.co.uk
www.AshingtonPage.co.uk

