

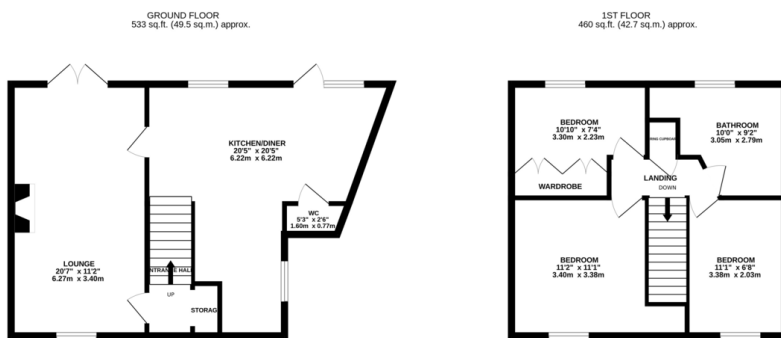

FOR SALE

3 Bed End Town House in Margaret Crescent, Wigston, LE18 2EH
£270,000

An immaculate and extended family home for sale in Wigston. The accommodation comprises entrance hall, lounge, open plan living kitchen, downstairs w.c., three bedrooms, family bathroom, large rear garden with home office/summer house and ample off road parking. This is one not to miss!



TOTAL FLOOR AREA: 993 sq.ft. (92.2 sq.m.) approx.
While every attempt has been made to ensure the accuracy of the floorplan contained herein, measurements of doors, windows, rooms and any other items are approximate and no responsibility is taken for any error, omission or mis-statement. This plan is for illustrative purposes only and should be used as such by any prospective purchaser. The services, systems and appliances shown have not been tested and no guarantee as to their operability or efficiency can be given.
Made with Hesign ©2024

EPC to follow

- Corner Plot
- Extended
- End Town House
- Home Office/Summer House
- Three Bedrooms
- Four Piece Bathroom Suite
- Immaculate Throughout
- Downstairs W.C.

Agents Note: Whilst every care has been taken to prepare these sales particulars, they are for guidance purposes only. All measurements are approximate and for general guidance purposes only and whilst every care has been taken to ensure their accuracy, they should not be relied upon and potential buyers are advised to recheck the measurements.

