

BIRCH ABBEY ALCESTER WARWICKSHIRE



A most charming and sympathetically re-decorated period cottage, located just a stone's throw away from the town centre high street. Being offered with no upward chain and boasting an inglenook style fireplace and exposed timbers.

Enjoying a communal courtyard setting and having accommodation to include: Open-plan lounge and kitchen, two bedrooms and bathroom.

£195,000

Birch Abbey, Alcester, Warwickshire, B49 5BU

Sitting Room

14'4" x 11'3" (4.36 x 3.43)



Kitchen

11'9" x 3'8" (3.58 x 1.11)



Bedroom One

11'8" x 8'8" (3.55 x 2.63)



Bedroom Two

8'1" x 7'1" (2.47 x 2.16)



Bathroom



Fixtures & Fittings

Please note that the fixtures & fittings shown on the photographs, contained within these property details, do not form part of a fixtures & fittings list. Some items may/may not be included. You are advised to clarify what items are included before entering into any negotiations.

Floor Plans & Property Details Disclaimer

These floor plans are for identification purposes only in relation to where one room is situated to another. They are not to be relied upon in any way for dimensions, scaling or sq. ft/metres. We will not be held responsible for any loss incurred, due to reliance on these measurements from the floor plans or measurements from the property details. You are advised to confirm all measurements.

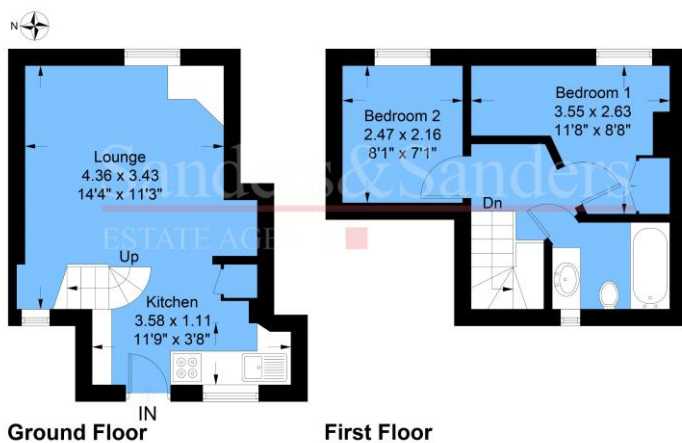

Approximate Gross Internal Area = 42.5 sq m / 457 sq ft
Illustration for identification purposes only,
measurements are approximate, not to scale.

