



## Semi Detached FAMILY HOME

CHECK OUT this lovely modern FAMILY HOME. Living Dining Room & Kitchen, UNDERFLOOR HEATING, 3 Bedrooms, En-suite, Bathroom & Cloakroom, quiet side Street, close to Schools, Shops, Country Park & Town Centre, Garden, Garage & Parking. Well-presented throughout.

11 Post Coach Way | Exeter | EX5 7BR







PROPERTY TYPE

Semi Detached House



SIZE

988 sq ft



LOCATION

Town



AGE

Modern



BEDROOMS

3



RECEPTION ROOMS

1



BATHROOMS

2



WARMTH

EON District Heating System



PARKING

Garage, Off Road Parking



OUTSIDE SPACE

Garden, Large Garden



EPC RATING

77 (C)



COUNCIL TAX BAND

C



### in a nutshell...

- Living Dining Room
- Kitchen
- Underfloor Heating
- 3 Bedrooms
- En-suite, Bathroom & Cloakroom
- Sunny Garden
- Off Road Parking & Garage
- Close to Schools, Shops & Town Centre
- Easy access to M5, A30 & Exeter







## the details...

CHECK OUT this lovely modern, Semi-Detached FAMILY HOME with 3 Bedrooms, Kitchen, Living Dining Room, En-suite Shower. Bathroom. Garden, Garage, Parking. Conveniently located a short walk from the shops, parks, schools and amenities in the new town of Cranbrook, with excellent road and rail links to the city of Exeter.

Inside it is well presented with light and neutral décor throughout and feels warm and welcoming with community central heating and double glazing.

The accommodation comprises of, on the ground floor, an entrance hallway with a convenient ground floor cloakroom and a staircase to the first floor, a kitchen with UNDER FLOOR HEATING and plenty of worktop and cupboard space in a wood-effect. It has a fan-oven, an electric hob with a filter hood above, an integrated washer/dryer, and floor space for an upright fridge/freezer.

The Living/Dining Room is spacious and filled with light from a window and French doors to the garden and there is a cupboard beneath the stairs which is used as a study area, also with UNDER FLOOR HEATING

Upstairs, the main Bedroom is an excellent double with a fitted wardrobe that has sliding mirror doors, and an en-suite shower room., with UNDER FLOOR HEATING. There are two further light and airy Bedrooms, a double and a single, and a family Bathroom, with UNDER FLOOR HEATING which contains a white suite comprising of a bath, a pedestal basin and a WC, and the landing has a cupboard, and a hatch in the ceiling providing loft access.

Outside, the rear garden is fully enclosed making it safe for both children and pets. There are patios of paving, and a split-level lawn making a great outside space for entertaining, be it alfresco dining or a barbecue, and a door leads into the rear of the attached single garage which has lights, power, storage above in the rafters and an up and over door to the driveway where there is an additional parking space immediately in front, with more available on-road if required.

Property Tenure: Freehold  
Council Tax Band: C



## what the owner loves most...



# the floorplan...

GARAGE  
172 sq.ft. (16.0 sq.m.) approx.

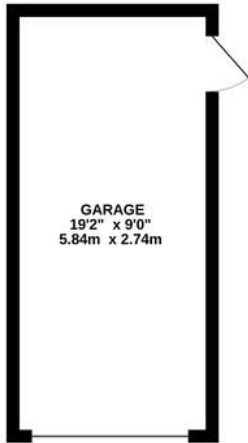

GROUND FLOOR  
408 sq.ft. (37.9 sq.m.) approx.

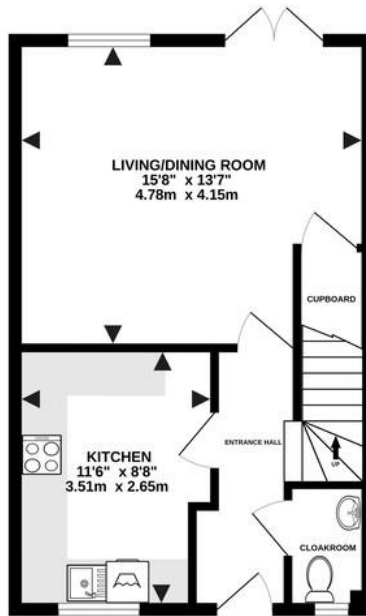

1ST FLOOR  
408 sq.ft. (37.9 sq.m.) approx.

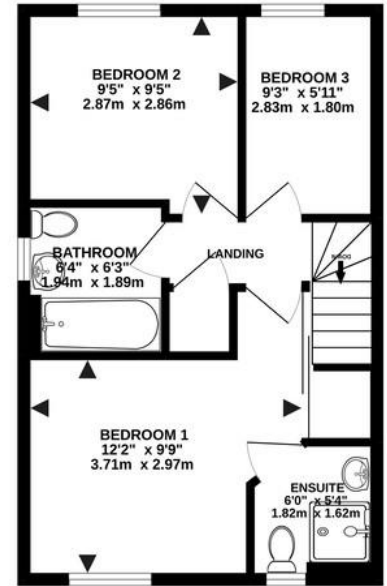

TOTAL FLOOR AREA : 988 sq.ft. (91.8 sq.m.) approx.

Whilst every attempt has been made to ensure the accuracy of the floorplan contained here, measurements of doors, windows, rooms and any other items are approximate and no responsibility is taken for any error, omission or mis-statement. This plan is for illustrative purposes only and should be used as such by any prospective purchaser. The services, systems and appliances shown have not been tested and no guarantee as to their operability or efficiency can be given.  
Made with Metropix ©2022



Our note. For clarification we have prepared these sales particulars as a general guide and have not carried out a detailed survey nor tested the services, appliances or fittings. Room sizes should not be relied upon for carpets or furnishings. If there are any important matters which are likely to affect your decision to buy, please contact us before viewing this property. These particulars, whilst believed to be accurate, are set out as a general outline only for guidance and do not constitute any part of an offer or contract. Intending purchasers should not rely on them as statements of representation of fact, but must satisfy themselves by inspection or otherwise as to their accuracy. No person in the employment of Complete Property Services has the authority to make or give any representation or warranty in respect of the property.

**SKETCH PLAN FOR ILLUSTRATIVE PURPOSES ONLY.** All measurements and sizes and locations of walls, doors, window fittings and appliances are shown conventionally and are approximate only and cannot be regarded as being a representation either by the Seller or his Agent. We hope that these plans will assist you by providing you with a general impression of the layout of the accommodation. The plans are not to scale nor accurate in detail. © Unauthorised reproduction prohibited.

As part of the service we offer we may recommend ancillary services to you which we believe will help with your property transaction. We wish to make you aware that should you decide to proceed we will receive a referral fee. This could be a fee, commission, payment or other reward. We will not refer your details unless you have provided consent for us to do so. You are not under any obligation to provide us with your consent or to use any of these services, but where you do you should be aware of the following referral fee information. You are also free to choose an alternative provider. To find out more about this, please speak to a member of the team.





## the location...

The popular new town known as Cranbrook is located on the outskirts of the historic city of Exeter, East Devon. Cranbrook has excellent commuting links with Exeter Airport and the M5 Motorway is only a short drive away. Cranbrook also has the benefit of its own railway station just a 10 minute walk away connecting to the city centre and London.

As Cranbrook grows so do the facilities, already having a thriving community with the Younghayes centre at its heart.

There are local shops along with a doctor's surgery, pharmacy and a highly regarded primary school & secondary education campus. There is also a new developing Town Centre and Supermarket.

## Shopping

Co-op & Post Office  
Supermarket TBC  
Honiton Town  
Exeter City

## Relaxing

Beach: Exmouth & Sidmouth  
Park & Swings: Hayes Square & Badger Way

## Travel

Bus stop: Younghayes Road  
Train station: Cranbrook  
Main travel link: M5 & A30  
Airport: Exeter

## Schools

St Martins Primary School:  
Cranbrook Education Campus:

Please check Google maps for exact distances and travel times.

Property postcode: **EX5 7BR**







Need a more complete picture? Get in touch with your local branch...

Tel [01392 422500](tel:01392422500)  
Email [exeter@completeproperty.co.uk](mailto:exeter@completeproperty.co.uk)  
Web [completeproperty.co.uk](http://completeproperty.co.uk)

Complete  
141 Younghayes Rd  
Cranbrook  
EX5 7DR

Are you selling a property too? Call us to get a set of property details like these...

selling

letting

land &  
new homes

signature  
homes

**complete.**