



mcfarlane
property.com



5 Bedrooms Detached House Guide Price £695,000

2002 Stoneover Lane, Royal Wootton Bassett, Swindon, SN4 8EX

mcfarlane
property.com

5 Bedrooms Detached House Swindon, Royal Wootton Bassett

- Five Bedroom Detached Family Home
- Plus Studio / Annexe £650 PCM
- Altered and Greatly Improved

An individually built and designed Family Home with Annexe positioned in a much sought after Royal Wootton Bassett location. Over recent years this delightful home has been altered and greatly improved. Currently there are three floors with a total of Five Bedrooms PLUS Annexe / Studio (over the Garage rental value of £650 PCM £7,800 PA). The property has had a subtle loft conversion to include Two Bedrooms and a further Shower Room. A brief summary of accommodation comprises: Entrance Hallway, Cloakroom, Living Room, Conservatory, Fitted Kitchen / Dining / Family Room. To the First Floor Master Bedroom with En-Suite and Family Bathroom. The Second Floor boasts Two Bedrooms and Shower Room. There is

Property description





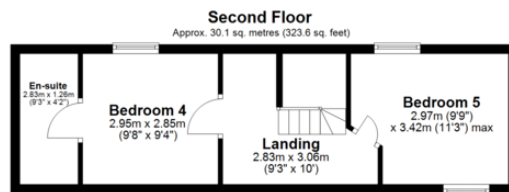
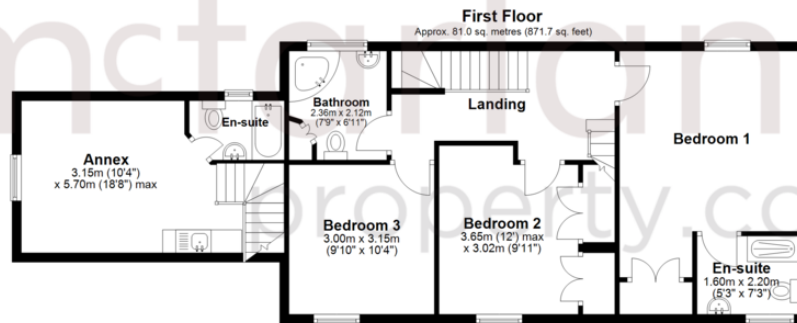

Total area: approx. 225.8 sq. metres (2430.2 sq. feet)

We 
where you
LIVE

Our team are friendly, experienced and are all local. They know it better than they do their own living rooms and can help you find what you're looking for because **we love where we live.**

We would be delighted to show you around this property.

**Because every home
needs a personal touch.**

**If you would like to view this
property then please get in touch.**

☎ 01793 751044

✉ cricklade@mcfarlaneproperty.com

mcfarlaneproperty.com

mcfarlane
property.com

Cricklade.
102 High Street
Cricklade SN6 6AA
☎ 01793 751044

Marlborough.
106 High Street
Marlborough SN8 1LT
☎ 01672 514380

Old Town.
28-30 Wood Street
Swindon SN1 4AB
☎ 01793 296880

Swindon.
The Village Centre,
Redhouse SN25 2FW
☎ 01793 296600

Agents Note: Whilst every care has been taken to prepare these sales particulars, they are for guidance purposes only. All measurements are approximate are for general guidance purposes only and whilst every care has been taken to ensure their accuracy, they should not be relied upon and potential buyers are advised to recheck the measurements