



Flat 7, Owen House Whitcombe Gardens, Portsmouth

Offers in Region of £62,000

 chinneckshaw



Flat 7

Owen House Whitcombe Gardens, Portsmouth

This shared ownership property is located in Owen House on St Marys Road. There are a number of local amenities within walking distance and the property is within easy access of the Eastern Road and other transport links.

With a balcony overlooking landscaped communal grounds, this one bedroom first floor flat has a lovely feel to it and generous size accommodation. The large communal entrance hallway with a secure entry system has stairs and a lift to all floors.

You are welcomed into a generous hallway giving access to the bathroom, the bedroom, kitchen and the living area. It also has a good-sized storage cupboard perfect for coats and shoes.

The kitchen has a range of fitted wall and base units with space for cooker, fridge and washing machine. The modern bathroom has a white suite with tiles and a window to the side.

The Lounge is a good size with access to the balcony with windows either side of the door which allow plenty of light into the room and give views out to the mature trees surrounding the building. At the other end of the hallway the double bedroom is a great size with ample space for double bed, wardrobe and drawers. The property is well decorated and has electric heating throughout.

This is age exclusive housing and new residents must be aged over 60 years. Service Charge is £ 179.03 per month. Shared ownership proportion = 75%

Council Tax band: A

Tenure: Leasehold



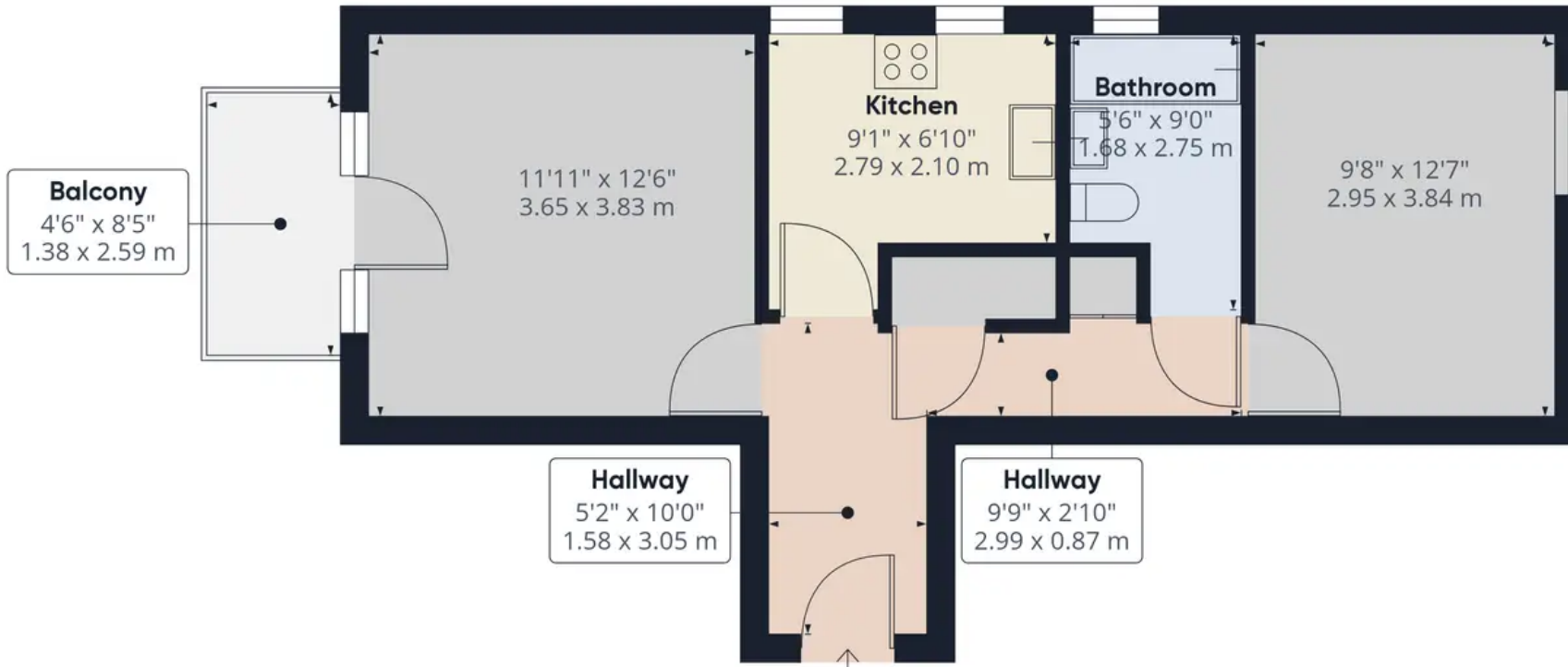

Approximate total area⁽¹⁾
 494.21 ft²
 45.91 m²

(1) Excluding balconies and terraces

While every attempt has been made to ensure accuracy, all measurements are approximate, not to scale. This floor plan is for illustrative purposes only.

GIRAFFE360



Chinneck Shaw

Bridge House, Milton Road, Portsmouth – PO3 6AN

023 9282 6731

hello@chinneckshaw.co.uk

www.chinneckshaw.co.uk/

Chinneck Shaw, Bridge House, Milton Road, PO3 6AN Consumer Protection from Unfair Trading Regulations 2008: These details are for guidance only and complete accuracy cannot be guaranteed. If there is any point which is of particular importance, verification should be obtained. The do not constitute a contract or part of a contract. All measurements are approximate. No guarantee can be given with regard to planning permissions or fitness for purpose. No apparatus, equipment, fixture or fitting has been tested. Items shown in the photographs are NOT necessarily included. Interested Parties are advised to check availability and make an appointment to view before travelling to see a property.