

# Bretby Hall

Bretby, Burton-on-Trent, DE15 0QQ



A beautifully presented apartment with a rooftop garden and accommodation over two floors comprising two bedrooms each with en-suite, lounge, and a fitted kitchen/diner, set in Bretby Hall surrounded by stunning grounds and countryside. Grade II listed. Leasehold.

£250,000



John German 

Set in Grade II listed Bretby Hall with landscaped grounds and countryside creating an idyllic approach to this superbly presented apartment with accommodation over two floors.

#### Directions

Leaving Burton via the Old Bridge proceed onto the A511 Ashby Road. Proceed straight on at the mini island, go past the Golf Club and Bretby Business Park. Just before the Chesterfield Arms, turn left and follow the lane to Bretby Hall.

#### Accommodation

The property is accessed via the courtyard which has double electric gates and a residents lift to the property.

An oversized timber door opens into the entrance hall which has stairs and doors leading off. The apartment is presented in a contemporary style with high ceilings and windows still offering that character feel.

Bedroom two is a generous double with window and shutters framing views of the courtyard and there is a stylish en-suite wet room. Off the hall is also a guest WC.

The staircase leads to the first floor with a landing having doors leading off and a door out to the roof top garden. The lounge has wood effect flooring and window to side. The kitchen/diner is fitted with a range of stylish units and has space for a table and window overlooking the courtyard.

The master bedroom has a smart en-Suite bathroom fitted in a contemporary style with chrome fittings.

The highlight of this property is arguably the roof top garden with decking and seating areas enjoying views over the rooftop of the hall and trees beyond.

The apartment has two allocated parking spaces.

**Tenure:** Leasehold. Lease commenced December 2000 with a term of 125 years (purchasers are advised to satisfy themselves as to the tenure via their legal representative).

**Service charge:** £980 per annum

**Ground rent:** £150 per annum

**Property construction:** Standard

**Parking:** Allocated parking

**Electricity supply:** Mains

**Water supply:** Mains

**Sewerage:** Mains

**Heating:** Gas

(Purchasers are advised to satisfy themselves as to their suitability).

**Broadband type:** See Ofcom link for speed: <https://checker.ofcom.org.uk/>

**Mobile signal/coverage:** See Ofcom link <https://checker.ofcom.org.uk/>

**Local Authority/Tax Band:** South Derbyshire District Council / Tax Band E

**Useful Websites:** [www.gov.uk/government/organisations/environment-agency](http://www.gov.uk/government/organisations/environment-agency)

**Our Ref:** JGA/15042024

The property information provided by John German Estate Agents Ltd is based on enquiries made of the vendor and from information available in the public domain. If there is any point on which you require further clarification, please contact the office and we will be pleased to check the information for you, particularly if contemplating travelling some distance to view the property. Please note if your enquiry is of a legal or structural nature, we advise you to seek advice from a qualified professional in their relevant field.

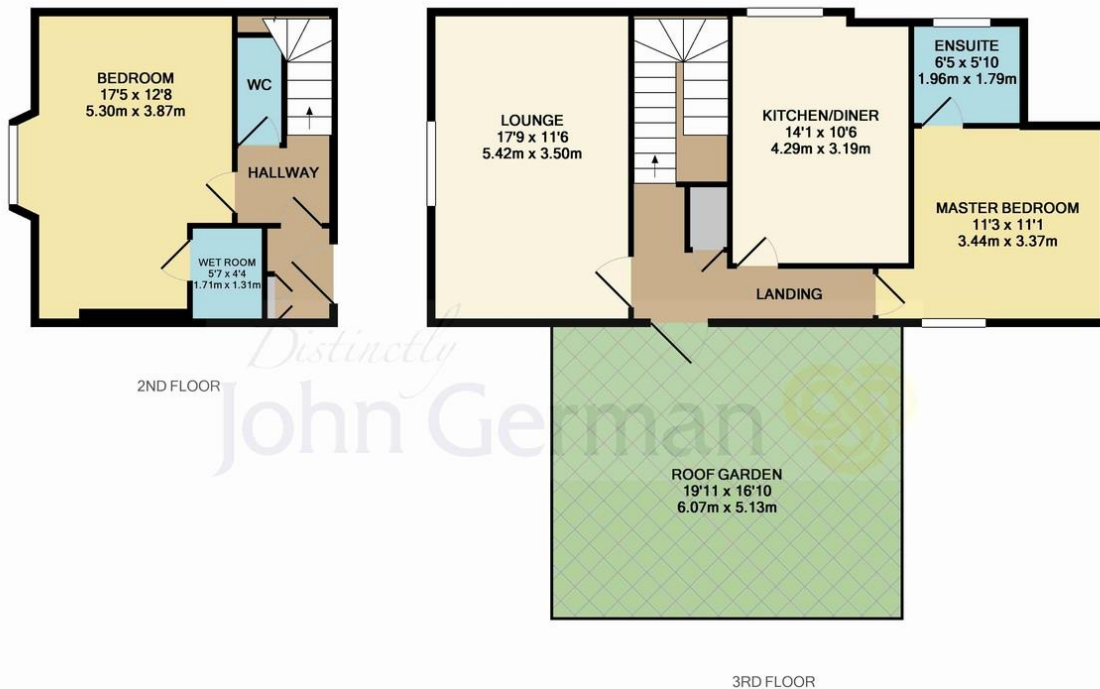

Whilst every attempt has been made to ensure the accuracy of the floor plan contained here, measurements of doors, windows, rooms and any other items are approximate and no responsibility is taken for any error, omission, or mis-statement. This plan is for illustrative purposes only and should be used as such by any prospective purchaser. The services, systems and appliances shown have not been tested and no guarantee as to their operability or efficiency can be given.  
Made with Metropix ©2016





AWAITING EPC MEDIA



John German  
 129 New Street, Burton-On-Trent, Staffordshire, DE14  
 3QW  
 01283 512244  
 burton@johngerman.co.uk

#### Agents' Notes

These particulars do not constitute an offer or a contract neither do they form part of an offer or contract. The vendor does not make or give and Messrs. John German nor any person employed has any authority to make or give any representation or warranty, written or oral, in relation to this property. Whilst we endeavour to make our sales details accurate and reliable, if there is any point which is of particular importance to you, please contact the office and we will be pleased to check the information for you, particularly if contemplating travelling some distance to view the property. None of the services or appliances to the property have been tested and any prospective purchasers should satisfy themselves as to their adequacy prior to committing themselves to purchase.

#### Referral Fees

**Mortgage Services** - We routinely refer all clients to APR Money Limited. It is your decision whether you choose to deal with APR Money Limited. In making that decision, you should know that we receive on average £60 per referral from APR Money Limited.

**Conveyancing Services** - If we refer clients to recommended conveyancers, it is your decision whether you choose to deal with this conveyancer. In making that decision, you should know that we receive on average £150 per referral.

**Survey Services** - If we refer clients to recommended surveyors, it is your decision whether you choose to deal with this surveyor. In making that decision, you should know that we receive up to £90 per referral.

Ashbourne | Ashby de la Zouch | Barton under Needwood  
 Burton upon Trent | Derby | East Leake | Lichfield  
 Loughborough | Stafford | Uttoxeter

**JohnGerman.co.uk** Sales and Lettings Agent