



4 Beech Avenue, Ruislip

Ruislip

£650,000



LAWRENCE RAND

4 Beech Avenue

Ruislip, Ruislip

Two double bedroom extended semi-detached bungalow situated on this quiet residential road in close proximity to Eastcote's multiple shopping and transport facilities.

Council Tax band: E

Tenure: Freehold

EPC Energy Efficiency Rating: D

EPC Environmental Impact Rating: E

- Two double bedrooms
- Semi-detached bungalow
- Extended
- Good condition
- Close to Eastcote amenities
- Off street parking
- Mature private garden





Lr LAWRENCE RAND



Lr LAWRENCE RAND



Lr LAWRENCE RAND



Lr LAWRENCE RAND

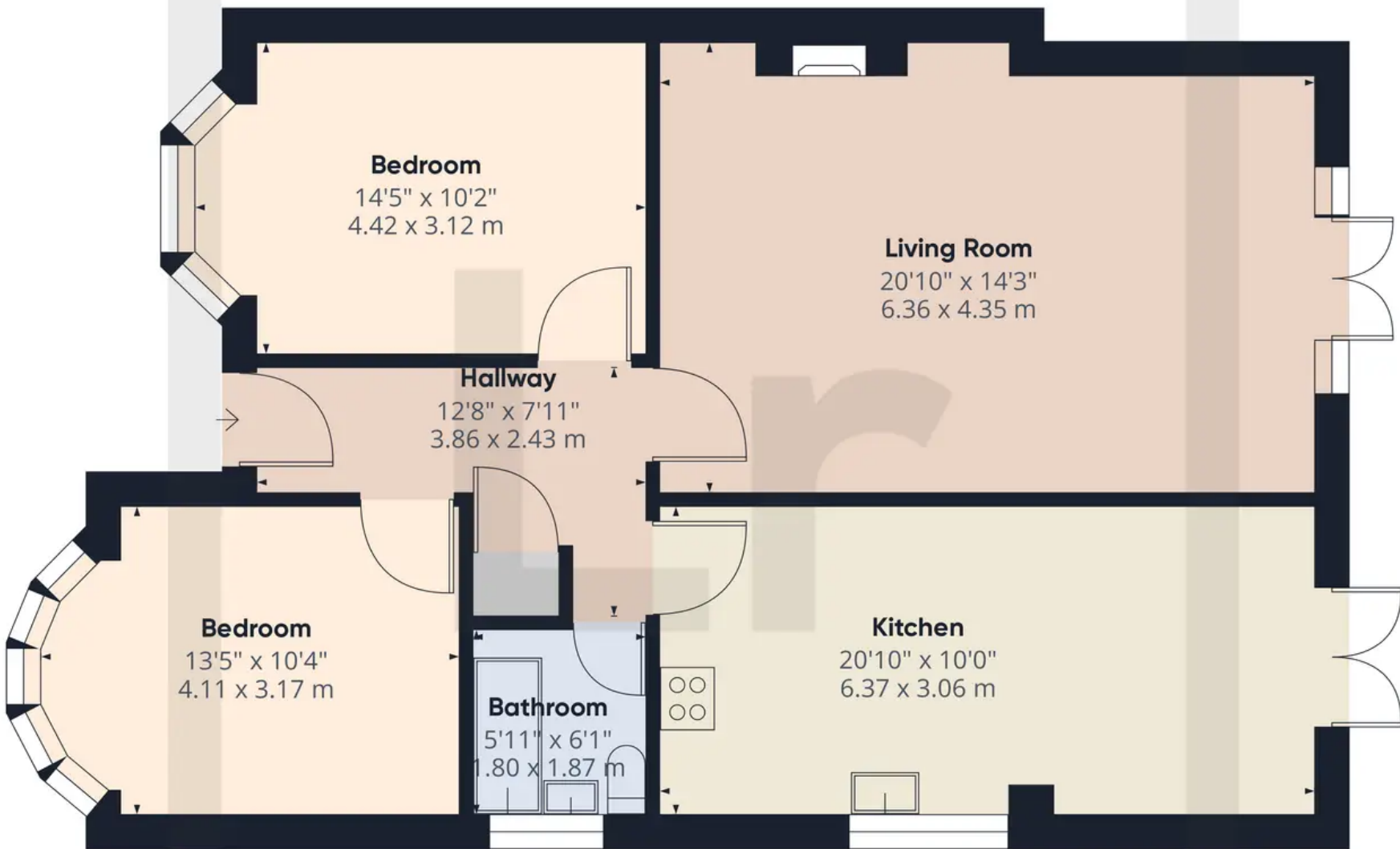

Approximate total area⁽¹⁾
882.47 ft²
81.98 m²

(1) Excluding balconies and terraces

While every attempt has been made to ensure accuracy, all measurements are approximate, not to scale. This floor plan is for illustrative purposes only.



Lawrence Rand

Lawrence Rand, 106 Victoria Road - HA4 0AL

01895 632211

Info@lawrence-rand.co.uk

www.lawrence-rand.co.uk/



LAWRENCE RAND