



 3 Bedrooms Detached Bungalow Offers In Excess Of £385,000
4 Stratton Orchard, Swindon, SN3 4QZ

mcfarlane
property.com

3 Bedrooms Detached

Swindon, Swindon East

- Expansive Detached Bungalow
- Three Bedrooms
- Mature Gardens & Plot

A stunning detached bungalow in an exclusive eastern Swindon location. Positioned toward the head of this Cul-De-Sac this deceptively spacious property offers flexible living accommodation. This property has been updated and a summary of accommodation comprises Entrance Porch, Entrance Hallway, Living Room, Kitchen / Breakfast, Rear Lobby with Utility and Separate Shower Room. Three Bedrooms and Family Bathroom. There is also an Attached Garage and Driveway Parking. There are Mature Gardens to the Side and Rear. Please Note the Loft Space is Expansive could be Converted (subject to building regs). Also, there is uPVC Double Glazing throughout and a new Gas Boiler. Sole Selling Agents McFarlane 01793 751 044





Accommodation
Approx. 136.7 sq. metres (1471.4 sq. feet)

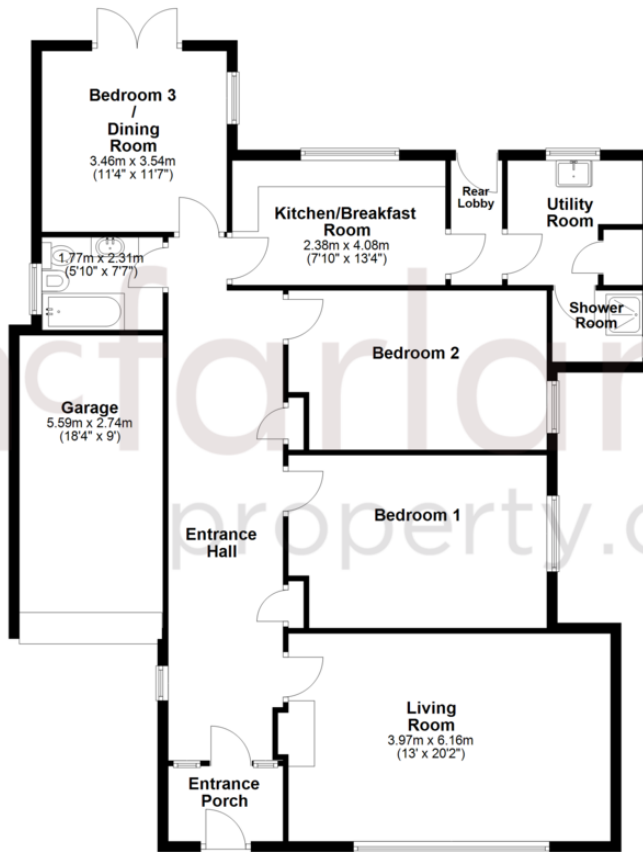

Total area: approx. 136.7 sq. metres (1471.4 sq. feet)

We 
where you
LIVE

Our team are friendly, experienced and are all local. They know it better than they do their own living rooms and can help you find what you're looking for because **we love where we live.**

We would be delighted to show you around this property.

**Because every home
needs a personal touch.**

**If you would like to view this
property then please get in touch.**

☎ 01793 751044

✉ cricklade@mcfarlaneproperty.com

mcfarlaneproperty.com

mcfarlane
property.com

Cricklade.
102 High Street
Cricklade SN6 6AA
☎ 01793 751044

Marlborough.
106 High Street
Marlborough SN8 1LT
☎ 01672 514380

Old Town.
28-30 Wood Street
Swindon SN1 4AB
☎ 01793 296880

Swindon.
The Village Centre,
Redhouse SN25 2FW
☎ 01793 296600

Agents Note: Whilst every care has been taken to prepare these sales particulars, they are for guidance purposes only. All measurements are approximate and are for general guidance purposes only and whilst every care has been taken to ensure their accuracy, they should not be relied upon and potential buyers are advised to recheck the measurements