



MANOR
OXFORD



A one-of-a-kind Woodstock home. Situated in a more secluded part of town, North Cottage is a beautiful detached property set in its own private walled garden. Enjoying views of Blenheim Palace and the lake, it has a garage entrance for two cars and a side entrance into the garden.

A mixture of traditional and contemporary living spaces features a newly fitted luxury kitchen, both a dining area and a living space with bifold doors opening onto the garden, and covered space where there is laundry with a washer and dryer and ample outdoor storage. You will also find a useful office space and WC with cloakroom. Separate underfloor heating is available on this level, as is a large built-in storage room.

There are no steep stairs, and the landing is light and spacious, leading to three bedrooms: two with a recently fitted ensuite and a third with French doors leading out onto the garden terrace, which could also serve as a formal living room. The master suite enjoys a large bay window with a window seat, fitted wardrobes, and a sizeable bathroom with both a bath and a wet room. The whole loft area is floored and is very accessible.

The recently landscaped garden has several seating areas, a small lawn, and is very easily maintained.







- Highly Favourable Location
- Three Bedroom Home
- Private Walled Garden
- Views Of Blenheim Palace
- Garage For Two Cars
- Newly Fitted Luxury Kitchen
- One-of-a-kind Property
- Schools Nearby
- Excellent Transport Links Near
- Soho Farmhouse & Estelle Manor Nearby





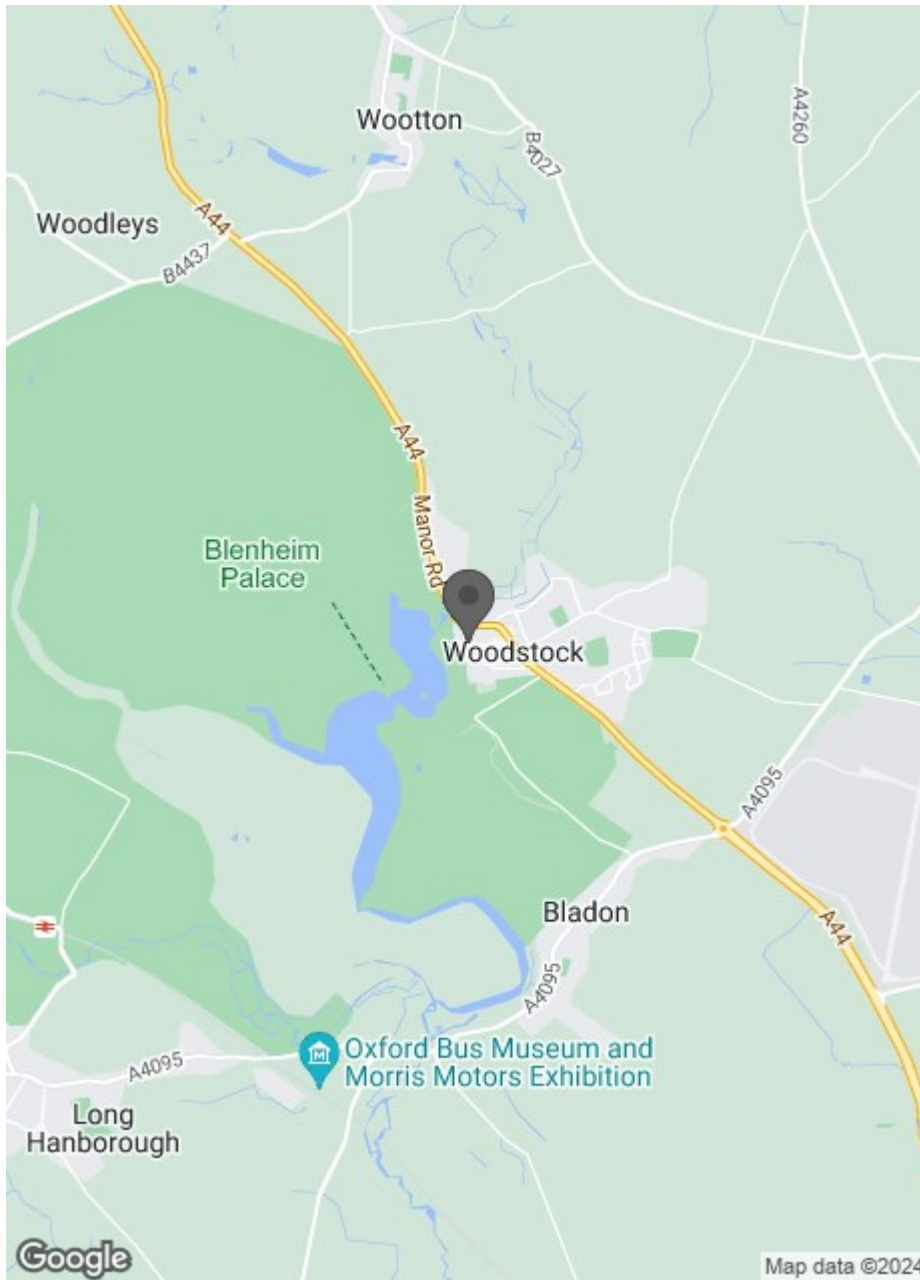

57 Victoria Road
Oxford
OX2 7QF

01865 955500

hello@manoroxford.com

www.manoroxford.com



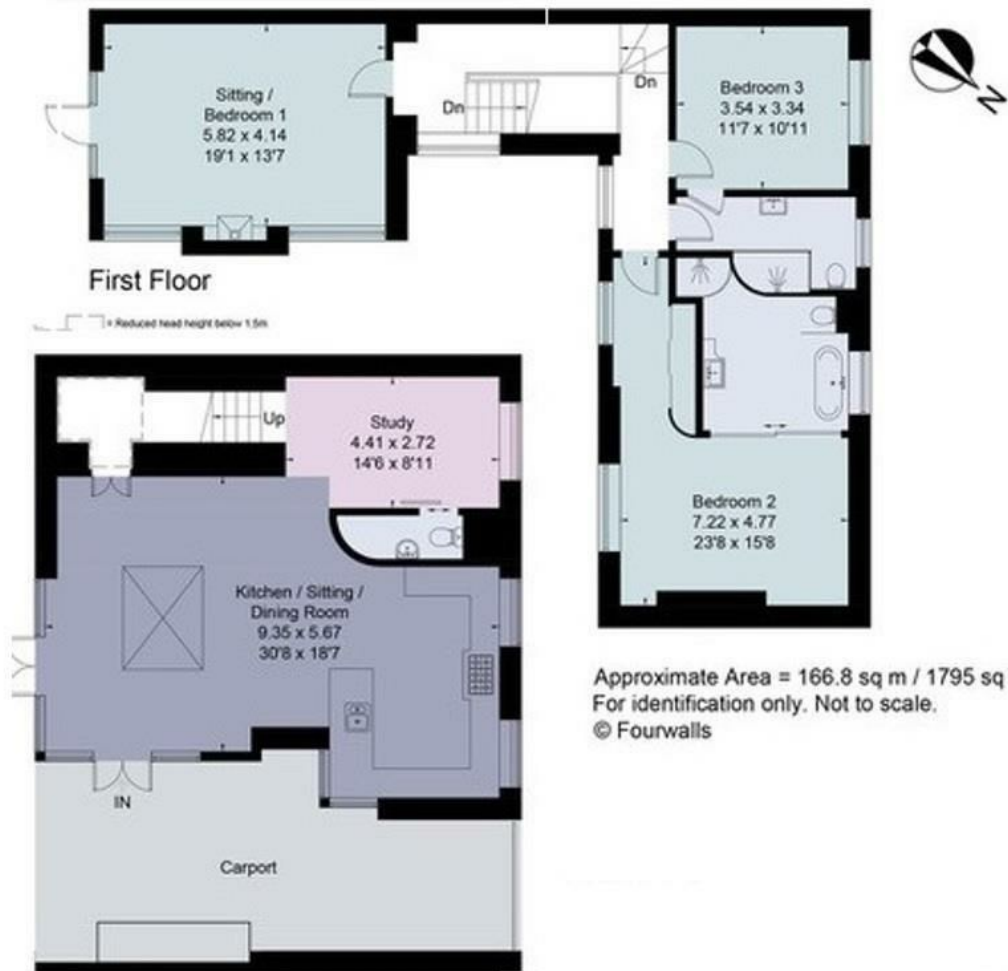

Approximate Area = 166.8 sq m / 1795 sq ft
 For identification only. Not to scale.
 © Fourwalls

Ground Floor

Surveyed and drawn in accordance with the International Property Measurement Standards (IPMS 2: Residential)
 fourwalls-group.com 326473



MANOR
OXFORD