



FOWLERS
ESTATE AGENTS
We'll make you find us home
FOR SALE
01403 786787
www.fowlers.co.uk

17, Coombe Hill | Billingshurst | West Sussex | RH14 9NN





17, Coombe Hill

Billingshurst | West Sussex | RH14 9NN

OFFERS IN EXCESS OF £425,000

A good sized family house situated in an established residential location known for its excellent access to the village High Street, with the schools, leisure centre and railway station just beyond. The accommodation has been extended and has a very good sized kitchen with an opening to a magnificent conservatory with clear glass roof and underfloor heating. The living room has a double aspect and there is a smaller room that makes an ideal study/snug. The ground floor is completed with a shower room/wc, and handy utility cupboard and larder. To the first floor the property was originally designed as a three bedroom property. The second bedroom has been divided to form bedrooms three and four with a stud wall between and could easily be returned to its original design. To the outside the wonderful rear garden has a westerly aspect with several areas of decking and additional seating areas, there is a child's play area, a raised decked area that currently houses a hot tub, and to one corner is an impressive summer house with double opening doors, leading to a seating area with a view down the garden. To the front of the property the property has a substantial gravelled parking area giving parking for at least three vehicles. An additional parking space is located to the rear of the property.



Hall

Tiled floor, covered radiator, turning staircase to first floor with double glazed window, understairs cupboard, double sized recessed cupboard.

Study/Snug

Radiator, wood laminate floor, double glazed window.

Living Room

Double aspect room with double glazed double opening doors leading out to rear garden, contemporary radiator, double glazed window with fitted blind.

Kitchen

(The kitchen is concrete sectional construction with interior insulation).
Worksurface with inset one and half bowl stainless steel sink unit with mixer tap having base cupboards under and integrated dishwasher, several further matching worksurfaces with base cupboards and drawers beneath, integrated fridge, space for cooker with stainless steel splash back and matching stainless steel extractor, range of eye-level cupboards, retractable larder unit, double glazed window with fitted blind, space for large fridge/freezer, contemporary radiator and sliding door leading to:

Utility/Store

Two matching worksurfaces, one having base cupboards under and the other having space and plumbing for washing machine. Plumbing for a tumble dryer over

the washing machine and further shelving, gas fired boiler, double glazed window.

Conservatory (Located off the Kitchen)

This room is a centrepiece of the house and together with the kitchen make a wonderful family area. Predominantly uPVC constructed with double glazed windows, and many fitted blinds, a clear glass roof, under floor heating, double glazed double opening doors leading to the garden.

Shower Room

Tiled shower cubicle with mixer shower, wash hand basin with mixer tap having cupboards under, mirror fronted medicine cabinet, w.c., tiled floor, double glazed window, chrome heated towel rail.

Landing

Double glazed window, access to roof space via pull down loft ladder. The loft space is fully boarded and there is a light.

Bedroom One

Two double glazed windows, radiator.

Bedroom Two

Covered radiator, double glazed window with venetian blind.

Bedroom Three

Double glazed window, covered radiator, fitted shelves.

Bedroom Four

Double glazed window, radiator. (Bedrooms three and four were originally one bedroom and could be returned to one bedroom if required).

Bathroom

Panelled bath with mixer tap, electric mixer shower and glazed shower screen, vanity unit with mixer tap and storage under, w.c., large medicine cabinet, chrome heated towel rail, shaver point, double glazed window with venetian blind.

Drive and Parking

To the front of the property is a substantial gravelled drive providing off the road parking for over three vehicles. Additional parking space is located to the rear of the plot.

Rear Garden

Adjacent the property is a substantial decked area with a gravelled patio to one side. To the middle of the garden is a good sized area of lawn with a further stepping stone path running along the right hand boundary, passing a timber garden store, which leads towards the rear of the garden, where there is a further substantial raised decked area with pergola over and sun awning. To one side of the decking is a child's play area with playing apparatus than can be left if required. There is a covered area that currently houses a hot tub and conversations can be had about it remaining in place should it be of interest.

Summer House

This excellent addition is fully enjoyed by the family with double opening doors giving direct access to a raised seating area. There are two additional double glazed windows, power and light.



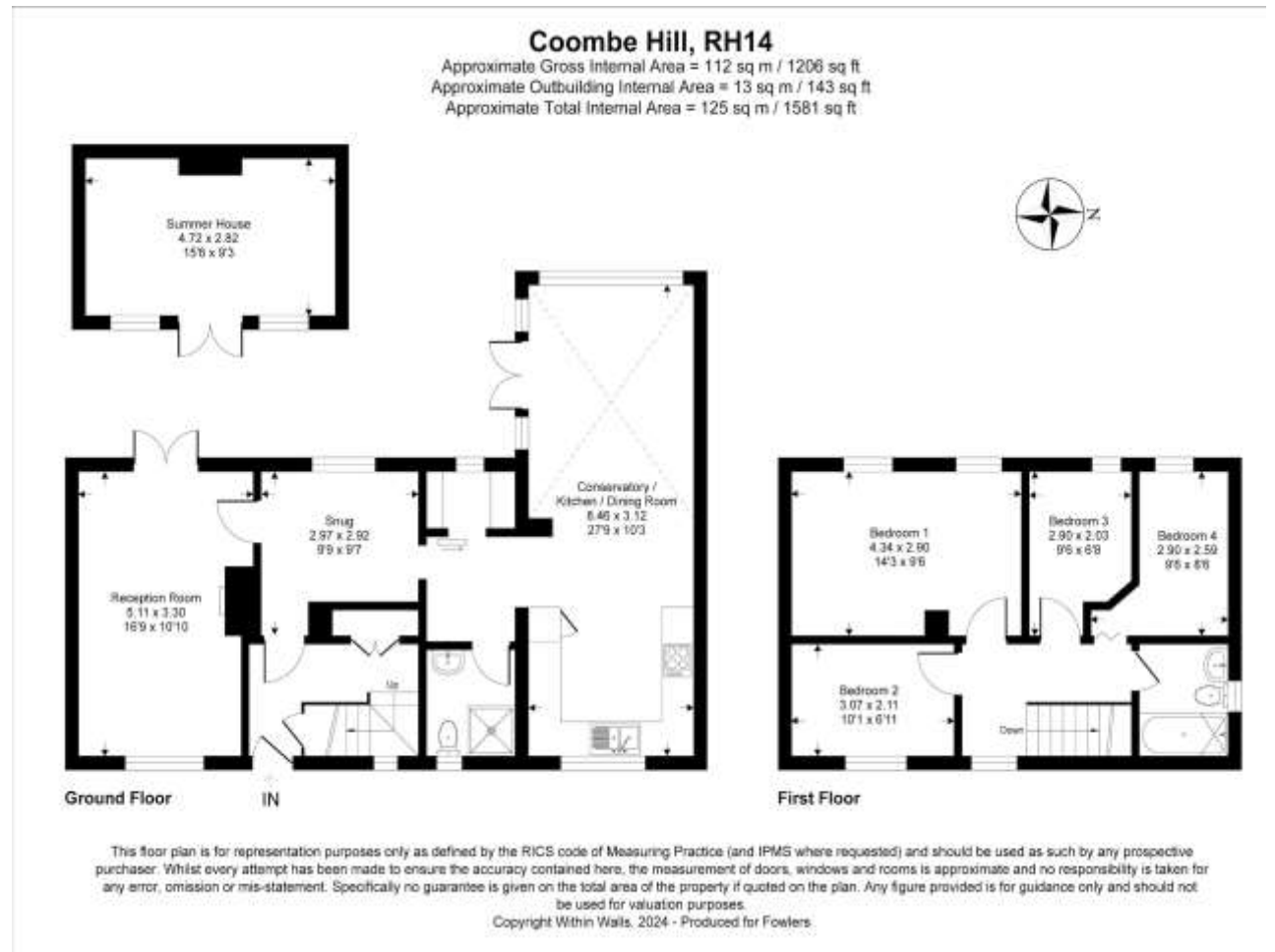

Council Tax Band = C.
EPC Rating = D.



Fowlers 74 High Street, Billingshurst, West Sussex, RH14 9QS www.fowleronline.co.uk billingshurst@fowleronline.co.uk 01403 786787

*"We'll make you
 feel at home..."*



Managing Director:
 Marcel Hoad

Important Notice

1. Fowlers wish to inform all prospective purchasers that these sales particulars do not form part of any contract and have been prepared in good faith to give a fair overall viewing of the property.
2. We have not undertaken a structural survey, nor tested that the services, appliances, equipment or facilities are in good working order.
3. Fowlers cannot verify that any necessary consents have been obtained for conversions, extensions and other alterations such as underpinning, garaging and conservatories etc.

4. Any reference to such alterations is not intended as a statement that any necessary planning or building consents have been obtained and if such details are fundamental to a purchase, then prospective buyers should contact this office for further information or make further enquiries on their own behalf.
4. Any area, boundary, distances or measurements referred to are given as a guide only and should not be relied upon. If such details are fundamental to a purchase, please contact this office for further information.

5. The photographs shown in these details show only certain aspects of the property at the time they were taken. Certain aspects therefore may have changed and it should not be assumed that the property remains precisely as displayed in the photographs.
6. Fowlers cannot verify whether the property and its grounds are subject to any restrictive covenants, rights of way, easements etc, and purchasers are advised to make further enquiries to satisfy themselves on these points.