



2 Bedroom Second Floor Apartment £150,000

Aiken Road, Taw Hill, Swindon, Wiltshire, SN25 1UH

mcfarlane
property.com

2 Bedroom Second Floor Apartment North Swindon

- NO ONWARD CHAIN
- MASTER WITH ENSUITE
- TWO DOUBLE BEDROOMS
- SECOND FLOOR

NO ONWARD CHAIN

This **TWO BEDROOM** apartment is located on the **2ND FLOOR** and in the popular development in **Taw Hill, North Swindon** and comes with an **ALLOCATED PARKING SPACE**. The apartment has a spacious **OPEN PLAN** living/dining room that has plenty of space for a dining room table, The kitchen is modern and with ample storage. The **MASTER BEDROOM** is a great size and has the bonus of built-in wardrobes, whilst the second bedroom is a good size and would make a fantastic guest room or home office. The family bathroom, has a modern white suite. This property would make an ideal purchase for a **FIRST TIME BUYER** or **BUY TO LET** investor.





Council Tax Band C
Council Tax Estimate £1,954
Lease Term Remaining 979

Ground Floor

Approx. 57.5 sq. metres (619.4 sq. feet)

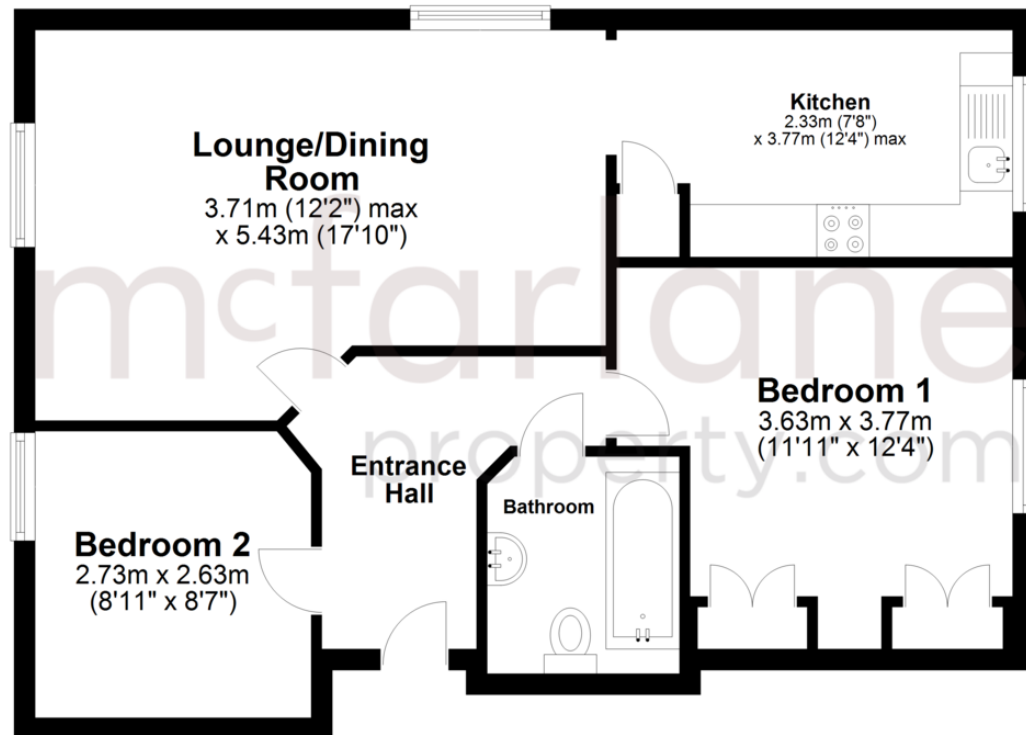

Total area: approx. 57.5 sq. metres (619.4 sq. feet)

We 
where you
LIVE

Our team are friendly, experienced and are all local. They know it better than they do their own living rooms and can help you find what you're looking for because **we love where we live.**

We would be delighted to show you around this property.

**Because every home
needs a personal touch.**

**If you would like to view this
property then please get in touch.**

 01793 296600

 swindon@mcfarlaneproperty.com

mcfarlaneproperty.com

mcfarlane
property.com

Cricklade.

102 High Street
Cricklade SN6 6AA

 01793 751044

Marlborough.

106 High Street
Marlborough SN8 1LT

 01672 514380

Old Town.

28-30 Wood Street
Swindon SN1 4AB

 01793 296880

Swindon.

The Village Centre,
Redhouse SN25 2FW

 01793 296600

Agents Note: Whilst every care has been taken to prepare these sales particulars, they are for guidance purposes only. All measurements are approximate are for general guidance purposes only and whilst every care has been taken to ensure their accuracy, they should not be relied upon and potential buyers are advised to recheck the measurements