



# Falcon & Foxglove

**8 Town House Road, Nelson BB9 9LW**



An extremely well presented three bedroom semi-detached property located close to open countryside. Briefly comprising of three bedrooms, spacious lounge, dining kitchen, utility, downstairs w.c. and first floor family bathroom. The property also benefits from double glazing, gas central heating, private drive, front & rear gardens.

Located near to local shopping facilities, infant/junior schools, and bus routes to the town centre. The property is only a few minutes drive away from access to M65 motorway providing ideal commuting distance throughout the North West.

- **Three Bedrooms**
- **Spacious Lounge**
- **Fitted Kitchen**
- **Utility**
- **Downstairs W.C.**
- **Private Drive**
- **Front & Rear Garden**
- **Freehold**
- **Council Tax Band B**
- **EPC Rating C**

**£159,950**



**Falcon & Foxglove Estate Agents Limited,  
9 Manchester Road, Burnley BB11 1HQ**

Tel: 01282 416060

Email: [info@falconandfoxglove.co.uk](mailto:info@falconandfoxglove.co.uk)

Web: [www.falconandfoxglove.co.uk](http://www.falconandfoxglove.co.uk)



**Entrance Hall**  
1.97m x 1.27m (6ft 5" x 4ft 1")

**Lounge**  
4.36m x 3.94m (14ft 3" x 12ft 11")

Double glazed French doors leading to the rear garden

Feature fireplace with gas burning stove

Carpeted flooring

Central heating radiator



**Falcon & Foxglove Estate Agents Limited,**  
9 Manchester Road, Burnley BB11 1HQ

Tel: 01282 416060

Email: [info@falconandfoxglove.co.uk](mailto:info@falconandfoxglove.co.uk)

Web: [www.falconandfoxglove.co.uk](http://www.falconandfoxglove.co.uk)



### **Kitchen**

**3.78m x 2.45m (12ft 4" x 8ft 0")**

Double glazed window to the front of the property

Fitted wall and base units

Laminate work surfaces

Stainless steel sink unit

Gas cooker

Under stairs storage cupboard

Vinyl flooring

Plumbing for automatic washing machine



### **Utility**

**1.89m x 0.80m (6ft 2" x 2ft 7")**

### **Downstairs W.C.**

**1.50m x 0.80m (4ft 11" x 2ft 7")**

Double glazed frosted window to the rear of the property, Low level w.c., Central heating radiator, Extractor fan



**Falcon & Foxglove Estate Agents Limited,  
9 Manchester Road, Burnley BB11 1HQ**

Tel: 01282 416060

Email: [info@falconandfoxglove.co.uk](mailto:info@falconandfoxglove.co.uk)

Web: [www.falconandfoxglove.co.uk](http://www.falconandfoxglove.co.uk)



### **Landing**

**1.86m x 1.74m (6ft 1" x 5ft 8")**

Double glazed window to the front of the property

Carpeted flooring

### **Bedroom One**

**3.97m x 3.91m (13ft 0" x 12ft 10")**

Double glazed window to the rear of the property

Carpeted flooring

Central heating radiator

Built in storage



### **Bedroom Two**

**3.95m x 2.46m x 12ft 11" x 8ft 0"**

Double glazed window to the rear of the property

Carpeted flooring

Central heating radiator

Built in storage



### **Bedroom Three**

**2.99m x 2.19m (9ft 9" x 7ft 2")**

Double glazed window to the front of the property

Carpeted flooring

Central heating radiator



**Falcon & Foxglove Estate Agents Limited,  
9 Manchester Road, Burnley BB11 1HQ**

Tel: 01282 416060

Email: [info@falconandfoxglove.co.uk](mailto:info@falconandfoxglove.co.uk)

Web: [www.falconandfoxglove.co.uk](http://www.falconandfoxglove.co.uk)



### Bathroom

1.93m x 1.47m (6ft 4" x 4ft 9")

Double glazed frosted window to the front of the property

Panelled bath with thermostatic shower over

Vanity unit with hand wash basin and low level w.c.

Tiled walls and flooring

Central heating radiator



### Rear Garden

Raised decking area

Patio area

Low maintenance



**Falcon & Foxglove Estate Agents Limited,  
9 Manchester Road, Burnley BB11 1HQ**

Tel: 01282 416060

Email: [info@falconandfoxglove.co.uk](mailto:info@falconandfoxglove.co.uk)

Web: [www.falconandfoxglove.co.uk](http://www.falconandfoxglove.co.uk)





**Falcon & Foxglove Estate Agents Limited,  
9 Manchester Road, Burnley BB11 1HQ**

Tel: 01282 416060

Email: [info@falconandfoxglove.co.uk](mailto:info@falconandfoxglove.co.uk)

Web: [www.falconandfoxglove.co.uk](http://www.falconandfoxglove.co.uk)



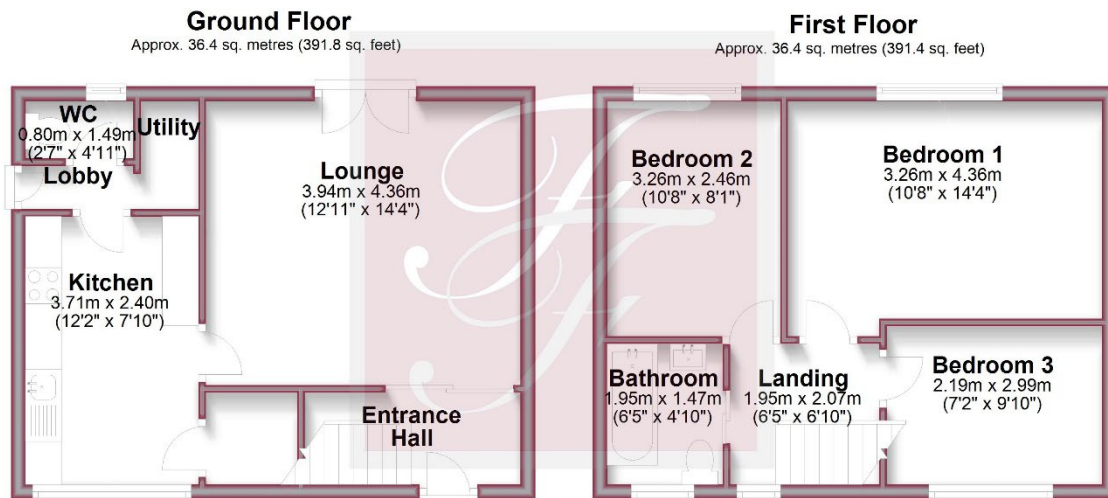

Total area: approx. 72.8 sq. metres (783.2 sq. feet)

Please note: Plans are to show room locations only and are not to scale

#### NOTES:

**VIEWING:** Strictly by appointment with Falcon & Foxglove Estate Agents Limited

#### IMPORTANT NOTICE:

Falcon and Foxglove Estate Agents Limited, their clients and any joint agents give notice that:-

1. They are not authorised to make or give any representations or warranties in relation to the property either here or elsewhere, either on their own behalf or on behalf of their client or otherwise. They assume no responsibility for any statement that may be made in these particulars. These particulars do NOT form part of any offer or contract and must not be relied upon as statements or representations of fact.
2. Any areas, measurements or distances are approximate. The text, photographs and plans are for guidance only and are not necessarily comprehensive. It should not be assumed that the property has all necessary planning, building regulation or other consents and Falcon and Foxglove Estate Agents Limited have not tested any services, equipment or facilities. Purchasers must satisfy themselves by inspection or otherwise.



**Falcon & Foxglove Estate Agents Limited,  
9 Manchester Road, Burnley BB11 1HQ**

Tel: 01282 416060

Email: [info@falconandfoxglove.co.uk](mailto:info@falconandfoxglove.co.uk)

Web: [www.falconandfoxglove.co.uk](http://www.falconandfoxglove.co.uk)

