



A MODERN FIRST FLOOR, TWO BEDROOM MAISONETTE WITH A PRIVATE GARDEN

Chamberlain Way, Pinner, HA5 2AU



Chamberlain Way, Pinner, HA5 2AU

FIRST FLOOR • PRIVATE REAR GARDEN • TWO DOUBLE BEDROOMS • MODERN KITCHEN • RECEPTION ROOM • FAMILY BATHROOM • 900+ YEARS LEASE • PEPPERCORN GROUND RENT • CLOSE TO AMENITIES

Description

A generously proportioned two double bedroom first floor maisonette, benefiting from a private rear garden and a long lease, situated just a short distance from Pinner High Street and Northwood Hills.

This bright and modern home comprises a good-sized reception room, a well-equipped kitchen with an integrated hob & oven, two double bedrooms and a three-piece family bathroom. A private rear garden is set to the rear of the property, and is laid to lawn with a small patio area.





Chamberlain Way is located off Cuckoo Hill, within equal distance of Pinner High Street and Northwood Hills, which both offer a variety of shopping facilities, restaurants, coffee houses and popular supermarkets. In addition, Tesco Supermarket is close by at Pinner Green. For commuters, the Metropolitan Line is accessible at Northwood Hills and Pinner Underground Station, with local bus routes also available.

The area is well served by primary and secondary schooling, with Harlyn Primary School, West Lodge Primary School and Northwood Secondary School all nearby.

Additional Information

Tenure: Leasehold

Lease: 900+ Years

Service Charge: N/A

Ground Rent: £10 pa

Local Authority: London Borough of Hillingdon

Council Tax: Band D

Energy Efficiency Rating: D



Approximate Gross Internal Area
Ground Floor = 31.3 sq m / 337 sq ft
First Floor = 68.7 sq m / 739 sq ft
Total = 100 sq m / 1,076 sq ft

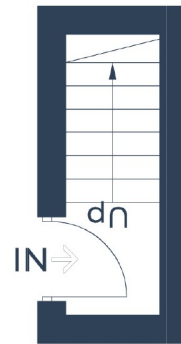

Ground Floor



First Floor

Illustration for identification purposes only,
measurements are approximate, not to scale.
© CJ Property Marketing Produced for Robsons



1 High Street, Pinner HA5 5PJ
Tel: 020 8866 8083 Email: pinner@robsonswb.com
www.robsonswb.com

