

Summary

NO ONWARD CHAIN for this beautiful bungalow in the heart of the popular village of Steeple Bumpstead. Nestled in a peaceful cul-de-sac, & kept in immaculate condition, the property offers two bedrooms, conservatory, private garden, garage & parking.

Description

Approximate Room Sizes

THE PROPERTY Welcome to this exquisite bungalow, nestled in the serene village of Steeple Bumpstead, offering a rare opportunity for tranquil living in a peaceful cul-de-sac setting shared with just three other bungalows.

As you approach, the property exudes charm, with a single garage and driveway providing ample off-road parking, complemented by a neat front garden and a welcoming pathway leading to the front door. Step through the entrance porch into the spacious hallway, where ample storage cupboards and doors to all internal rooms await.

Discover two superb double bedrooms, one

featuring built-in wardrobes, offering comfortable and restful retreats. A beautifully appointed family shower room awaits, boasting elegance and functionality.

The heart of the home lies in the kitchen/breakfast room, showcasing an impressive array of base and eye-level units, complemented by sleek worktops and an inset sink and drainer. Integrated appliances include a double oven, four-ring gas hob, and extractor hood, while space and plumbing are provided for essential appliances, enhancing convenience for modern living.

Adjacent to the kitchen, the lounge beckons with its cosy ambiance, adorned with a beautiful bay window overlooking the front garden. At the rear

of the property, a delightful conservatory awaits, offering versatility as a dining room and seamlessly connecting to both the lounge and kitchen. The conservatory also provides access to the serene rear garden, boasting a high degree of privacy, a paved patio perfect for outdoor relaxation, and lush lawn areas enclosed by fencing. A greenhouse adds charm, while a door into the garage and gated access back to the driveway enhance convenience and functionality.

With its idyllic location, charming features, and thoughtfully designed living spaces, this beautiful bungalow in Steeple Bumpstead offers a serene retreat for those seeking peace and tranquility amidst picturesque surroundings.

ENTRANCE HALL

KITCHEN 12' 9" x 7' 6" (3.89m x 2.31m)

CONSERVATORY

LOUNGE 16' 9" x 10' 5" (5.13m x 3.2m)

BEDROOM 10' 4" x 8' 9" (3.15m x 2.67m)

BEDROOM 10' 9" x 9' 1" (3.3m x 2.77m)

SHOWER ROOM/WETROOM

Additional Information

Local Authority – Braintree District Council

Council Tax Band – D

Tenure – Freehold

Services – All mains services

Post Code – CB9 7ED

Viewings by appointment

Bychoice Estate Agents

Tel: 01440 768919



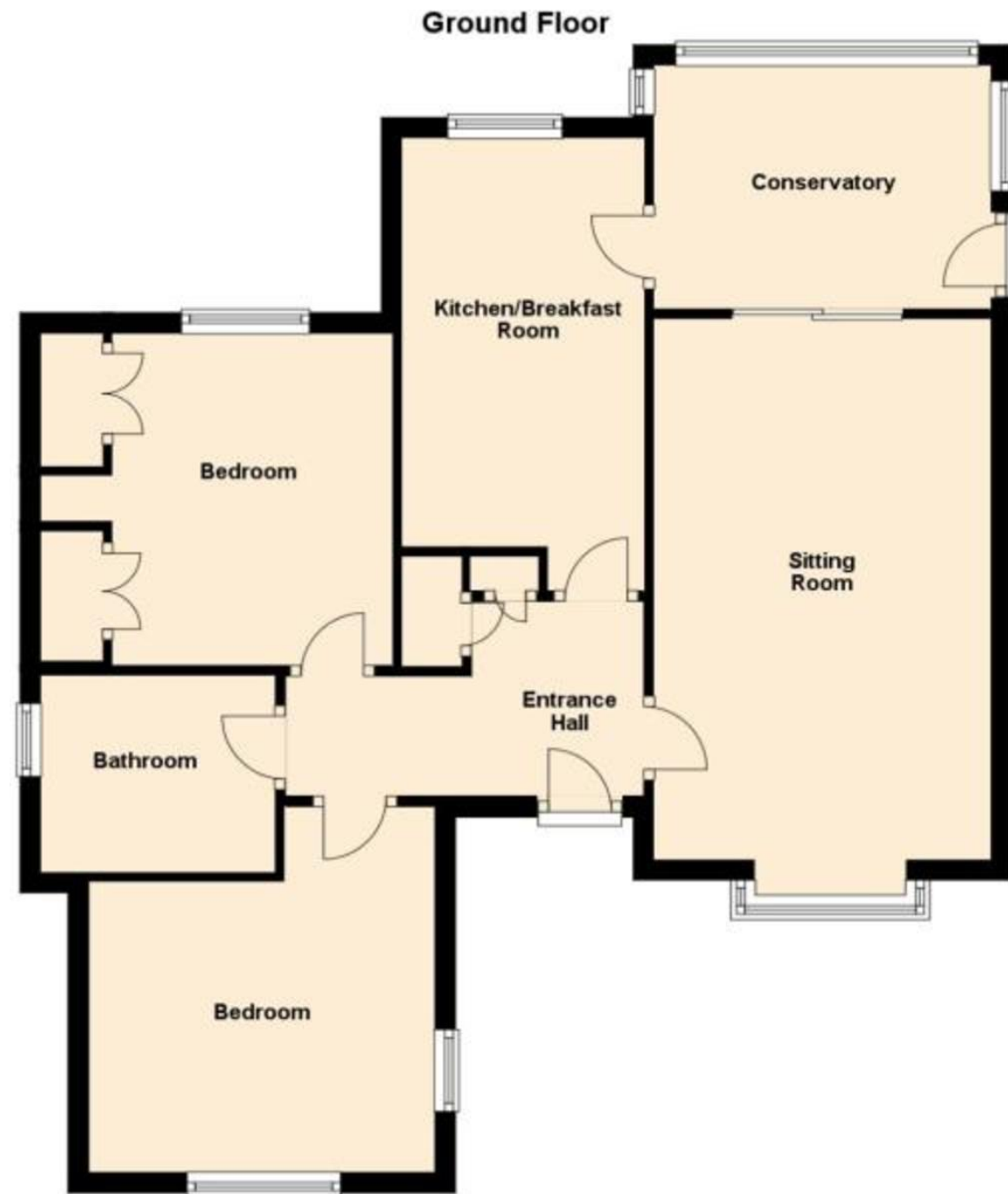

If you would like to speak to one of our mortgage advisors call now – 01440 768919



Your home may be repossessed if you do not keep up repayments on your mortgage.

Contact Details

27b High Street, Haverhill, Suffolk, CB9 8AD

Tel: 01440 768919

Email: haverhill@bychoice.co.uk

Agents Note: Whilst every care has been taken to prepare these sales particulars, they are for guidance purposes only. All measurements are approximate and for general guidance purposes only and whilst every care has been taken to ensure their accuracy, they should not be relied upon and potential buyers are advised to recheck the measurements

Energy Efficiency Rating	
Current	Potential
Very energy efficient - lower running costs	
(92+) A	85
(81-91) B	
(69-80) C	
(55-68) D	
(39-54) E	
(21-38) F	
(1-20) G	
Not energy efficient - higher running costs	
66	
<small>England & Wales</small> EU Directive 2002/91/EC	

Bower Hall Drive | Steeple Bumpstead | CB9 7ED

£339,995

NO ONWARD CHAIN for this beautiful bungalow in the heart of the popular village of Steeple Bumpstead. Nestled in a peaceful cul-de-sac, & kept in immaculate condition, the property offers two bedrooms, conservatory, private garden, garage & parking.

- TWO BEDROOM BUNGALOW
- DETACHED
- POPULAR VILLAGE OF STEEPLE BUMPSTEAD
- PEACEFUL CUL-DE-SAC
- IMMACULATE CONDITION THROUGHOUT
- WALKING DISTANCE TO VILLAGE AMENITIES
- GARAGE & DRIVEWAY