



## Glenton Way, Rise Park, Romford

£1,950 pcm Freehold

THREE BEDROOM SEMI-DETACHED HOUSE • OFF STREET PARKING AND GARAGE • MODERN KITCHEN AND BATHROOM • SPACIOUS ACCOMMODATION • GARDEN WITH PATIO • EPC RATING - D • TENANCY DEPOSIT - £2250.00



Presenting this well maintained THREE BEDROOM SEMI-DETACHED HOUSE in the popular Rise Park area of Romford. This family home features a large through lounge, modern kitchen and bathroom and three good sized bedrooms and is convenient for local schools, shops and bus stops.

Council Tax Band - D

EPC Rating - D

Tenancy Deposit - £2250.00

Council Tax band: D

Tenure: Freehold

EPC Energy Efficiency Rating: D

EPC Environmental Impact Rating: E



**Lounge**

13' 2" x 11' 1" (4.02m x 3.38m)

**Dining Area**

11' 3" x 9' 11" (3.42m x 3.01m)

**Kitchen**

11' 2" x 9' 11" (3.41m x 3.01m)

**Bedroom One**

13' 1" x 10' 4" (3.98m x 3.16m)

**Bedroom Two**

11' 5" x 10' 6" (3.49m x 3.21m)

**Bedroom Three**

6' 8" x 6' 5" (2.04m x 1.95m)

**Bathroom**

3' 11" x 6' 4" (1.20m x 1.93m)



Approx Gross Internal Area  
81 sq m / 873 sq ft

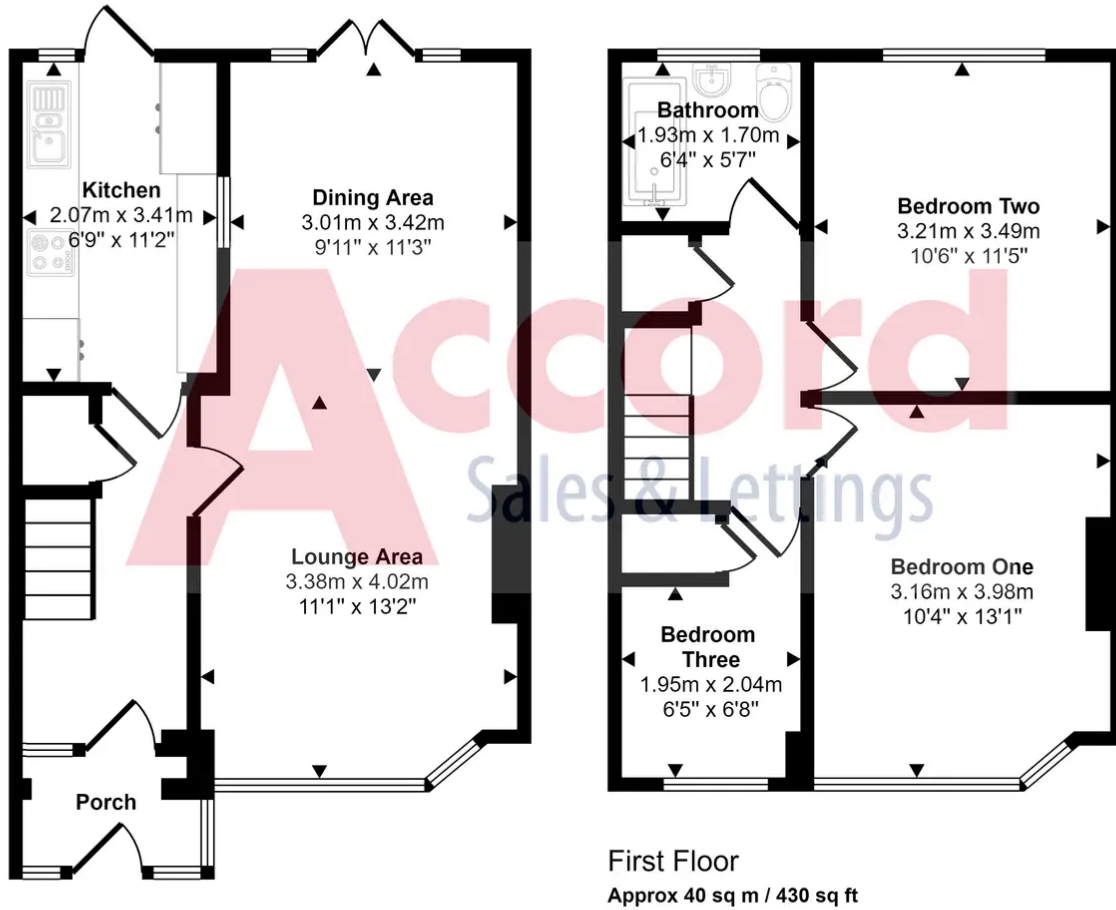

Ground Floor  
Approx 41 sq m / 443 sq ft

This floorplan is only for illustrative purposes and is not to scale. Measurements of rooms, doors, windows, and any items are approximate and no responsibility is taken for any error, omission or mis-statement. Icons of items such as bathroom suites are representations only and may not look like the real items. Made with Made Snappy 360.