



## 26 Aldous Way | Kiveton | Sheffield | S26 6SH

£190,000

Bell & Co Estates are delighted to present this Three Bedroom End Town House situated on a quiet cul-de-sac position in the popular area of Kiveton Park. In brief the property comprises of Entrance Hallway with downstairs WC and wash basin, spacious open Lounge flowing into the Kitchen Diner with understairs storage cupboard, plenty of cupboard and worktop space with some integrated appliances. To the rear of the property is a bright and airy Conservatory with patio doors opening onto the rear garden. Upstairs are TWO DOUBLE BEDROOMS, master bedroom complete with En-Suite, and a further single Bedroom as well as the family Bathroom complete with Bath, wash basin and WC. To the front of the property the driveway provides off road parking for two vehicles and a walk way to the side with gate access leads to a low maintenance rear garden. Close to all local amenities, transport links and schools this home is in a prime location.

- Three Bedroom End Town House
- Perfect First Time Buyers Home
- Spacious Throughout
- Downstairs WC
- Open Lounge
- Kitchen with Dining Area
- Private Enclosed Garden



GROUND FLOOR  
576 sq.ft. (53.5 sq.m.) approx.

1ST FLOOR  
388 sq.ft. (36.0 sq.m.) approx.

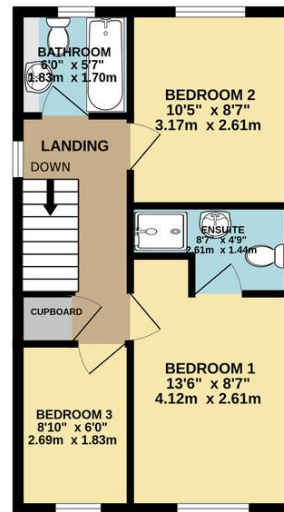
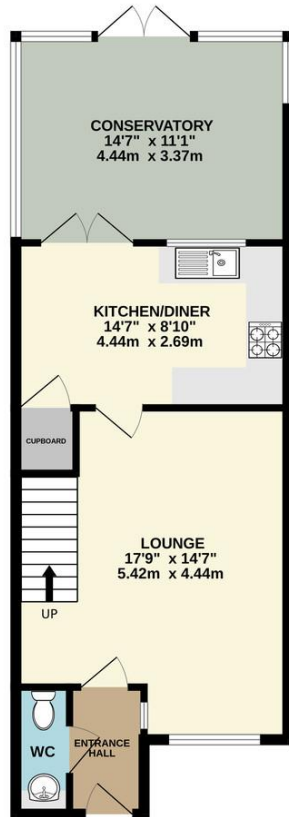

## Contact Details

79 Wales Road  
Kiveton Park  
Sheffield  
South Yorkshire  
S26 6RA

[www.bellcoestates.com](http://www.bellcoestates.com)

03333 580590

26, Aldous Way  
Kiveton Park  
SHEFFIELD  
S26 6SH

Energy rating

C

Valid until  
**25 March 2030**

Certificate number  
**0674-2810-6273-2120-6655**

**Property type** end-terrace house

**Total floor area** 73 square metres

Agents Note: Whilst every care has been taken to prepare these sales particulars, they are for guidance purposes only. All measurements are approximate and for general guidance purposes only and whilst every care has been taken to ensure their accuracy, they should not be relied upon and potential buyers are advised to recheck the measurements