

The Fulham

2 bedroom home



The Fulham

Plots 437, 438, 501, 503 & 505 – as shown
 Plots 436, 500, 502 & 504 – handed

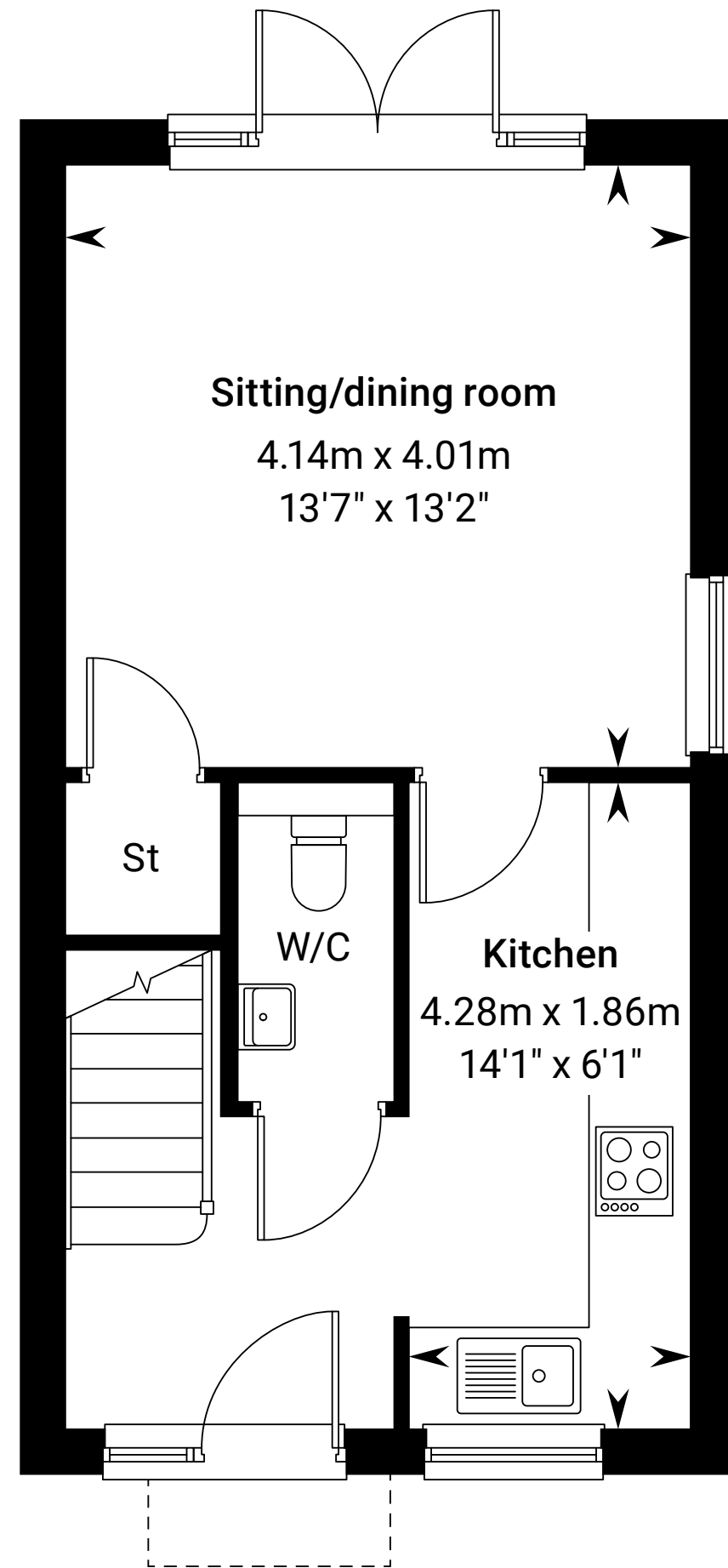
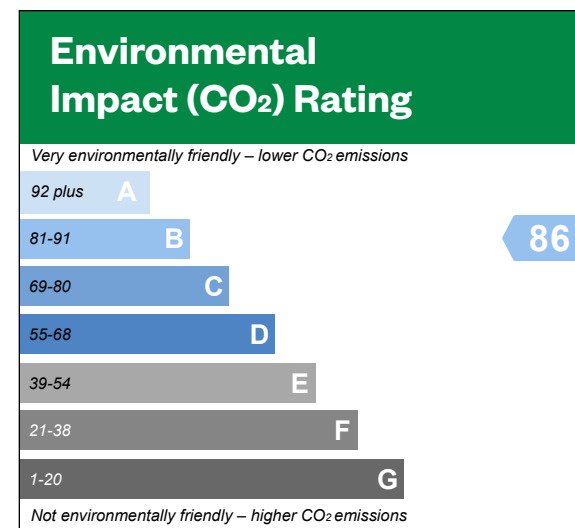
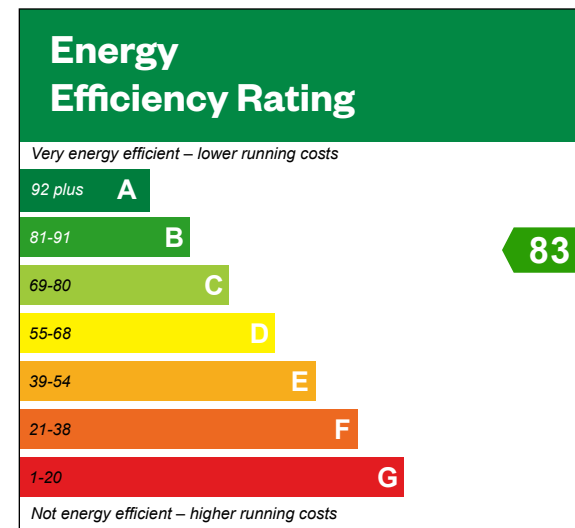

* Window to plots 501, 504 & 505 only.

Ground floor

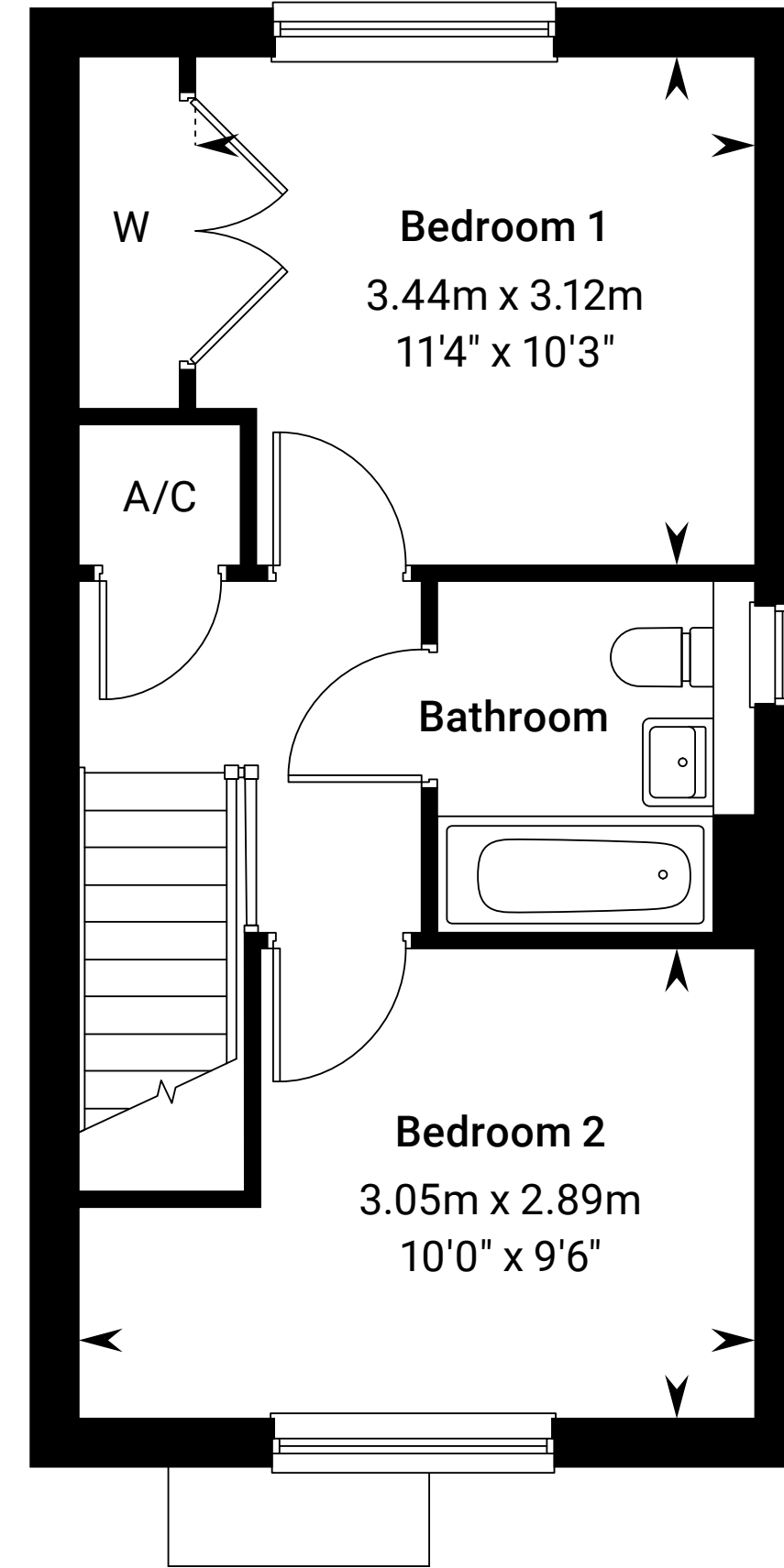

* Window to Plots 501, 504, 505 only.

First floor

*Window to plots 501, 504 & 505 only. Plots 436, 437 & 438 are terraced plots. Please ask your Sales Consultant for further details. A/C: Airing cupboard. St: Store cupboard. W: Wardrobe.

The Consumer Protection from Unfair Trading Regulations 2008. Legal & General Homes operates a policy of continual product development and the specifications outlined in this brochure are indicative only. Information contained is accurate at date of publication on 09.04.2024. See the main brochure for the full Consumer Protection statement. Predicted Energy Assessment for properties that are incomplete. Once the property is completed, this rating will be updated and an official Energy Performance Certificate will be created for the property.