



118 Curran Crescent, Broxburn

Offers Over £108,000



118 Curran Crescent

Broxburn, Broxburn

Nestled at the end of a quite no-through road, this delightful Main Door Upper Flat offers a unique opportunity for both first-time buyers and investors alike. The fully enclosed private south-facing garden is a true gem.

Council Tax band: A

Tenure: Freehold

- Main Door Upper Villa
- Spacious Lounge/Dining Room
- One Bedroom With Fitted Wardrobes
- Ideal starter home
- Fully Enclosed Private South Facing Garden
- Quiet Location At End Of No Through Road
- Buy to let opportunity
- Abundance Of Storage
- Ample On Street Parking
- Walking Distance Of Local Amenities



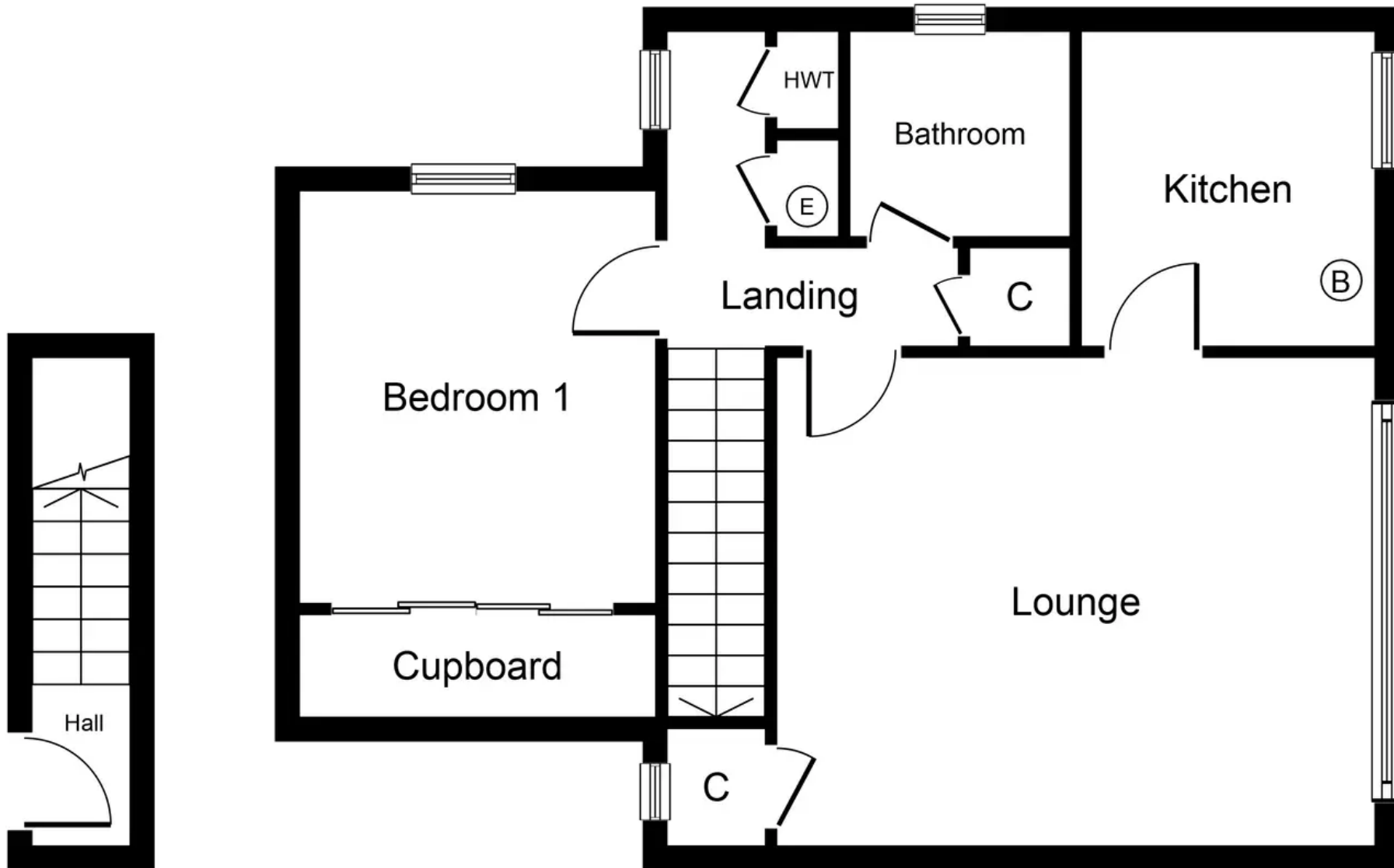

Ground Floor
Approximate Floor Area
35 sq. ft.
(3.2 sq. m.)

First Floor
Approximate Floor Area
559 sq. ft.
(51.9 sq. m.)

Whilst every attempt has been made to ensure the accuracy of the floor plan contained here, measurements of doors, windows, rooms and any other items are approximate and no responsibility is taken for any error, omission, or mis-statement. The measurements should not be relied upon for valuation, transaction and/or funding purposes. This plan is for illustrative purposes only and should be used as such by any prospective purchaser or tenant. The services, systems and appliances shown have not been tested and no guarantee as to their operability or efficiency can be given.



KnightBain Estate Agents

Knightbain, 4 Greendykes Road, Broxburn - EH52 5AG

01506 852000

info@knightbain.co.uk

www.knightbain.co.uk/

