

GROUND FLOOR

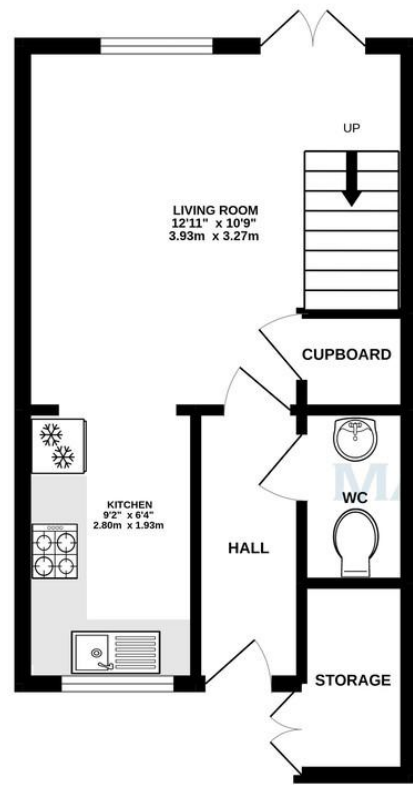

1ST FLOOR

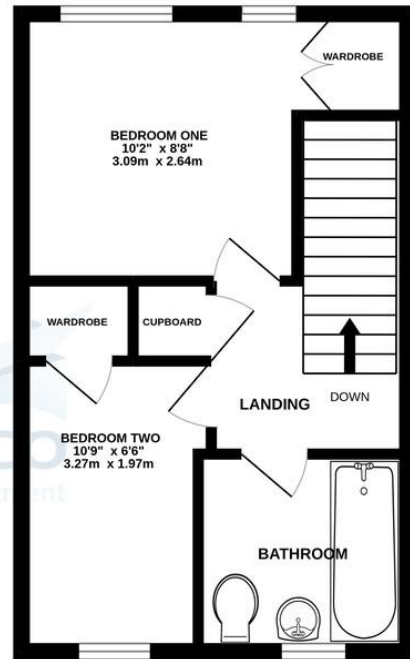

Whilst every attempt has been made to ensure the accuracy of the floorplan contained here, measurements of doors, windows, rooms and any other items are approximate and no responsibility is taken for any error, omission or mis-statement. This plan is for illustrative purposes only and should be used as such by any prospective purchaser. The services, systems and appliances shown have not been tested and no guarantee as to their operability or efficiency can be given.
Made with Metropix ©2022

TO LET



Martin & Co Basingstoke

26 London Street • Basingstoke • RG21 7PG
T: 01256-859960 • E: basingstoke@martinco.com

01256-859960

<http://www.martinco.com>



Accuracy: References to the Tenure of a Property are based on information supplied by the Seller. The Agent has not had sight of the title documents. A Buyer is advised to obtain verification from their Solicitor. Items shown in photographs including but not limited to carpets, fixtures and fittings are not included unless specifically mentioned within the sales particulars. They may however be available by separate negotiation. Buyers must check the availability of any property and make an appointment to view before embarking on any journey to see a property. No person in the employment of the agent has any authority to make any representation about the property, and accordingly any information given is entirely without responsibility on the part of the agents, sellers(s) or lessors(s). Any property particulars are not an offer or contract, nor for part of one. **Sonic / Laser Tape:** Measurements taken using a sonic / laser tape measure may be subject to a small margin of error. **All Measurements:** All Measurements are Approximate. **Services Not tested:** The Agent has not tested any apparatus, equipment, fixtures and fittings or services and so cannot verify that they are in working order or fit for the purpose. A Buyer is advised to obtain verification from their Solicitor or Surveyor.



Basswood Drive, Basingstoke, RG24 9SW

2 Bedrooms, 1 Bathroom, Terraced House

£1,200 pcm





Limes Park

Terraced House,
2 bedroom, 1 bathroom

£1,200 pcm

Date available: 27th July 2024

Deposit: £1,384

Unfurnished

Council Tax band: C

- Two Bedroom House
- Downstairs Cloakroom
- Enclosed Garden
- Parking for 1 Car
- Gas Central Heating
- New Carpets to be Fitted
- New Flooring (where there are no carpets)

New carpets will be fitted and the property will be fully redecorated before you move in. This two-bedroom terraced house is conveniently located close to the hospital. The property features a downstairs cloakroom, a modern kitchen and bathroom, double glazing, gas central heating, an enclosed garden, and driveway parking for one car.

Viewings Saturday 8th June 1500 to 1630

DOOR TO

ENTRANCE HALL Radiator and laminate flooring

CLOAKROOM Low-level WC, wash hand basin, vinyl floor and radiator.

LIVING ROOM 12' 10" x 10' 8" (3.93m x 3.27m) Rear aspect window, under stairs storage cupboard, door to

| Score | Energy rating | Current | Potential |
|-------|---------------|---------|-----------|
| 92+ | A | | 92 A |
| 81-91 | B | | |
| 69-80 | C | 78 c | |
| 55-68 | D | | |
| 39-54 | E | | |
| 21-38 | F | | |
| 1-20 | G | | |



the garden, stairs to the landing and arch to the kitchen.

KITCHEN 9' 2" x 6' 4" (2.80m x 1.93m) Front aspect window, a range of eye and base level storage units with rolled edge work surfaces, integrated oven, four ring gas hob with extractor hood over, fridge/freezer, washing machine, laminate floor and radiator.

LANDING Carpet, radiator, storage cupboard and loft access.

BEDROOM 1 10' 2" x 8' 8" (3.09m x 2.64m) Rear aspect window, wardrobe, carpet and radiator.

BEDROOM 2 10' 9" x 6' 6" (3.27m x 1.97m) Front and side aspect windows, wardrobe, carpet and radiator.

BATHROOM Front aspect window, bath with shower over, low-level WC, wash hand basin, radiator and vinyl floor.

OUTSIDE To the rear of the property, there is a small garden, mostly laid to lawn.

To the front of the property there is driveway parking.

APPLICATIONS A holding deposit equivalent to 1 weeks rent will be required to reserve the property while referencing checks are being carried out. With the

tenants' consent this holding deposit will be refunded against the first month's rent. The holding deposit can be retained if the applicant provides false or misleading information, fails Right to Rent checks, withdraws from the property or fails to take reasonable steps to enter into the tenancy.

In accordance with the Tenant Fees Act applicants will be required to enter into the tenancy agreement no more than 15 days after paying the holding deposit. Failure to do so for any of the afore mentioned reasons may result in you losing your holding deposit. An extension to the deadline may be entered into if agreed in writing by all parties.

Right to Rent Checks

By law, Right to Rent checks must be carried and as such will be required to provide proof of ID and address in accordance with Home Office guidelines. More information can be found at: https://assets.publishing.service.gov.uk/government/uploads/system/uploads/attachment_data/file/573057/6_1193_HO_NH_Right-to-Rent-Guidance.pdf

Reference Checks and Credit Worthiness

All applicants will be subject to a credit check carried out by a 3rd party to check for CCJs and IVAs Applicants will need to provide proof of an income of at least 2.5 x annual rent.

We will also carry out employment checks, affordability checks, previous landlord reference and proof of address history, usually up to 3 years.

Documentation that will be required

Passport, driving licence, utility bill dated in the last 3 months (for proof of address) and payslips

MATERIAL INFORMATION Council Tax Band: D

EPC D Tenancy Term: 12 Months

Rent: £1200 per month

Deposit: £1384 UNFURNISHED

Sorry due to new carpets being fitted the landlord is not looking to consider pets

