

Crucible Homes



Peak Close
Sunnyside, S66 3XD

Guide Price
£100,000

Overview

One Bedroom

Open Plan Living

Master Bedroom With Fitted Robes

Modern Bathroom

Integral Garage

EPC Rating - C



Description

£100,000 to £110,000 (Guide Price)

SUMMARY Welcome to this ONE bedroom FIRST floor APARTMENT on the sought after estate within Woodlathes Village.

This property is perfect for FIRST TIME BUYERS or INVESTORS.

On approach to the apartment you will see an integral garage which benefits from electrics and lighting, so also ideal for storage.

Entry to the property there are stairs leading to the first floor living accommodation.

From the landing you lead into the open plan living, which comprises of; kitchen, dining area and lounge. Starting with the kitchen, this is fitted with white modern wall and base units and integral appliances which include oven, hob with extractor fan over.

Into the main living area this is well proportioned room, having two front facing windows and space that would accommodate a dining table.



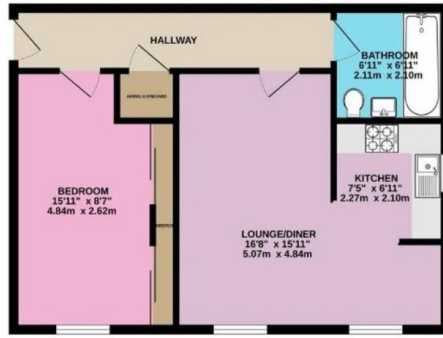

| Score | Energy rating | Current | Potential |
|-------|---------------|---------|-----------|
| 92+ | A | | |
| 81-91 | B | | |
| 69-80 | C | 69 C | 75 C |
| 55-68 | D | | |
| 39-54 | E | | |
| 21-38 | F | | |
| 1-20 | G | | |

The master bedroom benefits from having fitted wardrobes, providing ample storage. Front facing UPVC window and electric heater.

The modern bathroom is at the head of the landing which is fully tiled and fitted with a white suite comprising of bath with shower over, low flush WC and vanity wash hand basin.

Where this property is situated it benefits from being a short drive away from the motorway links and local amenities which include;

ENTRANCE HALL

OPEN PLAN LIVING 16' 7" x 15' 10" (5.07m x 4.84m)

KITCHEN 7' 5" x 6' 10" (2.27m x 2.10m)

BEDROOM 15' 10" x 8' 7" (4.84m x 2.62m)

BATHROOM 6' 11" x 6' 10" (2.11m x 2.10m)

AGENCY NOTE EPC Rating - C

Council Tax Band - A

