

35 Hopkinson Court,  
Chester

£190,000

CURRANS  
*homes*



CHAIN FREE! A well presented two bedroom apartment forming part of the prestigious Minerva Development. The property offers both style and practicality, making it a great option for anyone seeking a comfortable and contemporary living space in a sophisticated location just outside of the city walls. In brief, the property comprises an open plan lounge and dining area, kitchen, two double bedrooms with the master bedroom benefiting from ensuite shower room. The inclusion of double glazing and gas central heating ensures comfort and energy efficiency year-round. With one allocated parking space, convenience extends beyond the apartment itself.

#### FINER POINTS

- \* No onward chain
- \* Great location just a stones throw from Chester City Centre and the famous Chester Races
- \* Two double bedrooms
- \* Ensuite shower room and bathroom
- \* Allocated parking





These particulars are intended to give a fair and substantially correct overall description for the guidance of intending purchasers and do not constitute an offer or part of a contract. Prospective purchasers ought to seek their own professional advice. All descriptions, dimensions, areas, reference to condition and necessary permissions for use and occupation and other details are given in good faith and are believed to be correct, but any intending purchasers should not rely on them as statements or representations of fact, but must satisfy themselves by inspection or otherwise as to the correctness of each of them. All measurements are approximate.

**Tenure:** Freehold

**Local Authority:**

**Council Tax:** Band

**Viewings:** By appointment only

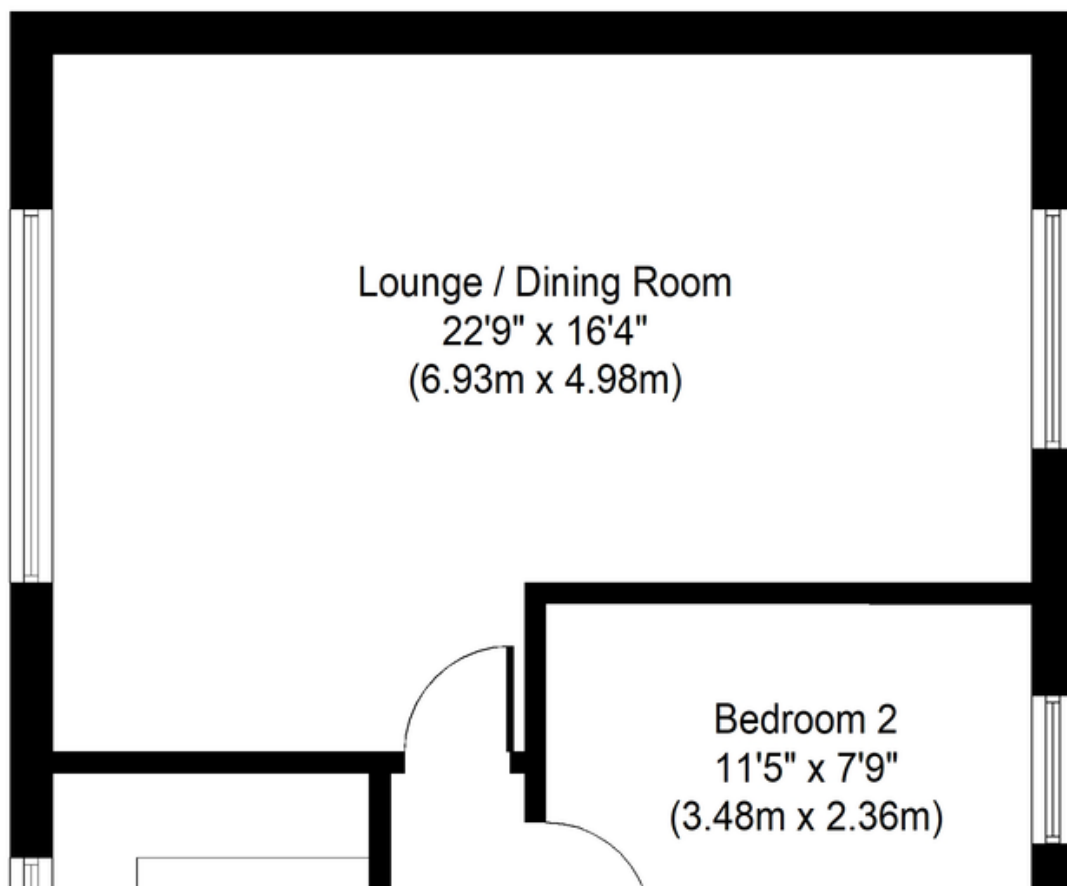

**Office Address**

11 Grosvenor Street  
Chester, Cheshire  
CH1 2DD

**01244 313900**

**sales@curranshomes.co.uk**

CURRANS  
*homes*