



mcFarlane  
property.com



Stone Built Family Home

High Road, Ashton Keynes, Wiltshire, SN6 6NX

£ P.O.A. (price on application)

mcFarlane  
property.com

## Generous Plot and Cottage

### Ashton Keynes, Wiltshire

- Sought After Ashton Keynes Position
- Three Bedroom Stone Built Home
- Generous Plot with Potential

A Stone Built Three Bedroom home in a much sought after position within the sought after Village of Ashton Keynes. This purpose-built property offers potential for extension and improvement (subject to planning) plus having grounds to three elevations. In all the plot is believed to be in the region of 0.13 Acres. The accommodation briefly comprises: Entrance Porch, Entrance Hallway, Living Room, Dining Room, Kitchen / Breakfast Room, and lobby to the Side Elevation. To the First Floor Three Bedrooms and Family Bathroom. Access to the property is via a five-bar gate with expansive driveway and parking for several cars. The Gardens are Mature and to Three Elevations. uPVC Double Glazing, Oil Fired Central Heating and Mains Drainage.



No Chain

Viewings by Appointment only

McFarlane Sales & Lettings

36 High Street  
Cricklade  
Wiltshire  
SN6 6AY

(01793) 751 044



mcFarlane  
property.com



We   
where you  
**LIVE**

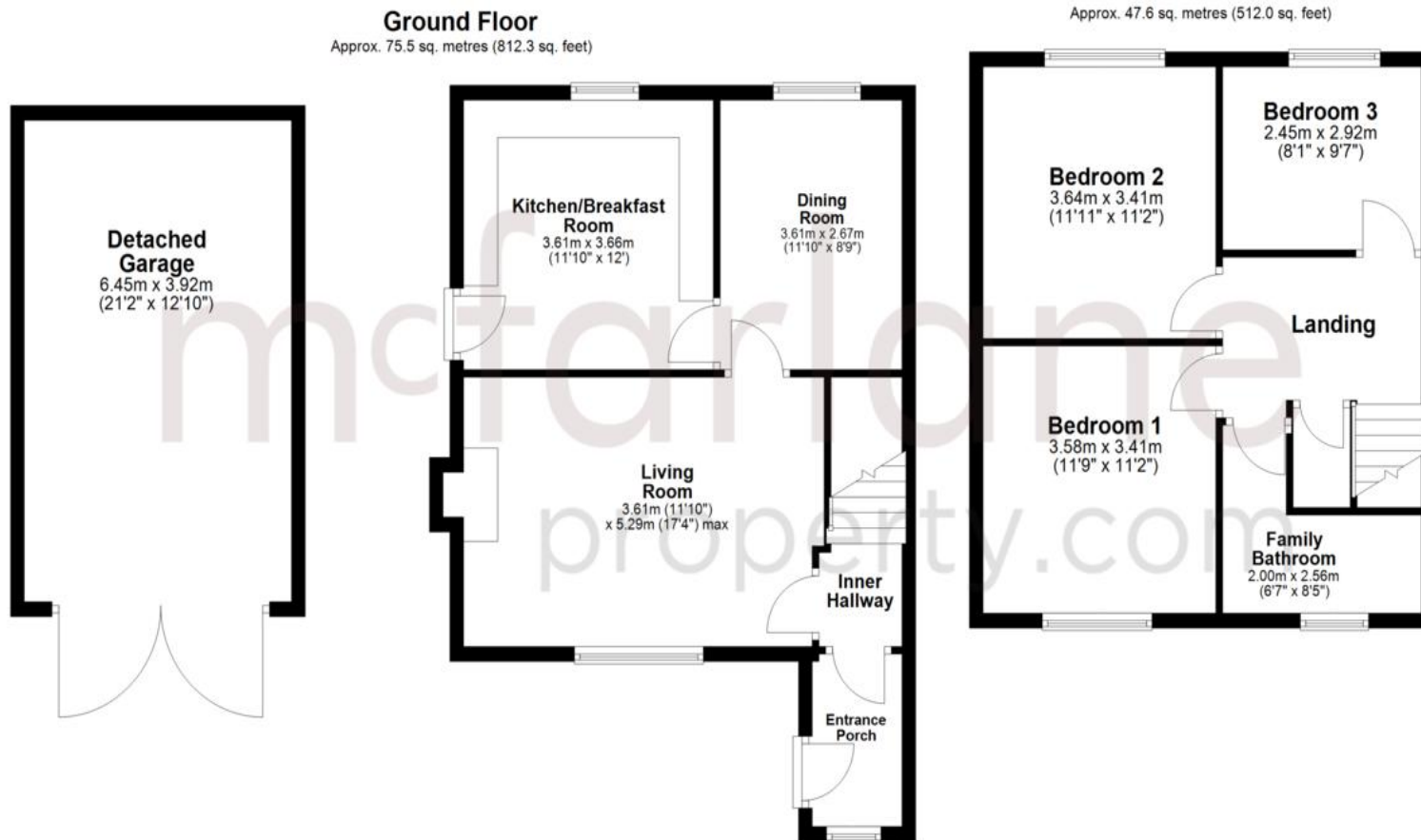

Total area: approx. 123.0 sq. metres (1324.3 sq. feet)

Our team are friendly, experienced and are all local. They know it better than they do their own living rooms and can help you find what you're looking for because **we love where we live.**

We would be delighted to show you around this property.

**Because every home needs a personal touch.**

**If you would like to view this property then please get in touch.**

📞 01793 751044

✉ [cricklade@mcfarlaneproperty.com](mailto:cricklade@mcfarlaneproperty.com)

[mcfarlaneproperty.com](http://mcfarlaneproperty.com)

**mcfarlane**  
property.com

**Cricklade.**  
102 High Street  
Cricklade SN6 6AA  
📞 01793 751044

**Marlborough.**  
106 High Street  
Marlborough SN8 1LT  
📞 01672 514380

**Old Town.**  
28-30 Wood Street  
Swindon SN1 4AB  
📞 01793 296880

**Swindon.**  
The Village Centre,  
Redhouse SN25 2FW  
📞 01793 296600

Agents Note: Whilst every care has been taken to prepare these sales particulars, they are for guidance purposes only. All measurements are approximate are for general guidance purposes only and whilst every care has been taken to ensure their accuracy, they should not be relied upon and potential buyers are advised to recheck the measurements