

77 West Grove

Woodford Green, Essex

Offers Over £450,000

Council Tax band: D

Tenure: Freehold

- CHAIN FREE
- SHORT WALK TO TUBE STATION
- CLOSE TO SHOPS
- TWO DOUBLE BEDROOM VICTORIAN HOME
- POTENTIAL TO EXTEND
- PERIOD FEATURES THROUGHOUT
- RECENTLY REFRESHED



Living Room

11' 3" x 11' 3" (3.44m x 3.42m)

Dining Room

12' 7" x 11' 3" (3.84m x 3.44m)

Kitchen

11' 3" x 6' 11" (3.42m x 2.10m)

Bathroom

10' 1" x 6' 11" (3.07m x 2.10m)

Bedroom One

12' 5" x 11' 3" (3.78m x 3.44m)

Bedroom Two

11' 3" x 9' 6" (3.44m x 2.90m)

A splendid two bedroom Victorian terrace located on Westgrove, Woodford Green. A historic home with a modern twist, this is a property not to be missed.

Outside, this home delivers all the charm of a classic Victorian – stock bricks, bay, and sash windows – tick, tick tick! And once inside you won't be disappointed. A complete blank canvas that's move in ready, yet full of scope and opportunity to add your own stamp. With a traditional two up two down formation, plus some later additions, across the ground floor you'll find the front sitting room and dining room, along with the family bathroom and kitchen to the rear – with access to the rear garden. Upstairs, there's two double bedrooms both with period features, from original fireplaces to timeless sash windows.

Whether you're green fingered or a sun seeker, the garden offers a place for both. Perhaps a veggie patch or a BBQ and lounge set? Whichever you choose, this garden is a great spot to enjoy.





Ground Floor

Approx. 37.4 sq. metres (402.1 sq. feet)

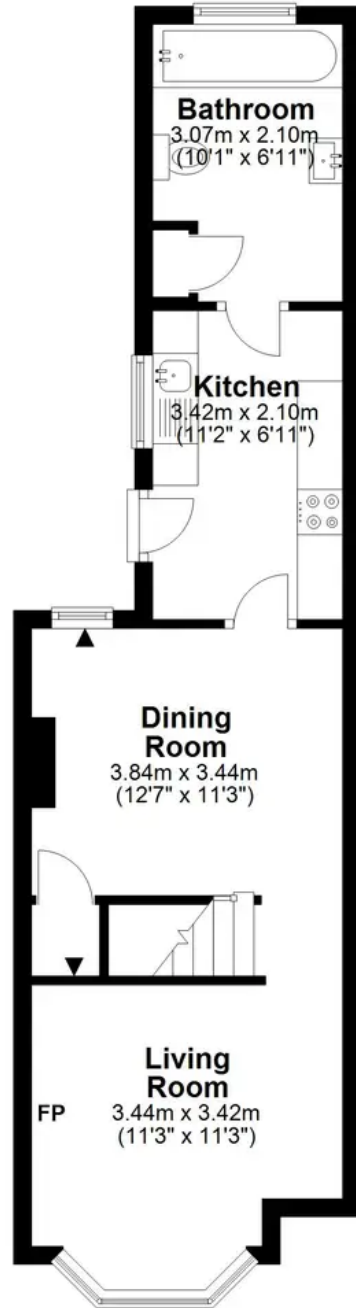

First Floor

Approx. 23.5 sq. metres (252.9 sq. feet)

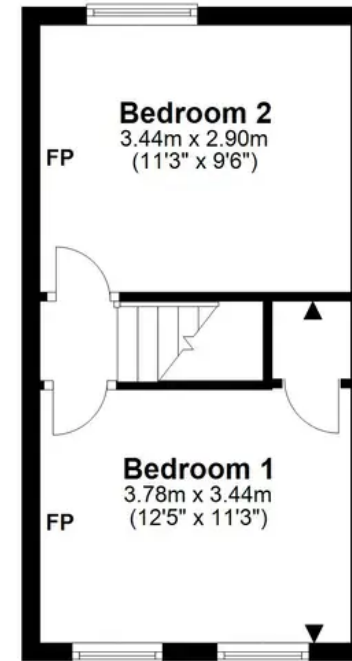

Total area: approx. 60.9 sq. metres (655.0 sq. feet)