



**Apt 5, 17 David Place, St. Helier, Jersey**  
**£399,000**

**BROADLANDS**  
FINDING YOU A HOME SINCE 1972

# Apartment 5, 17 David Place

St. Helier, Jersey

- Large apartment 840 sq. ft
- 1 designated parking space
- Well presented and light and airy throughout
- Conveniently located on the edge of Town
- Generous lounge/diner
- Sole agent
- Call Doug on 07700702585 or [doug@broadlandsjersey.com](mailto:doug@broadlandsjersey.com)





## Apartment 5, 17 David Place

St. Helier, Jersey

Great size second floor 2-bedroom apartment with parking. Situated moments from the centre of town. Ideal for a short walk to work and great location for taking advantage of all town has to offer. The apartment is well presented and light and airy throughout. It is a terrific size being 840 sq. ft. The property comprises of 2 double bedrooms, one with fitted wardrobes the other with built in storage. A very large lounge/diner with more additional storage, flowing into the kitchen. Which has a full range of integrated appliances and a breakfast bar. The bathroom is well appointed, and you have a attic. At the back of the property, it has a generous designated parking space. There is no onward chain and Broadlands are delighted to be sole agents.







### **Living**

Great size lounge/diner with built in storage. Kitchen with full range of integrated appliances and breakfast bar. Attic storage.

### **Sleeping**

Two double bedrooms, one with fitted wardrobes, one with built in storage. Bathroom with three piece suite and shower over the bath.

### **Services**

All main services. Service charges £152 pcm





SECOND FLOOR  
840 sq.ft. (78.1 sq.m.) approx.

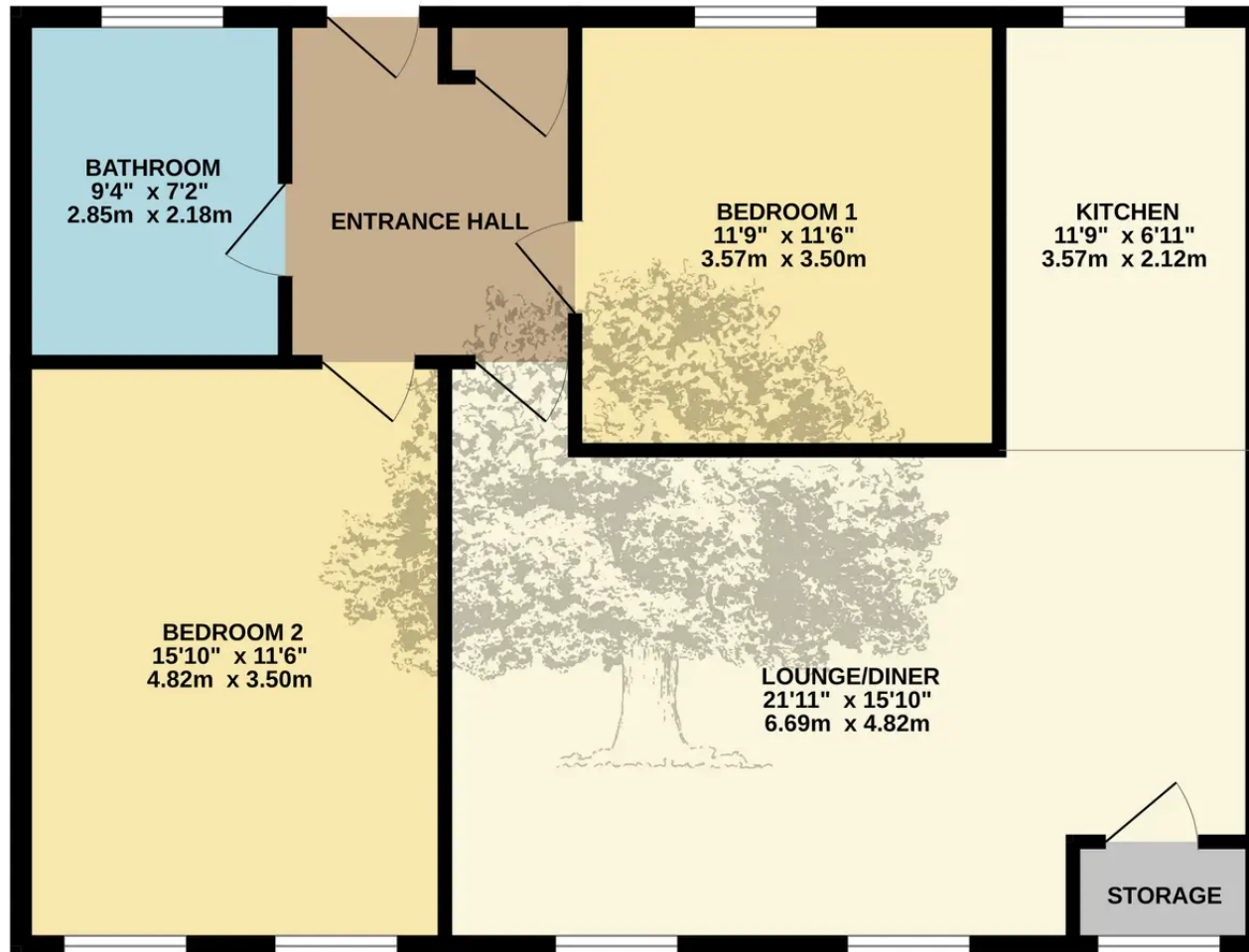

TOTAL FLOOR AREA : 840 sq.ft. (78.1 sq.m.) approx.

Whilst every attempt has been made to ensure the accuracy of the floorplan contained here, measurements of doors, windows, rooms and any other items are approximate and no responsibility is taken for any error, omission or mis-statement. This plan is for illustrative purposes only and should be used as such by any prospective purchaser. The services, systems and appliances shown have not been tested and no guarantee as to their operability or efficiency can be given.  
Made with Metropix ©2024



## Broadlands

Broadlands Estates, Library Place - JE2 3NL

01534 880770 • [enquiries@broadlandsjersey.com](mailto:enquiries@broadlandsjersey.com) • [www.broadlandsjersey.com/](http://www.broadlandsjersey.com/)

# BROADLANDS

FINDING YOU A HOME SINCE 1972