



Wigan

Rutter  
In Excess of £1,400 pcm  
Green



24-26 High Street, Wigan

\*\*\*Coming Soon\*\*\*

- Coming Soon
- Standish High Street
- Commercial Office Space To Let
- Sought After Location
- Two Floors
- Approximately 1318 Sq.Ft
- Current Rateable Value £8,800
- Two Entrances
- Viewings are Essential



## 24-26 High Street, Wigan

\*\*\*Coming Soon\*\*\*

- Coming Soon
- Standish High Street
- Commercial Office Space To Let
- Sought After Location
- Two Floors
- Approximately 1318 Sq.Ft
- Current Rateable Value £8,800
- Two Entrances
- Viewings are Essential





Floor 0

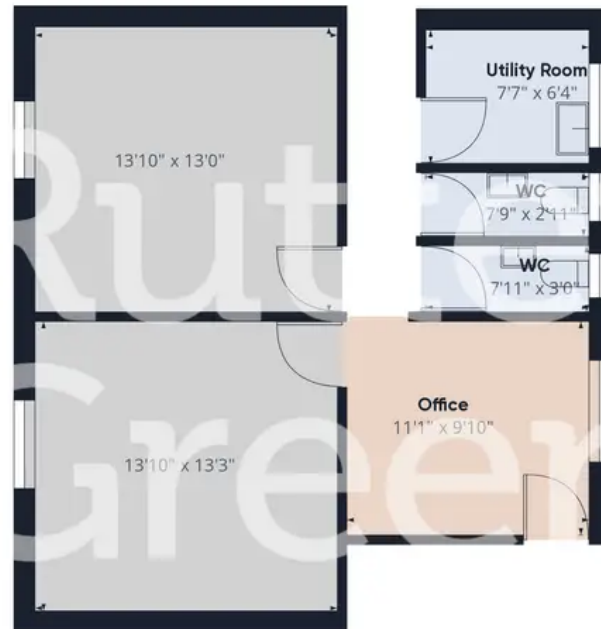

Floor 1

Approximate total area<sup>(1)</sup>  
1318.5 ft<sup>2</sup>

Reduced headroom  
13.34 ft<sup>2</sup>

(1) Excluding balconies and terraces

Reduced headroom  
(below 1.5m/4.92ft)

While every attempt has been made to ensure accuracy, all measurements are approximate, not to scale. This floor plan is for illustrative purposes only.

GIRAFFE360



## Rutter Green

Rutter Green Ltd, 104-108 Wallgate - WN3 4AB

01942 367915 • [hello@ruttergreen.co.uk](mailto:hello@ruttergreen.co.uk) • [www.ruttergreen.co.uk/](http://www.ruttergreen.co.uk/)