

24 Painter Wood, Billington

£210,000 Freehold

**** BEAUTIFUL TWO BEDROOM STONEBUILT DOUBLE FRONTED COTTAGE WITH NO ONWARD CHAIN IN A ELEVATED POSITION WITH LOVELY VIEWS & PRIVATE REAR GARDEN ADJOINING FIELDS **** An attractive property with generous lounge and modern oak style breakfast kitchen positioned on the edge of Billington close by to the array of amenities of Whalley village.

Council Tax band: B

Tenure: Freehold

EPC Energy Efficiency Rating: E

EPC Environmental Impact Rating:



This attractive double fronted stonebuilt cottage is set in a much favoured elevated position on Painter Wood, a beautiful semi-rural setting with fantastic outlooks, surrounding adjoining open fields and across towards Kemple End. The property is just a short distance to the nearby village of Whalley which offers a whole host of amenities including shops, hair salons, library, pubs, restaurants and a primary school which are all within walking distance. This cottage sits on the edge of Billington and is being offered to market with no onward chain with viewing highly recommended and is perfect for anyone looking for a hassle free move. The property is situated over two floors and is tastefully presented throughout with attractive new decoration, new carpets, many character features with exposed stone walls and wood beams and lovely internal doors. There is a sizeable lounge with a superb stone fireplace and multi fuel stove and tiled flooring with an oak style fitted breakfast kitchen. The first floor landing has lovely outlooks and a feature exposed stone wall, an attractive modern three piece bathroom and two excellent bedrooms, both of which enjoy attractive elevated outlooks.

Externally there is a front tarmac driveway with private parking for 1 car, indian stone flagged front garden forecourt, side stone pathways and stone shared bin storage. To the rear are steps up to a charming elevated stone flagged patio garden with side lawned area with superb distant views which pleasantly adjoins open fields and is not overlooked with rear shared pathway. An internal inspection is highly recommended.

- Attractive Double Fronted Stonebuilt Cottage
- Generous Lounge With Wood Burning Stove
- Character Filled Accom. New Carpets & Decoration
- Superb Elevated Garden Adjoining Open Fields
- 2 Bedrooms & 3-pce Bathroom
- Private Driveway; No Chain; Freehold
- Excellent Oak Style Fitted Breakfast Kitchen
- Superb Village Position; Close To Amenities



Entrance

with solid wood external front door.

Lounge

15' 6" x 13' 8" (4.72m x 4.17m)

Tiled flooring, 2x uPVC double glazed windows with feature stone window sills to the front and rear elevations with outlooks over rear garden, feature wall insert housing cast iron multi fuel stove with stone hearth and wood beam over, exposed feature stone wall, recessed spotlighting, staircase leading to first floor, 2x panelled radiators, television point, rear stable style wood glazed door leading out to garden.

Breakfast Kitchen

15' 0" x 7' 3" (4.57m x 2.21m)

Attractive oak style fitted wall and base units with complementary laminate working surfaces, stainless steel single sink drainer unit with mixer tap, tiled splash back, plumbing for washing machine, stainless steel integrated electric oven with 4-ring gas hob, extractor fan over, recessed spotlighting, tiled flooring, 2x uPVC double glazed windows with stone window sills and outlooks over rear garden, panelled radiator, built-in storage cupboard also housing wall mounted combination gas central heating boiler.

Landing

Pitched ceiling with feature wood beams, wall light points, brand new fitted carpet, exposed feature stone wall, uPVC double glazed window with stone window sill with lovely outlooks over rear garden and open fields beyond.

Bedroom One

13' 8" max x 10' 5" min (4.17m x 3.17m) x 12' 1"

(3.68m) Excellent double bedroom with newly fitted carpet, 2x panelled radiators, television point, attractive pitched ceiling with feature wood beams, wall light points, built-in wardrobe, uPVC double glazed window with stone window sill with beautiful distant elevated views.

Bedroom Two

9' 2" x 7' 3" (2.79m x 2.21m) Brand new fitted carpet, wall light points, uPVC double glazed window and stone window sill with elevated distant views, feature pitched ceiling and wood ceiling beams, panelled radiator.

Bathroom

Attractive 3-pce white suite comprising double ended bath with tiled surround with mixer tap and shower tap fitment, also housing thermostatic shower over bath with glazed screen, pedestal wash basin with mixer tap, low level w.c., panelled radiator, feature pitched ceiling with recessed spotlighting, part tiled walls and tiled flooring, feature exposed stone wall, uPVC double glazed window with stone window sill, lovely elevated garden views, tongue and groove wood style door.



GROUND FLOOR

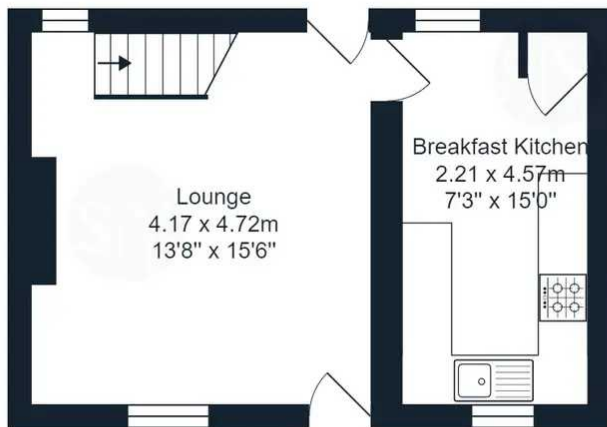

FIRST FLOOR

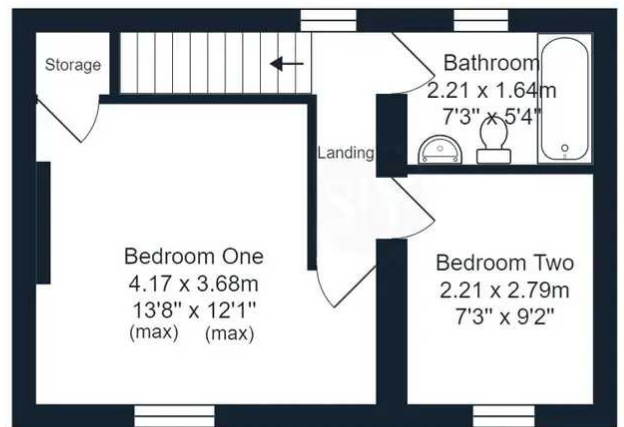

Painter Wood, Billington

Total Area: 63.6 m² ... 685 ft²

All measurements are approximate and for display purposes only.

