

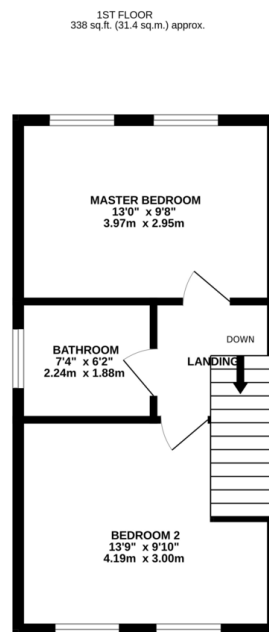

FOR SALE

2 Bed End Terraced House in London Road, Oadby, LE2 5AU
£230,000

*** No Chain *** Well presented and very well proportion modern end terrace house for sale within a stones throw of Oadby town centre. The property would suit a first time buyer, landlord or young family. The accommodation comprises entrance hall, kitchen diner, downstairs w.c., lounge, two double bedrooms, family bathroom, rear garden and allocated parking space. Call to book a viewing.

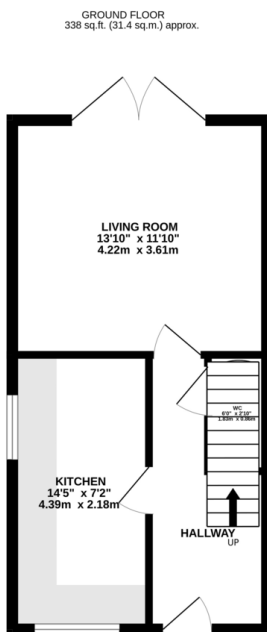

PHILLIPS GEORGE LTD
TOTAL FLOOR AREA: 677 sq.ft. (62.9 sq.m.) approx.
Whilst every attempt has been made to ensure the accuracy of the floorplan contained here, measurements of doors, windows, rooms and any other items are approximate and no responsibility is taken for any error, omission or misstatement. This plan is for illustrative purposes only and should be used as such for any prospective purchase. The services, systems and appliances shown have not been tested and no guarantee as to their operability or efficiency can be given.
Made with Metropix ©2024

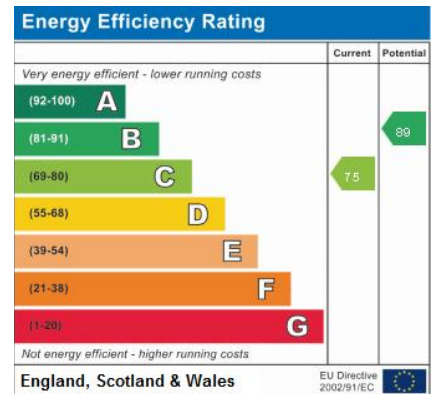

- No Chain
- End Terrace
- Modern
- Two Double Bedrooms
- Convenient Location
- Allocated Parking
- Ideal First Time Buy
- Downstairs W.C.

Agents Note: Whilst every care has been taken to prepare these sales particulars, they are for guidance purposes only. All measurements are approximate and for general guidance purposes only and whilst every care has been taken to ensure their accuracy, they should not be relied upon and potential buyers are advised to recheck the measurements.

