



8 Linkside, Shoppenhangers Road, Maidenhead, Berkshire SL6 2QD

**8 LINKSIDE, SHOPPENHANGERS
ROAD, MAIDENHEAD
BERKSHIRE SL6 2QD**

**GUIDE PRICE: £465,000
SHARE OF FREEHOLD**

A stunning two bedroom first floor apartment forming part of this small select gated development which is located within easy reach of the town centre and within approx. 0.6 miles of the mainline railway station (Paddington/Elizabeth Line). The property features a generous living room, kitchen/breakfast room, main bedroom suite with dressing area and en-suite shower room, guest double bedroom and a family bathroom. An internal inspection is most strongly recommended.

*GATED DEVELOPMENT *SECURITY ENTRYPHONE SYSTEM *COMMUNAL ENTRANCE HALL WITH LIFT & STAIRCASE RISING TO THE FIRST FLOOR *PRIVATE ENTRANCE HALL *LIVING ROOM *KITCHEN/BREAKFAST ROOM *MAIN BEDROOM WITH EN-SUITE DRESSING AREA & SHOWER ROOM *GUEST DOUBLE BEDROOM *FAMILY BATHROOM *HIGH LEVEL OF FINISH & SPECIFICATION *ALLOCATED PARKING & VISITOR PARKING *COMMUNAL GROUNDS *SHARE OF FREEHOLD *EPC RATING B *COUNCIL TAX BAND F

Service charge:

Length of lease remaining:







This plan is for layout guidance only. Not drawn to scale unless stated. Windows and door openings are approximate. Whilst every care is taken in the preparation of this plan, please check all dimensions, shapes and compass bearings before making any decisions reliant upon them.
 © CJ Property Marketing Ltd Produced for Braxton

For clarification we wish to inform prospective purchasers that we have prepared these sales particulars as a general guide. We have not carried out a detailed survey nor tested the services, appliances and specific fittings. Room sizes should not be relied upon for carpets, furnishings and appliances. Whilst these particulars are believed to be correct their accuracy is not guaranteed and are given without responsibility. They do not form part of any contract.

First Floor

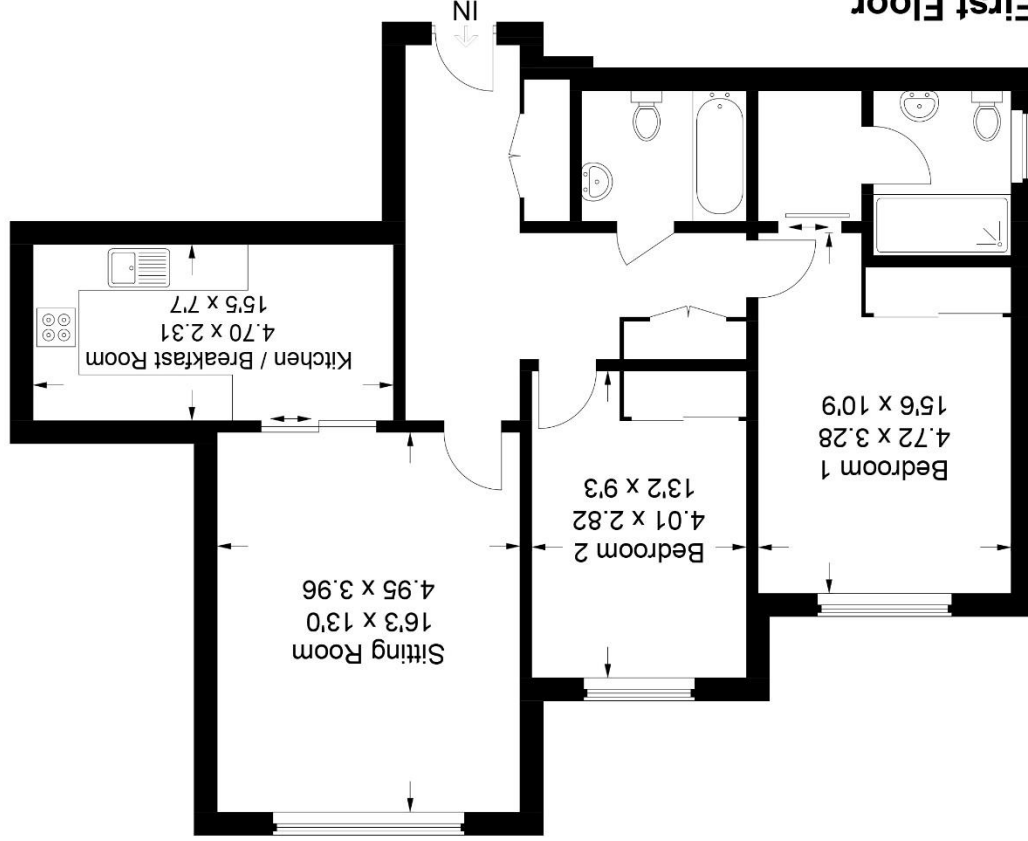

Approximate Gross Internal Area
84 sq m / 904 sq ft

